

TRAFFIC CRASH REPORT

*DENOTES MANDATORY FIELD FOR SUPPLEMENT REPORT

LOCAL REPORT NUMBER*

L L P 2 0 0 1 3 1 0 0 5 2 8

PHOTOS TAKEN
 SECONDARY CRASH

OH-2
 OH-3
 OH-1P
 OTHER
 PRIVATE PROPERTY

LOCAL INFORMATION

REPORTING AGENCY NAME*
CLEARCREEK TWP PD

NCIC*
0 8 3 1 6

HIT/SKIP
1 - SOLVED
2 - UNSOLVED

NUMBER OF UNITS
0 1

UNIT IN ERROR
98 - ANIMAL
99 - UNKNOWN

COUNTY*
8 3

LOCALITY*
1 - CITY
2 - VILLAGE
3 - TOWNSHIP
3

LOCATION: CITY, VILLAGE, TOWNSHIP*
CLEARCREEK

CRASH DATE / TIME*
0 13 12 0 2 0 1 3 4 8

CRASH SEVERITY
1 - FATAL
2 - SERIOUS INJURY SUSPECTED
3 - MINOR INJURY SUSPECTED
4 - INJURY POSSIBLE
5 - PROPERTY DAMAGE ONLY

ROUTE TYPE
1 - NORTH
2 - SOUTH
3 - EAST
4 - WEST

ROUTE NUMBER
PREFIX

LOCATION ROAD NAME
RED LION - FIVE POINTS

ROAD TYPE
R D

LATITUDE DECIMAL DEGREES
3 9 . 5 2 9 0 8 7

ROUTE TYPE
1 - NORTH
2 - SOUTH
3 - EAST
4 - WEST

ROUTE NUMBER
PREFIX

REFERENCE ROAD NAME (ROAD, MILEPOST, HOUSE #)
5911

ROAD TYPE

LONGITUDE DECIMAL DEGREES
8 4 . 2 2 8 6 1 6

REFERENCE POINT
1 - INTERSECTION
2 - MILE POST
3 - HOUSE #
3

DIRECTION FROM REFERENCE
1 - NORTH
2 - SOUTH
3 - EAST
4 - WEST

ROUTE TYPE
IR - INTERSTATE ROUTE(TP)
US - FEDERAL US ROUTE
SR - STATE ROUTE
CR - NUMBERED COUNTY ROUTE
TR - NUMBERED TOWNSHIP ROUTE

ROAD TYPE
AL - ALLEY
AV - AVENUE
BL - BOULEVARD
CR - CIRCLE
CT - COURT
DR - DRIVE
HE - HEIGHTS
HW - HIGHWAY
LA - LANE
MP - MILEPOST
OV - OVAL
PK - PARKWAY
PI - PIKE
PL - PLACE
RD - ROAD
SQ - SQUARE
ST - STREET
TE - TERRACE
TL - TRAIL
WA - WAY

INTERSECTION RELATED
 WITHIN INTERSECTION OR ON APPROACH
 WITHIN INTERCHANGE AREA

NUMBER OF APPROACHES

DISTANCE FROM REFERENCE
UNIT OF MEASURE
1 - MILES
2 - FEET
3 - YARDS

ROUTE TYPE
1 - NORTH
2 - SOUTH
3 - EAST
4 - WEST

DISTANCE UNIT OF MEASURE
1 - MILES
2 - FEET
3 - YARDS

ROADWAY
 ROADWAY DIVIDED

LOCATION OF FIRST HARMFUL EVENT
1 - ON ROADWAY
2 - ON SHOULDER
3 - IN MEDIAN
4 - ON ROADSIDE
5 - ON GORE
6 - OUTSIDE TRAFFIC WAY
7 - ON RAMP
8 - OFF RAMP
0 4

9 - CROSSOVER
10 - DRIVEWAY/ALLEY ACCESS
11 - RAILWAY GRADE CROSSING
12 - SHARED USE PATHS OR TRAILS
13 - BIKE LANE
14 - TOLL BOOTH
99 - OTHER / UNKNOWN

MANNER OF CRASH COLLISION/IMPACT
1 - NOT COLLISION BETWEEN TWO MOTOR VEHICLES IN TRANSPORT
2 - REAR-END
3 - HEAD-ON
4 - REAR-TO-REAR
5 - BACKING
6 - ANGLE
7 - SIDESWIPE, SAME DIRECTION
8 - SIDESWIPE, OPPOSITE DIRECTION
9 - OTHER / UNKNOWN
1

DIRECTION OF TRAVEL
1 - NORTH
2 - SOUTH
3 - EAST
4 - WEST

MEDIAN TYPE
1 - DIVIDED FLUSH MEDIAN (<4 FEET)
2 - DIVIDED FLUSH MEDIAN (≥4 FEET)
3 - DIVIDED, DEPRESSED MEDIAN
4 - DIVIDED, RAISED MEDIAN (ANY TYPE)
9 - OTHER/UNKNOWN

WORK ZONE RELATED
 WORKERS PRESENT
 LAW ENFORCEMENT PRESENT
 ACTIVE SCHOOL ZONE

WORK ZONE TYPE
1 - LANE CLOSURE
2 - LANE SHIFT/CROSSOVER
3 - WORK ON SHOULDER OR MEDIAN
4 - INTERMITTENT OR MOVING WORK
5 - OTHER

LOCATION OF CRASH IN WORK ZONE
1 - BEFORE THE 1ST WORK ZONE WARNING SIGN
2 - ADVANCE WARNING AREA
3 - TRANSITION AREA
4 - ACTIVITY AREA
5 - TERMINATION AREA

CONTOUR
1 - STRAIGHT LEVEL
2 - STRAIGHT GRADE
3 - CURVE LEVEL
4 - CURVE GRADE
9 - OTHER/UNKNOWN
3

CONDITIONS
1 - DRY
2 - WET
3 - SNOW
4 - ICE
5 - SAND, MUD, DIRT, OIL, GRAVEL
6 - WATER (STANDING, MOVING)
7 - SLUSH
9 - OTHER/UNKNOWN
2

SURFACE
1 - CONCRETE
2 - BLACKTOP, BITUMINOUS, ASPHALT
3 - BRICK/BLOCK
4 - SLAG, GRAVEL, STONE
5 - DIRT
9 - OTHER/UNKNOWN
2

LIGHT CONDITION
1 - DAYLIGHT
2 - DAWN/DUSK
3 - DARK - LIGHTED ROADWAY
4 - DARK - ROADWAY NOT LIGHTED
5 - DARK - UNKNOWN ROADWAY LIGHTING
9 - OTHER / UNKNOWN
1

WEATHER
1 - CLEAR
2 - CLOUDY
3 - FOG, SMOG, SMOKE
4 - RAIN
5 - SLEET, HAIL
6 - SNOW
7 - SEVERE CROSSWINDS
8 - BLOWING SAND, SOIL, DIRT, SNOW
9 - FREEZING RAIN OR FREEZING DRIZZLE
99 - OTHER / UNKNOWN
0 6

INDICATE THE NORTH DIRECTION WITH AN "N" ON THE COMPASS DIAGRAM.

NARRATIVE

UNIT 1 WAS TRAVELING NORTH ON RED LION - FIVE POINTS RD. UNIT 1 FAILED TO NEGOTIATE A CURVE IN THE ROADWAY AND NEAR HOUSE NUMBER 5911 WENT OFF THE LEFT SIDE OF THE ROADWAY. UNIT 1 STRUCK A FENCE, THE DITCH, THE FENCE AGAIN, AND UNDERBRUSH BEFORE COMING TO FINAL REST IN THE DITCH.

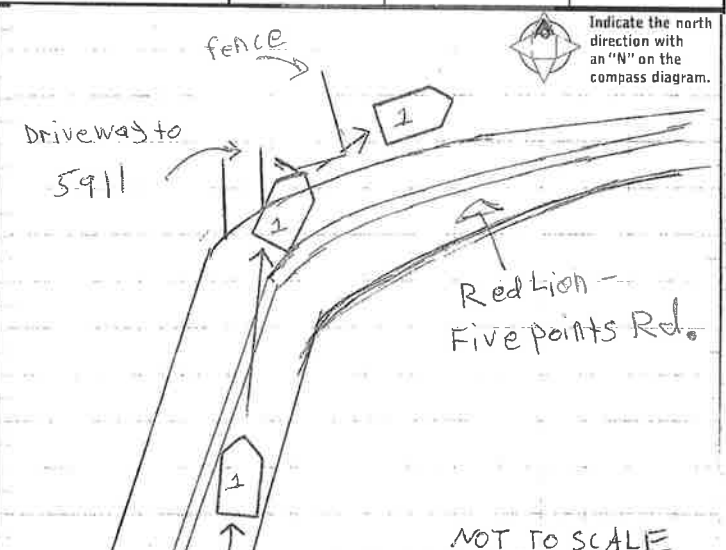

CRASH REPORTED DATE / TIME 0 13 12 0 2 0 1 3 4 8		DISPATCH DATE / TIME 0 13 12 0 2 0 1 3 4 9		ARRIVAL DATE / TIME 0 13 12 0 2 0 1 3 5 6		SCENE CLEARED DATE / TIME 0 13 12 0 2 0 1 6 0 2		REPORT TAKEN BY <input checked="" type="checkbox"/> POLICE AGENCY <input type="checkbox"/> MOTORIST <input type="checkbox"/> SUPPLEMENT (CORRECTION OR ADDITION TO AN EXISTING REPORT SENT TO ODPS)	
TOTAL TIME ROADWAY CLOSED 0 3 0	OTHER INVESTIGATION TIME 0 3 0	TOTAL MINUTES 1 6 3	OFFICER'S NAME* BRIAN MCWHORTER		CHECKED BY OFFICER'S NAME* Curtis O. Hensley		OFFICER'S BADGE NUMBER* 1 L 3 2		CHECKED BY OFFICER'S BADGE NUMBER* 1 4 1 2

OWNER	UNIT # 0 1	OWNER NAME: LAST, FIRST, MIDDLE (☐ SAME AS DRIVER) WALKER, TIMOTHY D	OWNER PHONE: INCLUDE AREA CODE (☐ SAME AS DRIVER) 9 3 7 2 8 6 1 0 5 6			
	OWNER ADDRESS: STREET, CITY, STATE, ZIP (☐ SAME AS DRIVER)					
COMMERCIAL CARRIER: NAME, ADDRESS, CITY, STATE, ZIP		COMMERCIAL CARRIER PHONE: INCLUDE AREA CODE				
VEHICLE	LP STATE OH	LICENSE PLATE # J979834	VEHICLE IDENTIFICATION # 1G2ZH361X74270278	VEHICLE YEAR 2007	VEHICLE MAKE PONTIAC	
	<input checked="" type="checkbox"/> INSURANCE VERIFIED	INSURANCE COMPANY PROGRESSIVE	INSURANCE POLICY # 930358620	COLOR WHITE	VEHICLE MODEL G6	
	<input type="checkbox"/> COMMERCIAL	TYPE OF USE <input type="checkbox"/> GOVERNMENT <input type="checkbox"/> IN EMERGENCY RESPONSE	US DOT #	TOWED BY: COMPANY NAME SANDY'S		
	<input type="checkbox"/> INTERLOCK DEVICE EQUIPPED	<input type="checkbox"/> HIT/SKIP UNIT	#OCCUPANTS 0 1	HAZARDOUS MATERIAL <input type="checkbox"/> MATERIAL RELEASED <input type="checkbox"/> PLACARD CLASS # PLACARD ID #		
	UNIT TYPE 0 1	1 - PASSENGER CAR 7 - MOTORCYCLE 2-WHEELED 12 - GOLF CART 18 - LIMO (LIVERY VEHICLE) 23 - PEDESTRIAN / SKATER 2 - PASSENGER VAN (MINIVAN) 8 - MOTORCYCLE 3-WHEELED 13 - SNOWMOBILE 19 - BUS (16+ PASSENGERS) 24 - WHEELCHAIR (ANY TYPE) 3 - SPORT UTILITY VEHICLE 9 - AUTOCYCLE 14 - SINGLE UNIT TRUCK 20 - OTHER VEHICLE 25 - OTHER NON-MOTORIST 4 - PICK UP 10 - MOPED OR MOTORIZED BICYCLE 15 - SEMI-TRACTOR 21 - HEAVY EQUIPMENT 26 - BICYCLE 5 - CARGO VAN 11 - ALL TERRAIN VEHICLE (ATV / UTV) 16 - FARM EQUIPMENT 22 - ANIMAL WITH RIDER OR ANIMAL-DRAWN VEHICLE 27 - TRAIN 6 - VAN (9-15 SEATS) 17 - MOTORHOME 99 - UNKNOWN OR HIT/SKIP				
	# OF TRAILING UNITS 0	WAS VEHICLE OPERATING IN AUTONOMOUS MODE WHEN CRASH OCCURRED? 1 - YES 2 - NO 9 - OTHER / UNKNOWN				
	SPECIAL FUNCTION 0 1	1 - NONE 6 - BUS - CHARTER/TOUR 11 - FIRE 16 - FARM 21 - MAIL CARRIER 2 - TAXI 7 - BUS - INTERCITY 12 - MILITARY 17 - MOWING 22 - GARBAGE/REFUSE 3 - ELECTRONIC RIDE SHARING 8 - BUS - SHUTTLE 13 - POLICE 18 - SNOW REMOVAL 23 - CONCRETE MIXER 4 - SCHOOL TRANSPORT 9 - BUS - OTHER 14 - PUBLIC UTILITY 19 - TOWING 24 - AUTO TRANSPORTER 5 - BUS - TRANSIT/COMMUTER 10 - AMBULANCE 15 - CONSTRUCTION EQUIPMENT 20 - SAFETY SERVICE PATROL 25 - OTHER / UNKNOWN				
	CARGO BODY TYPE 0 1	1 - NO CARGO BODY TYPE / NOT APPLICABLE 3 - VEHICLE TOWING ANOTHER MOTOR VEHICLE 5 - INTERMODAL CONTAINER CHASSIS 8 - POLE 12 - CONCRETE MIXER 2 - BUS 4 - LOGGING 6 - CARGO VAN/ENCLOSED BOX 9 - CARGO TANK 13 - AUTO TRANSPORTER 7 - GRAIN/CHIPS/GRAVEL 11 - DUMP 10 - FLAT BED 14 - GARBAGE/REFUSE 19 - OTHER / UNKNOWN				
	VEHICLE DEFECTS	1 - TURN SIGNALS 4 - BRAKES 7 - WORN OR SLICK TIRES 9 - MOTOR TROUBLE 99 - OTHER / UNKNOWN 2 - HEAD LAMPS 5 - STEERING 8 - TRAILER EQUIPMENT DEFECTIVE 10 - DISABLED FROM PRIOR ACCIDENT 3 - TAIL LAMPS 6 - TIRE BLOWOUT				
	NON-MOTORIST LOCATION AT IMPACT	1 - INTERSECTION - MARKED CROSSWALK 3 - INTERSECTION - OTHER 6 - BICYCLE LANE 9 - MEDIAN/CROSSING ISLAND 12 - FIRST RESPONDER AT INCIDENT SCENE 2 - INTERSECTION - UNMARKED CROSSWALK 4 - MIDLICK - MARKED CROSSWALK 7 - SHOULDER / ROADSIDE 10 - DRIVEWAY ACCESS 11 - SHARED USE PATHS OR TRAILS 19 - OTHER / UNKNOWN 5 - TRAVEL LANE - OTHER LOCATION 8 - SIDEWALK				
EVENT(S)	ACTION 3	1 - NON-CONTACT 1 - STRAIGHT AHEAD 7 - MAKING U-TURN 13 - NEGOTIATING A CURVE 18 - APPROACHING OR LEAVING VEHICLE 2 - NON-COLLISION 2 - BACKING 8 - ENTERING TRAFFIC LANE 14 - ENTERING OR CROSSING SPECIFIED LOCATION 19 - STANDING 3 - STRIKING 3 - CHANGING LANES 9 - LEAVING TRAFFIC LANE 15 - WALKING, RUNNING, JOGGING, PLAYING 20 - OTHER NON-MOTORIST 4 - STRUCK PRE-CRASH ACTIONS 10 - PARKED 16 - WORKING 21 - STANDING OUTSIDE DISABLED VEHICLE 5 - BOTH STRIKING & STRUCK 5 - MAKING RIGHT TURN 11 - SLOWING OR STOPPED IN TRAFFIC 17 - PUSHING VEHICLE 99 - OTHER / UNKNOWN 9 - OTHER / UNKNOWN 6 - MAKING LEFT TURN 12 - DRIVERLESS				
	CONTRIBUTING CIRCUMSTANCES 1 1	1 - NONE 7 - LEFT OF CENTER 13 - IMPROPER START FROM A PARKED POSITION 17 - VISION OBSTRUCTION 21 - LYING IN ROADWAY 2 - FAILURE TO YIELD 8 - FOLLOWING TOO CLOSE / ACDA 14 - STOPPED OR PARKED ILLEGALLY 18 - OPERATING DEFECTIVE EQUIPMENT 22 - NOT DISCERNIBLE 3 - RAN RED LIGHT 9 - IMPROPER LANE CHANGE 15 - SWERVING TO AVOID 19 - LOAD SHIFTING/FALLING/SPILLING 23 - OPENING DOOR INTO ROADWAY 4 - RAN STOP SIGN 10 - IMPROPER PASSING 16 - WRONG WAY 20 - IMPROPER CROSSING 99 - OTHER IMPROPER ACTION 5 - UNSAFE SPEED 11 - DROVE OFF ROAD 12 - IMPROPER BACKING				
	SEQUENCE OF EVENTS	1 - OVERTURN/ROLLOVER 6 - EQUIPMENT FAILURE NON-COLLISION 16 - RAILWAY VEHICLE 22 - WORK ZONE MAINTENANCE EQUIPMENT 2 - FIRE/EXPLOSION 7 - SEPARATION OF UNITS 11 - CROSS CENTERLINE - OPPOSITE DIRECTION OF TRAVEL 17 - ANIMAL - FARM 23 - STRUCK BY FALLING, SHIFTING CARGO OR ANYTHING SET IN MOTION BY A MOTOR VEHICLE 3 - IMMERSION 8 - RAN OFF ROAD RIGHT 12 - DOWNHILL RUNAWAY 18 - ANIMAL - DEER 24 - OTHER MOVABLE OBJECT 4 - JACKKNIFE 9 - RAN OFF ROAD LEFT 13 - OTHER NON-COLLISION 19 - ANIMAL - OTHER 20 - MOTOR VEHICLE IN TRANSPORT 5 - CARGO / EQUIPMENT LOSS OR SHIFT 10 - CROSS MEDIAN 14 - PEDESTRIAN 21 - PARKED MOTOR VEHICLE 6 - IMPROPER TURN 12 - IMPROPER BACKING 15 - PEDALCYCLE				
	COLLISION WITH FIXED OBJECT - STRUCK 25 - IMPACT ATTENUATOR / CRASH CUSHION 31 - GUARDRAIL END 37 - TRAFFIC SIGN POST 43 - CURB 50 - WORK ZONE MAINTENANCE EQUIPMENT 26 - BRIDGE OVERHEAD STRUCTURE 32 - PORTABLE BARRIER 38 - OVERHEAD SIGN POST 44 - DITCH 51 - WALL 27 - BRIDGE PIER OR ABUTMENT 33 - MEDIAN CABLE BARRIER 39 - LIGHT / LUMINARIES SUPPORT 45 - EMBANKMENT 52 - BUILDING 28 - BRIDGE PARAPET 34 - MEDIAN GUARDRAIL BARRIER 40 - UTILITY POLE 46 - FENCE 53 - TUNNEL 29 - BRIDGE RAIL 35 - MEDIAN CONCRETE BARRIER 41 - OTHER POST, POLE OR SUPPORT 47 - MAILBOX 54 - OTHER FIXED OBJECT 30 - GUARDRAIL FACE 36 - MEDIAN OTHER BARRIER 42 - CULVERT 48 - TREE 99 - OTHER / UNKNOWN 49 - FIRE HYDRANT					
	FIRST HARMFUL EVENT 2	MOST HARMFUL EVENT 3				

DAMAGE

DAMAGE SCALE

4 1 - NONE 3 - FUNCTIONAL DAMAGE
 2 - MINOR DAMAGE 4 - DISABLING DAMAGE
 9 - UNKNOWN

DAMAGED AREA(S)
 INDICATE ALL THAT APPLY

NO DAMAGE [0] UNDERCARRIAGE [14]
 TOP [13] ALL AREAS [15]
 UNIT NOT AT SCENE [16]

INITIAL POINT OF CONTACT

0 - NO DAMAGE 14 - UNDERCARRIAGE
 1-12 - REFER TO UNIT DIAGRAM 15 - VEHICLE NOT AT SCENE
 99 - UNKNOWN
 13 - TOP

TRAFFIC

TRAFFICWAY FLOW 1 - ONE-WAY 2 - TWO-WAY	TRAFFIC CONTROL 1 - ROUNDABOUT 4 - STOP SIGN 2 - SIGNAL 5 - YIELD SIGN 3 - FLASHER 6 - NO CONTROL
# OF THROUGH LANES ON ROAD 2	RAIL GRADE CROSSING 1 - NOT INVOLVED 2 - INVOLVED-ACTIVE CROSSING 3 - INVOLVED-PASSIVE CROSSING
UNIT / NON-MOTORIST DIRECTION FROM 8 TO 5 1 - NORTH 5 - NORTHEAST 2 - SOUTH 6 - NORTHWEST 3 - EAST 7 - SOUTHEAST 4 - WEST 8 - SOUTHWEST 9 - OTHER / UNKNOWN	
UNIT SPEED 0 5 5	DETECTED SPEED 1 1 - STATED / ESTIMATED SPEED 2 - CALCULATED / EDR 3 - UNDETERMINED
POSTED SPEED 4 5	



MOTORIST / Non-MOTORIST

LOCAL REPORT NUMBER
 L P 2 0 0 1 3 1 0 0 0 5 2 8

UNIT # 0 1	NAME: LAST, FIRST, MIDDLE WALKER, TIMOTHY, DAVID, II	DATE OF BIRTH 1 1 / 2 9 / 2 0 0 2	AGE 1 7	GENDER M
----------------------	--	---	-------------------	--------------------

ADDRESS: STREET, CITY, STATE, ZIP 65 GLASS CT., SPRINGBORO, OH, 45066	CONTACT PHONE - INCLUDE AREA CODE 9 3 7 7 6 0 5 4 4 1
---	---

INJURIES 4	INJURED TAKEN BY	EMS AGENCY (NAME)	INJURED TAKEN TO: MEDICAL FACILITY (NAME, CITY)	SAFETY EQUIPMENT USED 0 4	<input type="checkbox"/> DOT-COMPLIANT MC HELMET	SEATING POSITION 0 1	AIR BAG USAGE 2	EJECTION 1	TRAPPED 1
----------------------	-------------------------	--------------------------	--	-------------------------------------	--	--------------------------------	---------------------------	----------------------	---------------------

OL STATE O, H	OPERATOR LICENSE NUMBER UY367152	OFFENSE CHARGED 4511.202	LOCAL CODE <input type="checkbox"/>	OFFENSE DESCRIPTION FAIL TO CONTROL	CITATION NUMBER 017878
-------------------------	--	------------------------------------	---	---	----------------------------------

OL CLASS 4	ENDORSEMENT SELECT UP TO 2	RESTRICTION SELECT UP TO 3	DRIVER DISTRACTED BY	ALCOHOL / DRUG SUSPECTED <input type="checkbox"/> ALCOHOL <input type="checkbox"/> MARIJUANA <input type="checkbox"/> OTHER DRUG	CONDITION 1	ALCOHOL TEST STATUS TYPE VALUE			DRUG TEST(S) STATUS TYPE RESULT SELECT UP TO 4		
----------------------	--------------------------------------	--------------------------------------	-----------------------------	---	-----------------------	--	--	--	--	--	--

UNIT #	NAME: LAST, FIRST, MIDDLE	DATE OF BIRTH	AGE	GENDER
---------------	----------------------------------	----------------------	------------	---------------

ADDRESS: STREET, CITY, STATE, ZIP	CONTACT PHONE - INCLUDE AREA CODE
--	--

INJURIES	INJURED TAKEN BY	EMS AGENCY (NAME)	INJURED TAKEN TO: MEDICAL FACILITY (NAME, CITY)	SAFETY EQUIPMENT USED	<input type="checkbox"/> DOT-COMPLIANT MC HELMET	SEATING POSITION	AIR BAG USAGE	EJECTION	TRAPPED
-----------------	-------------------------	--------------------------	--	------------------------------	--	-------------------------	----------------------	-----------------	----------------

OL STATE	OPERATOR LICENSE NUMBER	OFFENSE CHARGED	LOCAL CODE <input type="checkbox"/>	OFFENSE DESCRIPTION	CITATION NUMBER
-----------------	--------------------------------	------------------------	---	----------------------------	------------------------

OL CLASS	ENDORSEMENT SELECT UP TO 2	RESTRICTION SELECT UP TO 3	DRIVER DISTRACTED BY	ALCOHOL / DRUG SUSPECTED <input type="checkbox"/> ALCOHOL <input type="checkbox"/> MARIJUANA <input type="checkbox"/> OTHER DRUG	CONDITION	ALCOHOL TEST STATUS TYPE VALUE			DRUG TEST(S) STATUS TYPE RESULT SELECT UP TO 4		
-----------------	--------------------------------------	--------------------------------------	-----------------------------	---	------------------	--	--	--	--	--	--

UNIT #	NAME: LAST, FIRST, MIDDLE	DATE OF BIRTH	AGE	GENDER
---------------	----------------------------------	----------------------	------------	---------------

ADDRESS: STREET, CITY, STATE, ZIP	CONTACT PHONE - INCLUDE AREA CODE
--	--

INJURIES	INJURED TAKEN BY	EMS AGENCY (NAME)	INJURED TAKEN TO: MEDICAL FACILITY (NAME, CITY)	SAFETY EQUIPMENT USED	<input type="checkbox"/> DOT-COMPLIANT MC HELMET	SEATING POSITION	AIR BAG USAGE	EJECTION	TRAPPED
-----------------	-------------------------	--------------------------	--	------------------------------	--	-------------------------	----------------------	-----------------	----------------

OL STATE	OPERATOR LICENSE NUMBER	OFFENSE CHARGED	LOCAL CODE <input type="checkbox"/>	OFFENSE DESCRIPTION	CITATION NUMBER
-----------------	--------------------------------	------------------------	---	----------------------------	------------------------

OL CLASS	ENDORSEMENT SELECT UP TO 2	RESTRICTION SELECT UP TO 3	DRIVER DISTRACTED BY	ALCOHOL / DRUG SUSPECTED <input type="checkbox"/> ALCOHOL <input type="checkbox"/> MARIJUANA <input type="checkbox"/> OTHER DRUG	CONDITION	ALCOHOL TEST STATUS TYPE VALUE			DRUG TEST(S) STATUS TYPE RESULT SELECT UP TO 4		
-----------------	--------------------------------------	--------------------------------------	-----------------------------	---	------------------	--	--	--	--	--	--

INJURIES	SEATING POSITION	AIR BAG	OL CLASS	OL RESTRICTION(S)	DRIVER DISTRACTION	TEST STATUS
1 - FATAL	1 - FRONT - LEFT SIDE (MOTORCYCLE DRIVER)	1 - NOT DEPLOYED	1 - CLASS A	1 - ALCOHOL INTERLOCK DEVICE	1 - NOT DISTRACTED	1 - NONE GIVEN
2 - SUSPECTED SERIOUS INJURY	2 - FRONT - MIDDLE	2 - DEPLOYED FRONT	2 - CLASS B	2 - CDL INTRASTATE ONLY	2 - MANUALLY OPERATING AN ELECTRONIC COMMUNICATION DEVICE (TEXTING, TYPING, DIALING)	2 - TEST REFUSED
3 - SUSPECTED MINOR INJURY	3 - FRONT - RIGHT SIDE	3 - DEPLOYED SIDE	3 - CLASS C	3 - CORRECTIVE LENSES	3 - TALKING ON HANDS-FREE COMMUNICATION DEVICE	3 - TEST GIVEN, CONTAMINATED SAMPLE / UNUSABLE
4 - POSSIBLE INJURY	4 - SECOND - LEFT SIDE (MOTORCYCLE PASSENGER)	4 - DEPLOYED BOTH FRONT / SIDE	4 - REGULAR CLASS (OHIO = D)	4 - FARM WAIVER	4 - TALKING ON HAND-HELD COMMUNICATION DEVICE	4 - TEST GIVEN, RESULTS KNOWN
5 - NO APPARENT INJURY	5 - SECOND - MIDDLE	5 - NOT APPLICABLE	5 - M/C MOPED ONLY	5 - EXCEPT CLASS A BUS	5 - OTHER ACTIVITY WITH AN ELECTRONIC DEVICE	5 - TEST GIVEN, RESULTS UNKNOWN
	6 - SECOND - RIGHT SIDE	9 - DEPLOYMENT UNKNOWN	6 - NO VALID DL	6 - EXCEPT CLASS A & CLASS B BUS	6 - PASSENGER	
INJURED TAKEN BY	7 - THIRD - LEFT SIDE (MOTORCYCLE SIDE CAR)	EJECTION	OL ENDORSEMENT	7 - EXCEPT TRACTOR-TRAILER	7 - OTHER DISTRACTION INSIDE THE VEHICLE	ALCOHOL TEST TYPE
1 - NOT TRANSPORTED / TREATED AT SCENE	8 - THIRD - MIDDLE	1 - NOT EJECTED	H - HAZMAT	8 - INTERMEDIATE LICENSE RESTRICTIONS	8 - OTHER DISTRACTION OUTSIDE THE VEHICLE	1 - NONE
2 - EMS	9 - THIRD - RIGHT SIDE	2 - PARTIALLY EJECTED	M - MOTORCYCLE	9 - LEARNER'S PERMIT RESTRICTIONS	9 - OTHER / UNKNOWN	2 - BLOOD
3 - POLICE	10 - SLEEPER SECTION OF TRUCK CAB	3 - TOTALLY EJECTED	P - PASSENGER	10 - LIMITED TO DAYLIGHT ONLY	CONDITION	3 - URINE
9 - OTHER / UNKNOWN	11 - PASSENGER IN OTHER ENCLOSED CARGO AREA (NON-TRAILING UNIT, BUS, PICK-UP WITH CAP)	4 - NOT APPLICABLE	N - TANKER	11 - LIMITED TO EMPLOYMENT	1 - APPARENTLY NORMAL	4 - BREATH
SAFETY EQUIPMENT	12 - PASSENGER IN UNENCLOSED CARGO AREA	TRAPPED	Q - MOTOR SCOOTER	12 - LIMITED - OTHER	2 - PHYSICAL IMPAIRMENT	5 - OTHER
1 - NONE USED	13 - TRAILING UNIT	1 - NOT TRAPPED	R - THREE-WHEEL MOTORCYCLE	13 - MECHANICAL DEVICES (SPECIAL BRAKES, HAND CONTROLS, OR OTHER ADAPTIVE DEVICES)	3 - EMOTIONAL (E.G., DEPRESSED, ANGRY, DISTURBED)	DRUG TEST TYPE
2 - SHOULDER BELT ONLY USED	14 - RIDING ON VEHICLE EXTERIOR (NON-TRAILING UNIT)	2 - EXTRICATED BY MECHANICAL MEANS	S - SCHOOL BUS	14 - MILITARY VEHICLES ONLY	4 - ILLNESS	1 - NONE
3 - LAP BELT ONLY USED	15 - NON-MOTORIST	3 - FREED BY NON-MECHANICAL MEANS	T - DOUBLE & TRIPLE TRAILERS	15 - MOTOR VEHICLES WITHOUT AIR BRAKES	5 - FELL ASLEEP, FAINTED, FATIGUED, ETC.	2 - BLOOD
4 - SHOULDER & LAP BELT USED	99 - OTHER / UNKNOWN		X - TANKER / HAZMAT	16 - OUTSIDE MIRROR	6 - UNDER THE INFLUENCE OF MEDICATIONS / DRUGS / ALCOHOL	3 - URINE
5 - CHILD RESTRAINT SYSTEM - FORWARD FACING				17 - PROSTHETIC AID	9 - OTHER / UNKNOWN	4 - OTHER
6 - CHILD RESTRAINT SYSTEM - REAR FACING				18 - OTHER		DRUG TEST RESULT(S)
7 - BOOSTER SEAT						1 - AMPHETAMINES
8 - HELMET USED						2 - BARBITURATES
9 - PROTECTIVE PADS USED (ELBOW, KNEES, ETC.)						3 - BENZODIAZEPINES
10 - REFLECTIVE CLOTHING						4 - CANNABINOIDS
11 - LIGHTING - PEDESTRIAN / BICYCLE ONLY						5 - COCAINE
99 - OTHER / UNKNOWN						6 - OPIATES / OPIOIDS
						7 - OTHER
						8 - NEGATIVE RESULTS

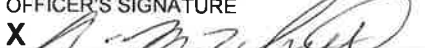

LOCAL REPORT NUMBER LP200131000528	REPORTING AGENCY CLEARCREEK TWP PD	DATE OF CRASH M 01 D 31 Y 2020
IN COUNTY OF WARREN	CRASH LOCATION 5911 RED LION - FIVE POINTS RD.	
OWNER OF FENCE THAT WAS DAMAGED: DALE ADKINS 937-554-9100		
OFFICER'S SIGNATURE X 		BADGE NUMBER 1232