

**TRAFFIC CRASH REPORT**

\*DENOTES MANDATORY FIELD FOR SUPPLEMENT REPORT

LOCAL REPORT NUMBER\*

L P 1 9 0 2 0 9 0 0 0 6 8 7

PHOTOS TAKEN  
 SECONDARY CRASH

OH-2  
 OH-3  
 OH-1P  
 OTHER  
 PRIVATE PROPERTY

LOCAL INFORMATION  
REPORTING AGENCY NAME\*  
Clearcreek Township PD

NCIC\*  
0 8 3 1 6

HIT/SKIP  
1 - SOLVED  
2 - UNSOLVED

NUMBER OF UNITS  
0 1

UNIT IN ERROR  
98 - ANIMAL  
99 - UNKNOWN

COUNTY\*  
8 3

LOCALITY\*  
3

LOCATION: CITY, VILLAGE, TOWNSHIP\*  
Clearcreek Township

CRASH DATE / TIME\*  
0 2 0 9 2 0 1 9 2 1 3 6

CRASH SEVERITY  
4

1 - FATAL  
2 - SERIOUS INJURY SUSPECTED  
3 - MINOR INJURY SUSPECTED  
4 - INJURY POSSIBLE  
5 - PROPERTY DAMAGE ONLY

ROUTE TYPE  
S R

ROUTE NUMBER  
7 4 1

PREFIX  
1 - NORTH  
2 - SOUTH  
3 - EAST  
4 - WEST

LOCATION ROAD NAME  
Oakland Hills

ROAD TYPE  
C T

LATITUDE DECIMAL DEGREES  
3 9 . 5 1 3 5 4 8

LONGITUDE DECIMAL DEGREES  
- 8 4 . 2 3 7 1 4 0

INTERSECTION RELATED  
 WITHIN INTERSECTION OR ON APPROACH  
 WITHIN INTERCHANGE AREA

NUMBER OF APPROACHES

ROUTE TYPE  
S R

ROUTE NUMBER  
7 4 1

PREFIX  
1 - NORTH  
2 - SOUTH  
3 - EAST  
4 - WEST

REFERENCE ROAD NAME (ROAD, MILEPOST, HOUSE #)  
Oakland Hills

ROAD TYPE  
C T

ROADWAY  
 ROADWAY DIVIDED

REFERENCE POINT  
1 - INTERSECTION  
2 - MILE POST  
3 - HOUSE #

DIRECTION FROM REFERENCE  
1 - NORTH  
2 - SOUTH  
3 - EAST  
4 - WEST

ROUTE TYPE  
IR - INTERSTATE ROUTE(TP)  
US - FEDERAL US ROUTE  
SR - STATE ROUTE  
CR - NUMBERED COUNTY ROUTE  
TR - NUMBERED TOWNSHIP ROUTE

ROAD TYPE  
AL - ALLEY  
AV - AVENUE  
BL - BOULEVARD  
CR - CIRCLE  
CT - COURT  
DR - DRIVE  
HE - HEIGHTS  
HW - HIGHWAY  
LA - LANE  
MP - MILEPOST  
OV - OVAL  
PK - PARKWAY  
PI - PIKE  
PL - PLACE  
RD - ROAD  
SQ - SQUARE  
ST - STREET  
TE - TERRACE  
TL - TRAIL  
WA - WAY

DISTANCE FROM REFERENCE  
1 0

DISTANCE UNIT OF MEASURE  
2 3 - YARDS

LOCATION OF FIRST HARMFUL EVENT  
0 4

1 - ON ROADWAY  
2 - ON SHOULDER  
3 - IN MEDIAN  
4 - ON ROADSIDE  
5 - ON GORE  
6 - OUTSIDE TRAFFIC WAY  
7 - ON RAMP  
8 - OFF RAMP

9 - CROSSOVER  
10 - DRIVEWAY/ALLEY ACCESS  
11 - RAILWAY GRADE CROSSING  
12 - SHARED USE PATHS OR TRAILS  
13 - BIKE LANE  
14 - TOLL BOOTH  
99 - OTHER / UNKNOWN

MANNER OF CRASH COLLISION/IMPACT  
1 - NOT COLLISION BETWEEN TWO MOTOR VEHICLES IN TRANSPORT  
2 - REAR-END  
3 - HEAD-ON  
4 - REAR-TO-REAR  
5 - BACKING  
6 - ANGLE  
7 - SIDESWIPE, SAME DIRECTION  
8 - SIDESWIPE, OPPOSITE DIRECTION  
9 - OTHER / UNKNOWN

DIRECTION OF TRAVEL  
1 - NORTH  
2 - SOUTH  
3 - EAST  
4 - WEST

MEDIAN TYPE  
1 - DIVIDED FLUSH MEDIAN (<4 FEET)  
2 - DIVIDED FLUSH MEDIAN (≥4 FEET)  
3 - DIVIDED, DEPRESSED MEDIAN  
4 - DIVIDED, RAISED MEDIAN (ANY TYPE)  
9 - OTHER/UNKNOWN

WORK ZONE RELATED  
 WORKERS PRESENT  
 LAW ENFORCEMENT PRESENT  
 ACTIVE SCHOOL ZONE

WORK ZONE TYPE  
1 - LANE CLOSURE  
2 - LANE SHIFT/CROSSOVER  
3 - WORK ON SHOULDER OR MEDIAN  
4 - INTERMITTENT OR MOVING WORK  
5 - OTHER

LOCATION OF CRASH IN WORK ZONE  
1 - BEFORE THE 1ST WORK ZONE WARNING SIGN  
2 - ADVANCE WARNING AREA  
3 - TRANSITION AREA  
4 - ACTIVITY AREA  
5 - TERMINATION AREA

CONTOUR  
2

CONDITIONS  
1

SURFACE  
2

LIGHT CONDITION  
3

1 - DAYLIGHT  
2 - DAWN/DUSK  
3 - DARK - LIGHTED ROADWAY  
4 - DARK - ROADWAY NOT LIGHTED  
5 - DARK - UNKNOWN ROADWAY LIGHTING  
9 - OTHER / UNKNOWN

WEATHER  
0 1

1 - CLEAR  
2 - CLOUDY  
3 - FOG, SMOG, SMOKE  
4 - RAIN  
5 - SLEET, HAIL  
6 - SNOW  
7 - SEVERE CROSSWINDS  
8 - BLOWING SAND, SOIL, DIRT, SNOW  
9 - FREEZING RAIN OR FREEZING DRIZZLE  
99 - OTHER / UNKNOWN

1 - DRY  
2 - WET  
3 - SNOW  
4 - ICE  
5 - SAND, MUD, DIRT, OIL, GRAVEL  
6 - WATER (STANDING, MOVING)  
7 - SLUSH  
9 - OTHER/UNKNOWN

1 - CONCRETE  
2 - BLACKTOP, BITUMINOUS, ASPHALT  
3 - BRICK/BLOCK  
4 - SLAG, GRAVEL, STONE  
5 - DIRT  
9 - OTHER/UNKNOWN

NARRATIVE

Unit 1 was traveling south on SR 741 when at Oakland Hills Ct. Unit 1 went off the left side of the roadway. Unit 1 struck a cable utility box and a fence. Unit 1 came to final rest against a large fence support post.

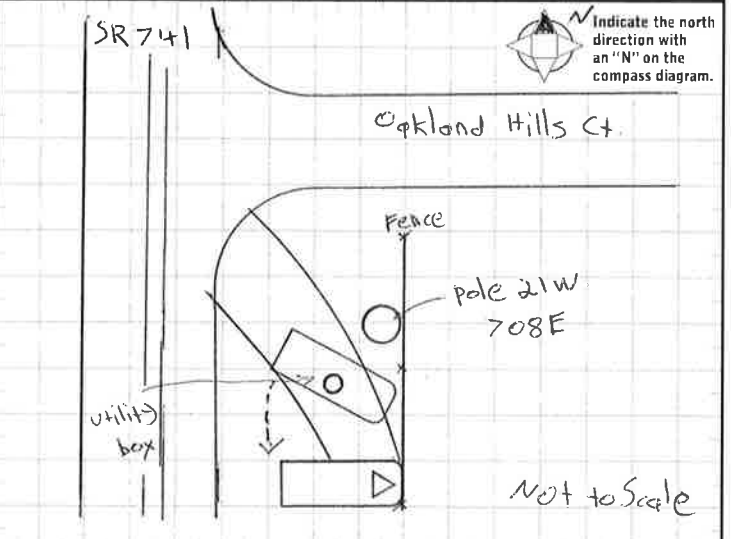

CRASH REPORTED DATE / TIME  
0 2 0 9 2 0 1 9 2 1 3 6

DISPATCH DATE / TIME  
0 2 0 9 2 0 1 9 2 1 3 6

ARRIVAL DATE / TIME  
0 2 0 9 2 0 1 9 2 1 4 4

SCENE CLEARED DATE / TIME  
0 2 0 9 2 0 1 9 2 2 4 0

REPORT TAKEN BY  
 POLICE AGENCY  
 MOTORIST  
 SUPPLEMENT (CORRECTION OR ADDITION TO AN EXISTING REPORT SENT TO O935)

TOTAL TIME ROADWAY CLOSED  
3 0

OTHER INVESTIGATION TIME  
1 2 0

TOTAL MINUTES  
1 8 4

OFFICER'S NAME\*  
Brian McWhorter

OFFICER'S BADGE NUMBER\*  
1 L 3 2

CHECKED BY OFFICER'S NAME\*  
Eric Ney

CHECKED BY OFFICER'S BADGE NUMBER\*  
1 L 2 5

**OWNER**

UNIT # 0 1 OWNER NAME: LAST, FIRST, MIDDLE (  SAME AS DRIVER )  
Colton, Caroline, E

OWNER ADDRESS: STREET, CITY, STATE, ZIP (  SAME AS DRIVER )  
50 Ironwood Dr, Dayton, OH, 45449

COMMERCIAL CARRIER: NAME, ADDRESS, CITY, STATE, ZIP  
 COMMERCIAL CARRIER PHONE: INCLUDE AREA CODE

**DAMAGE**

**DAMAGE SCALE**

3 1 - NONE 3 - FUNCTIONAL DAMAGE  
 2 - MINOR DAMAGE 4 - DISABLING DAMAGE  
 9 - UNKNOWN

**VEHICLE**

LP STATE O H LICENSE PLATE # HCL9402 VEHICLE IDENTIFICATION # S H H F K 7 H 9 3 H U 2 1 8 3 8 1 VEHICLE YEAR 2 0 1 7 VEHICLE MAKE Honda

INSURANCE VERIFIED INSURANCE COMPANY State Farm INSURANCE POLICY # 9587711E1135B COLOR Gray VEHICLE MODEL Civic

COMMERCIAL  GOVERNMENT  IN EMERGENCY RESPONSE US DOT # \_\_\_\_\_ TOWED BY: COMPANY NAME Fugates

INTERLOCK DEVICE EQUIPPED  HIT/SKIP UNIT #OCCUPANTS 0 1 VEHICLE WEIGHT GVWR/GCWR  
 1 - <10K LBS.  
 2 - 10,001 - 26K LBS.  
 3 - >26K LBS. HAZARDOUS MATERIAL  
 MATERIAL RELEASED CLASS # PLACARD ID #  
 PLACARD

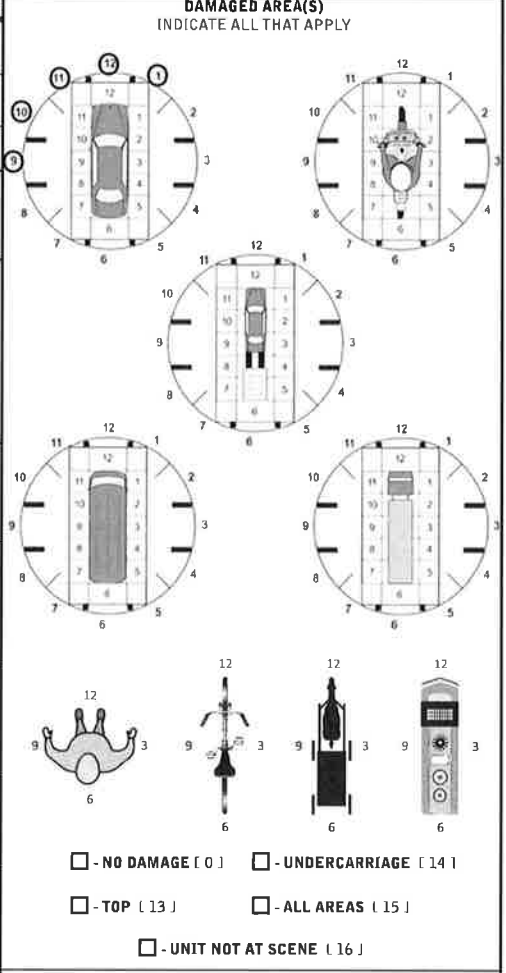

UNIT TYPE 0 1

1 - PASSENGER CAR 7 - MOTORCYCLE 2-WHEELED 12 - GOLF CART 18 - LIMO (LIVERY VEHICLE) 23 - PEDESTRIAN / SKATER  
 2 - PASSENGER VAN (MINIVAN) 8 - MOTORCYCLE 3-WHEELED 13 - SNOWMOBILE 19 - BUS (16+ PASSENGERS) 24 - WHEELCHAIR (ANY TYPE)  
 3 - SPORT UTILITY VEHICLE 9 - AUTOCYCLE 14 - SINGLE UNIT TRUCK 20 - OTHER VEHICLE 25 - OTHER NON-MOTORIST  
 4 - PICK UP 10 - MOPED OR MOTORIZED BICYCLE 15 - SEMI-TRACTOR 21 - HEAVY EQUIPMENT 26 - BICYCLE  
 5 - CARGO VAN 11 - ALL TERRAIN VEHICLE (ATV / UTV) 16 - FARM EQUIPMENT 22 - ANIMAL WITH RIDER OR ANIMAL-DRAWN VEHICLE 27 - TRAIN  
 6 - VAN (9-15 SEATS) 17 - MOTORHOME 99 - UNKNOWN OR HIT/SKIP

# OF TRAILING UNITS \_\_\_\_\_

WAS VEHICLE OPERATING IN AUTONOMOUS MODE WHEN CRASH OCCURRED? 0

1 - YES 2 - NO 9 - OTHER / UNKNOWN AUTONOMOUS MODE LEVEL  
 0 - NO AUTOMATION 1 - DRIVER ASSISTANCE 3 - CONDITIONAL AUTOMATION 9 - UNKNOWN  
 2 - PARTIAL AUTOMATION 4 - HIGH AUTOMATION 5 - FULL AUTOMATION

SPECIAL FUNCTION 0 1

1 - NONE 6 - BUS - CHARTER/TOUR 11 - FIRE 16 - FARM 21 - MAIL CARRIER  
 2 - TAXI 7 - BUS - INTERCITY 12 - MILITARY 17 - MOWING 99 - OTHER / UNKNOWN  
 3 - ELECTRONIC RIDE SHARING 8 - BUS - SHUTTLE 13 - POLICE 18 - SNOW REMOVAL  
 4 - SCHOOL TRANSPORT 9 - BUS - OTHER 14 - PUBLIC UTILITY 19 - TOWING  
 5 - BUS - TRANSIT/COMMUTER 10 - AMBULANCE 15 - CONSTRUCTION EQUIPMENT 20 - SAFETY SERVICE PATROL

CARGO BODY TYPE 0 1

1 - NO CARGO BODY TYPE / NOT APPLICABLE 3 - VEHICLE TOWING ANOTHER MOTOR VEHICLE 5 - INTERMODAL CONTAINER CHASSIS 8 - POLE 12 - CONCRETE MIXER  
 2 - BUS 4 - LOGGING 6 - CARGO VAN/ENCLOSED BOX 9 - CARGO TANK 13 - AUTOTRANSPORTER  
 7 - GRAIN/CHIPS/GRAVEL 10 - FLAT BED 14 - GARBAGE/REFUSE 99 - OTHER / UNKNOWN

VEHICLE DEFECTS 0 1

1 - TURN SIGNALS 4 - BRAKES 7 - WORN OR SLICK TIRES 9 - MOTOR TROUBLE 99 - OTHER / UNKNOWN  
 2 - HEAD LAMPS 5 - STEERING 8 - TRAILER EQUIPMENT DEFECTIVE 10 - DISABLED FROM PRIOR ACCIDENT  
 3 - TAIL LAMPS 6 - TIRE BLOWOUT

NON-MOTORIST LOCATION AT IMPACT 0 1

1 - INTERSECTION - MARKED CROSSWALK 3 - INTERSECTION - OTHER 6 - BICYCLE LANE 9 - MEDIAN/CROSSING ISLAND 12 - FIRST RESPONDER AT INCIDENT SCENE  
 2 - INTERSECTION - UNMARKED CROSSWALK 4 - MIDBLOCK - MARKED CROSSWALK 7 - SHOULDER / ROADSIDE 10 - DRIVEWAY ACCESS 99 - OTHER / UNKNOWN  
 5 - TRAVEL LANE - OTHER LOCATION 8 - SIDEWALK 11 - SHARED USE PATHS OR TRAILS

ACTION 0 1

1 - NON-CONTACT 1 - STRAIGHT AHEAD 7 - MAKING U-TURN 13 - NEGOTIATING A CURVE 18 - APPROACHING OR LEAVING VEHICLE  
 2 - NON-COLLISION 2 - BACKING 8 - ENTERING TRAFFIC LANE 14 - ENTERING OR CROSSING SPECIFIED LOCATION 19 - STANDING  
 3 - STRIKING 3 - CHANGING LANES 9 - LEAVING TRAFFIC LANE 15 - WALKING, RUNNING, JOGGING, PLAYING 20 - OTHER NON-MOTORIST  
 4 - STRUCK 4 - OVERTAKING/PASSING 10 - PARKED 16 - WORKING 21 - STANDING OUTSIDE DISABLED VEHICLE  
 5 - BOTH STRIKING & STRUCK 5 - MAKING RIGHT TURN 11 - SLOWING OR STOPPED IN TRAFFIC 17 - PUSHING VEHICLE 99 - OTHER / UNKNOWN  
 9 - OTHER / UNKNOWN 6 - MAKING LEFT TURN 12 - DRIVERLESS

**INITIAL POINT OF CONTACT**

0 - NO DAMAGE 14 - UNDERCARRIAGE  
 1-12 - REFER TO UNIT DIAGRAM 15 - VEHICLE NOT AT SCENE  
 13 - TOP 99 - UNKNOWN

CONTRIBUTING CIRCUMSTANCES 1 1

1 - NONE 7 - LEFT OF CENTER 13 - IMPROPER START FROM A PARKED POSITION 17 - VISION OBSTRUCTION 21 - LYING IN ROADWAY  
 2 - FAILURE TO YIELD 8 - FOLLOWING TOO CLOSE / ACDA 14 - STOPPED OR PARKED ILLEGALLY 18 - OPERATING DEFECTIVE EQUIPMENT 22 - NOT DISCERNIBLE  
 3 - RAN RED LIGHT 9 - IMPROPER LANE CHANGE 15 - SWERVING TO AVOID 19 - LOAD SHIFTING/FALLING/SPILLING 23 - OPENING DOOR INTO ROADWAY  
 4 - RAN STOP SIGN 10 - IMPROPER PASSING 16 - WRONG WAY 20 - IMPROPER CROSSING 99 - OTHER IMPROPER ACTION  
 5 - UNSAFE SPEED 11 - DROVE OFF ROAD  
 6 - IMPROPER TURN 12 - IMPROPER BACKING

**TRAFFIC**

TRAFFICWAY FLOW 2

1 - ONE-WAY  
 2 - TWO-WAY

TRAFFIC CONTROL 6

1 - ROUNDABOUT 4 - STOP SIGN  
 2 - SIGNAL 5 - YIELD SIGN  
 3 - FLASHER 6 - NO CONTROL

SEQUENCE OF EVENTS

1 1 1 1 - OVERTURN/ROLL OVER 6 - EQUIPMENT FAILURE 11 - CROSS CENTERLINE - OPPOSITE DIRECTION OF TRAVEL 16 - RAILWAY VEHICLE 22 - WORK ZONE MAINTENANCE EQUIPMENT  
 2 0 9 2 - FIRE/EXPLOSION 7 - SEPARATION OF UNITS 12 - DOWNHILL RUNAWAY 17 - ANIMAL - FARM 23 - STRUCK BY FALLING, SHIFTING CARGO OR ANYTHING SET IN MOTION BY A MOTOR VEHICLE  
 3 5 4 3 - IMMERSION 8 - RAN OFF ROAD RIGHT 13 - OTHER NON-COLLISION 18 - ANIMAL - DEER 24 - OTHER MOVABLE OBJECT  
 4 4 6 4 - JACKKNIFE 9 - RAN OFF ROAD LEFT 14 - PEDESTRIAN 19 - ANIMAL - OTHER 20 - MOTOR VEHICLE IN TRANSPORT  
 5 5 4 5 - CARGO / EQUIPMENT LOSS OR SHIFT 10 - CROSS MEDIAN 15 - PEDALCYCLE 21 - PARKED MOTOR VEHICLE

# OF THROUGH LANES ON ROAD 2

RAIL GRADE CROSSING 3

1 - NOT INVOLVED  
 2 - INVOLVED-ACTIVE CROSSING  
 3 - INVOLVED-PASSIVE CROSSING

**COLLISION WITH FIXED OBJECT - STRUCK**

25 - IMPACT ATTENUATOR / CRASH CUSHION 31 - GUARDRAIL END 37 - TRAFFIC SIGN POST 43 - CURB 50 - WORK ZONE MAINTENANCE EQUIPMENT  
 26 - BRIDGE OVERHEAD STRUCTURE 32 - PORTABLE BARRIER 38 - OVERHEAD SIGN POST 44 - DITCH 51 - WALL  
 27 - BRIDGE PIER OR ABUTMENT 33 - MEDIUM CABLE BARRIER 39 - LIGHT / LUMINARIES SUPPORT 45 - EMBANKMENT 52 - BUILDING  
 28 - BRIDGE PARAPET 34 - MEDIUM GUARDRAIL BARRIER 40 - UTILITY POLE 46 - FENCE 53 - TUNNEL  
 29 - BRIDGE RAIL 35 - MEDIUM CONCRETE BARRIER 41 - OTHER POST, POLE OR SUPPORT 47 - MAILBOX 54 - OTHER FIXED OBJECT  
 30 - GUARDRAIL FACE 36 - MEDIUM OTHER BARRIER 42 - CULVERT 48 - TREE 99 - OTHER / UNKNOWN  
 49 - FIRE HYDRANT

FIRST HARMFUL EVENT 3 MOST HARMFUL EVENT 4

**UNIT / NON-MOTORIST DIRECTION**

FROM 1 TO 2

1 - NORTH 5 - NORTHEAST  
 2 - SOUTH 6 - NORTHWEST  
 3 - EAST 7 - SOUTHEAST  
 4 - WEST 8 - SOUTHWEST  
 9 - OTHER / UNKNOWN

UNIT SPEED 0 5 5

POSTED SPEED 5 5

DETECTED SPEED 1

1 - STATED / ESTIMATED SPEED  
 2 - CALCULATED / EDR  
 3 - UNDETERMINED



# MOTORIST / Non-MOTORIST

LOCAL REPORT NUMBER  
L P 1 9 0 2 0 9 0 0 0 6 8 7

<b>UNIT #</b> 0 1	<b>NAME: LAST, FIRST, MIDDLE</b> Colton, Dean, E Jr.		<b>DATE OF BIRTH</b> 0 1 / 3 1 / 1 9 9 1		<b>AGE</b> 2 8	<b>GENDER</b> M				
<b>ADDRESS: STREET, CITY, STATE, ZIP</b> 485 Georgetown Rd. Apt D, Lebanon, OH, 45036				<b>CONTACT PHONE - INCLUDE AREA CODE</b> 9 3 7 4 2 2 1 8 3 0						
<b>INJURIES</b> 4	<b>INJURED TAKEN BY</b> 2	<b>EMS AGENCY (NAME)</b> Clearcreek Fire District	<b>INJURED TAKEN TO: MEDICAL FACILITY (NAME, CITY)</b> Atrium, Middletown	<b>SAFETY EQUIPMENT USED</b> 0 4	<input type="checkbox"/> DOT-COMPLIANT MC HELMET	<b>SEATING POSITION</b> 0 1	<b>AIR BAG USAGE</b> 1	<b>EJECTION</b> 1	<b>TRAPPED</b> 1	
<b>OL STATE</b> O H	<b>OPERATOR LICENSE NUMBER</b> TG000284		<b>OFFENSE CHARGED</b> 4511.202	<b>LOCAL CODE</b> <input type="checkbox"/>	<b>OFFENSE DESCRIPTION</b> Failure to control		<b>CITATION NUMBER</b> 017223			
<b>OL CLASS</b> 4	<b>ENDORSEMENT</b> SELECT UP TO 2	<b>RESTRICTION</b> SELECT UP TO 3	<b>DRIVER DISTRACTED BY</b> 1	<b>ALCOHOL / DRUG SUSPECTED</b> <input checked="" type="checkbox"/> ALCOHOL <input type="checkbox"/> MARIJUANA <input checked="" type="checkbox"/> OTHER DRUG		<b>CONDITION</b> 6	<b>ALCOHOL TEST</b> STATUS TYPE VALUE		<b>DRUG TEST(S)</b> STATUS TYPE RESULT SELECT UP TO 4	

<b>UNIT #</b>	<b>NAME: LAST, FIRST, MIDDLE</b>		<b>DATE OF BIRTH</b>		<b>AGE</b>	<b>GENDER</b>				
<b>ADDRESS: STREET, CITY, STATE, ZIP</b>				<b>CONTACT PHONE - INCLUDE AREA CODE</b>						
<b>INJURIES</b>	<b>INJURED TAKEN BY</b>	<b>EMS AGENCY (NAME)</b>	<b>INJURED TAKEN TO: MEDICAL FACILITY (NAME, CITY)</b>	<b>SAFETY EQUIPMENT USED</b>	<input type="checkbox"/> DOT-COMPLIANT MC HELMET	<b>SEATING POSITION</b>	<b>AIR BAG USAGE</b>	<b>EJECTION</b>	<b>TRAPPED</b>	
<b>OL STATE</b>	<b>OPERATOR LICENSE NUMBER</b>		<b>OFFENSE CHARGED</b>	<b>LOCAL CODE</b>	<b>OFFENSE DESCRIPTION</b>		<b>CITATION NUMBER</b>			
<b>OL CLASS</b>	<b>ENDORSEMENT</b> SELECT UP TO 2	<b>RESTRICTION</b> SELECT UP TO 3	<b>DRIVER DISTRACTED BY</b>	<b>ALCOHOL / DRUG SUSPECTED</b> <input type="checkbox"/> ALCOHOL <input type="checkbox"/> MARIJUANA <input type="checkbox"/> OTHER DRUG		<b>CONDITION</b>	<b>ALCOHOL TEST</b> STATUS TYPE VALUE		<b>DRUG TEST(S)</b> STATUS TYPE RESULT SELECT UP TO 4	

<b>UNIT #</b>	<b>NAME: LAST, FIRST, MIDDLE</b>		<b>DATE OF BIRTH</b>		<b>AGE</b>	<b>GENDER</b>				
<b>ADDRESS: STREET, CITY, STATE, ZIP</b>				<b>CONTACT PHONE - INCLUDE AREA CODE</b>						
<b>INJURIES</b>	<b>INJURED TAKEN BY</b>	<b>EMS AGENCY (NAME)</b>	<b>INJURED TAKEN TO: MEDICAL FACILITY (NAME, CITY)</b>	<b>SAFETY EQUIPMENT USED</b>	<input type="checkbox"/> DOT-COMPLIANT MC HELMET	<b>SEATING POSITION</b>	<b>AIR BAG USAGE</b>	<b>EJECTION</b>	<b>TRAPPED</b>	
<b>OL STATE</b>	<b>OPERATOR LICENSE NUMBER</b>		<b>OFFENSE CHARGED</b>	<b>LOCAL CODE</b>	<b>OFFENSE DESCRIPTION</b>		<b>CITATION NUMBER</b>			
<b>OL CLASS</b>	<b>ENDORSEMENT</b> SELECT UP TO 2	<b>RESTRICTION</b> SELECT UP TO 3	<b>DRIVER DISTRACTED BY</b>	<b>ALCOHOL / DRUG SUSPECTED</b> <input type="checkbox"/> ALCOHOL <input type="checkbox"/> MARIJUANA <input type="checkbox"/> OTHER DRUG		<b>CONDITION</b>	<b>ALCOHOL TEST</b> STATUS TYPE VALUE		<b>DRUG TEST(S)</b> STATUS TYPE RESULT SELECT UP TO 4	

INJURIES	SEATING POSITION	AIR BAG	OL CLASS	OL RESTRICTION(S)	DRIVER DISTRACTION	TEST STATUS
1- FATAL 2- SUSPECTED SERIOUS INJURY 3- SUSPECTED MINOR INJURY 4- POSSIBLE INJURY 5- NO APPARENT INJURY	1- FRONT - LEFT SIDE (MOTORCYCLE DRIVER) 2- FRONT - MIDDLE 3- FRONT - RIGHT SIDE 4- SECOND - LEFT SIDE (MOTORCYCLE PASSENGER) 5- SECOND - MIDDLE 6- SECOND - RIGHT SIDE 7- THIRD - LEFT SIDE (MOTORCYCLE SIDE CAR) 8- THIRD - MIDDLE 9- THIRD - RIGHT SIDE 10- SLEEPER SECTION OF TRUCK CAB 11- PASSENGER IN OTHER ENCLOSED CARGO AREA (NON-TRAILING UNIT, BUS, PICK-UP WITH CAP) 12- PASSENGER IN UNENCLOSED CARGO AREA 13- TRAILING UNIT 14- RIDING ON VEHICLE EXTERIOR (NON-TRAILING UNIT) 15- NON-MOTORIST 99- OTHER / UNKNOWN	1- NOT DEPLOYED 2- DEPLOYED FRONT 3- DEPLOYED SIDE 4- DEPLOYED BOTH FRONT / SIDE 5- NOT APPLICABLE 9- DEPLOYMENT UNKNOWN	1- CLASS A 2- CLASS B 3- CLASS C 4- REGULAR CLASS (OHIO = D) 5- M/C MOPED ONLY 6- NO VALID OL	1- ALCOHOL INTERLOCK DEVICE 2- CDL INTRASTATE ONLY 3- CORRECTIVE LENSES 4- FARM WAIVER 5- EXCEPT CLASS A BUS 6- EXCEPT CLASS A & CLASS B BUS 7- EXCEPT TRACTOR-TRAILER 8- INTERMEDIATE LICENSE RESTRICTIONS 9- LEARNER'S PERMIT RESTRICTIONS 10- LIMITED TO DAYLIGHT ONLY 11- LIMITED TO EMPLOYMENT 12- LIMITED - OTHER 13- MECHANICAL DEVICES (SPECIAL BRAKES, HAND CONTROLS, OR OTHER ADAPTIVE DEVICES) 14- MILITARY VEHICLES ONLY 15- MOTOR VEHICLES WITHOUT AIR BRAKES 16- OUTSIDE MIRROR 17- PROSTHETIC AID 18- OTHER	1- NOT DISTRACTED 2- MANUALLY OPERATING AN ELECTRONIC COMMUNICATION DEVICE (TEXTING, TYPING, DIALING) 3- TALKING ON HANDS-FREE COMMUNICATION DEVICE 4- TALKING ON HAND-HELD COMMUNICATION DEVICE 5- OTHER ACTIVITY WITH AN ELECTRONIC DEVICE 6- PASSENGER 7- OTHER DISTRACTION INSIDE THE VEHICLE 8- OTHER DISTRACTION OUTSIDE THE VEHICLE 9- OTHER / UNKNOWN	1- NONE GIVEN 2- TEST REFUSED 3- TEST GIVEN, CONTAMINATED SAMPLE / UNUSABLE 4- TEST GIVEN, RESULTS KNOWN 5- TEST GIVEN, RESULTS UNKNOWN
<b>INJURED TAKEN BY</b>		<b>EJECTION</b>	<b>OL ENDORSEMENT</b>		<b>CONDITION</b>	<b>ALCOHOL TEST TYPE</b>
1- NOT TRANSPORTED / TREATED AT SCENE 2- EMS 3- POLICE 9- OTHER / UNKNOWN		1- NOT EJECTED 2- PARTIALLY EJECTED 3- TOTALLY EJECTED 4- NOT APPLICABLE	H - HAZMAT M - MOTORCYCLE P - PASSENGER N - TANKER Q - MOTOR SCOOTER R - THREE-WHEEL MOTORCYCLE S - SCHOOL BUS T - DOUBLE & TRIPLE TRAILERS X - TANKER / HAZMAT		1- APPARENTLY NORMAL 2- PHYSICAL IMPAIRMENT 3- EMOTIONAL (E.G. DEPRESSED, ANGRY, DISTURBED) 4- ILLNESS 5- FELL ASLEEP, FAINTED, FATIGUED, ETC. 6- UNDER THE INFLUENCE OF MEDICATIONS / DRUGS / ALCOHOL 9- OTHER / UNKNOWN	1- NONE 2- BLOOD 3- URINE 4- BREATH 5- OTHER
<b>SAFETY EQUIPMENT</b>		<b>TRAPPED</b>				<b>DRUG TEST TYPE</b>
1- NONE USED 2- SHOULDER BELT ONLY USED 3- LAP BELT ONLY USED 4- SHOULDER & LAP BELT USED 5- CHILD RESTRAINT SYSTEM - FORWARD FACING 6- CHILD RESTRAINT SYSTEM - REAR FACING 7- BOOSTER SEAT 8- HELMET USED 9- PROTECTIVE PADS USED (ELBOW, KNEES, ETC.) 10- REFLECTIVE CLOTHING 11- LIGHTING - PEDESTRIAN / BICYCLE ONLY 99- OTHER / UNKNOWN		1- NOT TRAPPED 2- EXTRICATED BY MECHANICAL MEANS 3- FREED BY NON-MECHANICAL MEANS				1- NONE 2- BLOOD 3- URINE 4- OTHER
						<b>DRUG TEST RESULT(S)</b>
						1- AMPHETAMINES 2- BARBITURATES 3- BENZODIAZEPINES 4- CANNABINOIDS 5- COCAINE 6- OPIATES / OPIOIDS 7- OTHER 8- NEGATIVE RESULTS



LOCAL REPORT NUMBER LP190209000687	REPORTING AGENCY Clearcreek Township PD	DATE OF CRASH M 02   D 09   Y 2019
IN COUNTY OF Warren	CRASH LOCATION SR 741 & Oakland Hills Ct.	
<p>Buried utilities box # 4951 damaged.</p> <p>White fencing damaged, responsible party is: Bryan Howard 1732 Oakland Hills Ct. Springboro OH 45066 614-353-2470</p> <p>There was also fencing damaged to the south of the fence that Bryan Howard is <sup>not</sup> responsible for. At the time of this report it is unknown the responsible party for that fence.</p>		
OFFICER'S SIGNATURE 		BADGE NUMBER 1232