

PHOTOS TAKEN
 SECONDARY CRASH
 OH-2
 OH-3
 OH-1P
 OTHER
 PRIVATE PROPERTY

LOCAL INFORMATION
 REPORTING AGENCY NAME* CLEARCREEK TWP PD
 NCIC* 08316

L P 2 0 0 3 0 4 0 0 1 0 3 7
 HIT/SKIP
 1 - SOLVED
 2 - UNSOLVED
 NUMBER OF UNITS 0 1
 UNIT IN ERROR
 98 - ANIMAL
 99 - UNKNOWN

COUNTY* 8 3
 LOCALITY* 3
 LOCATION: CITY, VILLAGE, TOWNSHIP* CLEARCREEK

CRASH DATE / TIME* 03042020 1020
 CRASH SEVERITY 5
 1 - FATAL
 2 - SERIOUS INJURY SUSPECTED
 3 - MINOR INJURY SUSPECTED
 4 - INJURY POSSIBLE
 5 - PROPERTY DAMAGE ONLY

ROUTE TYPE LOCATION
 ROUTE NUMBER
 PREFIX 1 - NORTH
 2 - SOUTH
 3 - EAST
 4 - WEST
 LOCATION ROAD NAME UTICA
 ROAD TYPE R D

LATITUDE DECIMAL DEGREES 39.525219
 LONGITUDE DECIMAL DEGREES -84.158302

REFERENCE ROAD NAME (ROAD, MILEPOST, HOUSE #)
 6074
 ROAD TYPE

REFERENCE POINT
 1 - INTERSECTION
 2 - MILE POST
 3 - HOUSE #
 DIRECTION FROM REFERENCE
 1 - NORTH
 2 - SOUTH
 3 - EAST
 4 - WEST
 ROUTE TYPE
 IR - INTERSTATE ROUTE(TP)
 US - FEDERAL US ROUTE
 SR - STATE ROUTE
 CR - NUMBERED COUNTY ROUTE
 TR - NUMBERED TOWNSHIP ROUTE
 ROAD TYPE
 AL - ALLEY
 AV - AVENUE
 BL - BOULEVARD
 CR - CIRCLE
 CT - COURT
 DR - DRIVE
 HE - HEIGHTS
 HW - HIGHWAY
 LA - LANE
 MP - MILEPOST
 OV - OVAL
 PK - PARKWAY
 PI - PIKE
 PL - PLACE
 RD - ROAD
 SQ - SQUARE
 ST - STREET
 TE - TERRACE
 TL - TRAIL
 WA - WAY

INTERSECTION RELATED
 WITHIN INTERSECTION OR ON APPROACH
 WITHIN INTERCHANGE AREA
 NUMBER OF APPROACHES
 ROADWAY
 ROADWAY DIVIDED

LOCATION OF FIRST HARMFUL EVENT
 1 - ON ROADWAY
 2 - ON SHOULDER
 3 - IN MEDIAN
 4 - ON ROADSIDE
 5 - ON GORE
 6 - OUTSIDE TRAFFIC WAY
 7 - ON RAMP
 8 - OFF RAMP
 9 - CROSSOVER
 10 - DRIVEWAY/ALLEY ACCESS
 11 - RAILWAY GRADE CROSSING
 12 - SHARED USE PATHS OR TRAILS
 13 - BIKE LANE
 14 - TOLL BOOTH
 99 - OTHER / UNKNOWN

MANNER OF CRASH COLLISION/IMPACT
 1 - NOT COLLISION BETWEEN TWO MOTOR VEHICLES IN TRANSPORT
 2 - REAR-END
 3 - HEAD-ON
 4 - REAR-TO-REAR
 5 - BACKING
 6 - ANGLE
 7 - SIDESWIPE, SAME DIRECTION
 8 - SIDESWIPE, OPPOSITE DIRECTION
 9 - OTHER / UNKNOWN

DIRECTION OF TRAVEL
 1 - NORTH
 2 - SOUTH
 3 - EAST
 4 - WEST
 MEDIAN TYPE
 1 - DIVIDED FLUSH MEDIAN (<4 FEET)
 2 - DIVIDED FLUSH MEDIAN (>4 FEET)
 3 - DIVIDED, DEPRESSED MEDIAN
 4 - DIVIDED, RAISED MEDIAN (ANY TYPE)
 9 - OTHER/UNKNOWN

WORK ZONE RELATED
 WORKERS PRESENT
 LAW ENFORCEMENT PRESENT
 ACTIVE SCHOOL ZONE

WORK ZONE TYPE
 1 - LANE CLOSURE
 2 - LANE SHIFT/CROSSOVER
 3 - WORK ON SHOULDER OR MEDIAN
 4 - INTERMITTENT OR MOVING WORK
 5 - OTHER

LOCATION OF CRASH IN WORK ZONE
 1 - BEFORE THE 1ST WORK ZONE WARNING SIGN
 2 - ADVANCE WARNING AREA
 3 - TRANSITION AREA
 4 - ACTIVITY AREA
 5 - TERMINATION AREA

CONTOUR
 1 - STRAIGHT LEVEL
 2 - STRAIGHT GRADE
 3 - CURVE LEVEL
 4 - CURVE GRADE
 9 - OTHER/UNKNOWN

CONDITIONS
 1 - DRY
 2 - WET
 3 - SNOW
 4 - ICE
 5 - SAND, MUD, DIRT, OIL, GRAVEL
 6 - WATER (STANDING, MOVING)
 7 - SLUSH
 9 - OTHER/UNKNOWN

SURFACE
 1 - CONCRETE
 2 - BLACKTOP, BITUMINOUS, ASPHALT
 3 - BRICK/BLOCK
 4 - SLAG, GRAVEL, STONE
 5 - DIRT
 9 - OTHER/UNKNOWN

LIGHT CONDITION
 1 - DAYLIGHT
 2 - DAWN/DUSK
 3 - DARK - LIGHTED ROADWAY
 4 - DARK - ROADWAY NOT LIGHTED
 5 - DARK - UNKNOWN ROADWAY LIGHTING
 9 - OTHER / UNKNOWN

WEATHER
 1 - CLEAR
 2 - CLOUDY
 3 - FOG, SMOG, SMOKE
 4 - RAIN
 5 - SLEET, HAIL
 6 - SNOW
 7 - SEVERE CROSSWINDS
 8 - BLOWING SAND, SOIL, DIRT, SNOW
 9 - FREEZING RAIN OR FREEZING DRIZZLE
 99 - OTHER / UNKNOWN

NARRATIVE

UNIT # 1 WAS TRAVELING SOUTH ON UTICA ROAD WHEN THE DRIVER STATED HE SWERVED TO MISS A DEER, DROVE OFF THE RIGHT SIDE OF THE ROAD, STRUCK A MAILBOX, STRUCK A ROAD SIGN, STRUCK A GUARD RAIL, STRUCK A TREE, AND CAME TO REST ON A CULVERT.

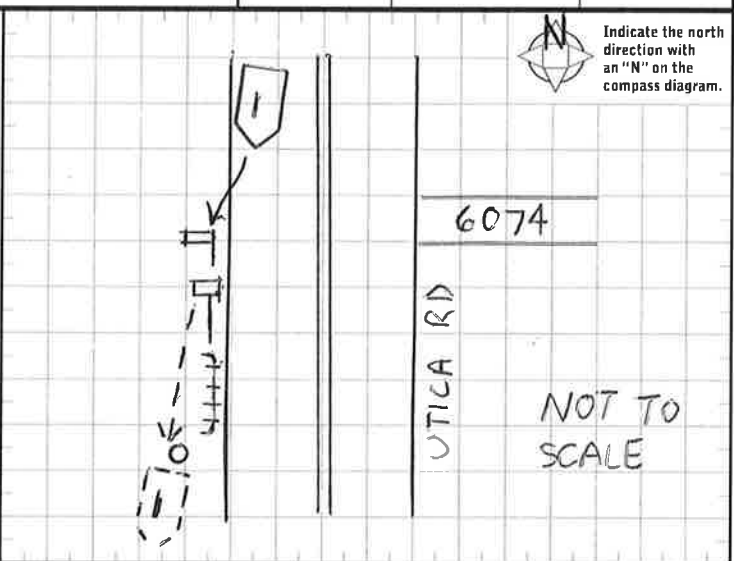

CRASH REPORTED DATE / TIME 03042020 1020
 DISPATCH DATE / TIME 03042020 1020
 ARRIVAL DATE / TIME 03042020 1026
 SCENE CLEARED DATE / TIME 03042020 1152
 TOTAL TIME ROADWAY CLOSED 062
 OTHER INVESTIGATION TIME 030
 TOTAL MINUTES 122
 OFFICER'S NAME* JOHN L GLEESON
 OFFICER'S BADGE NUMBER* 1 L 2 6
 CHECKED BY OFFICER'S NAME* ERIC NEY
 CHECKED BY OFFICER'S BADGE NUMBER* 1 L 2 5

REPORT TAKEN BY
 POLICE AGENCY
 MOTORIST
 SUPPLEMENT (CORRECTION OR ADDITION TO AN EXISTING REPORT SENT TO OOPS)

| | | | | | | | |
|---------------------------------|--|--|--|---|---|--|--|
| OWNER | UNIT # <u>01</u> | | OWNER NAME: LAST, FIRST, MIDDLE (☐ SAME AS DRIVER) | | OWNER PHONE: INCLUDE AREA CODE (☐ SAME AS DRIVER) | | |
| | OWNER ADDRESS: STREET, CITY, STATE, ZIP (☐ SAME AS DRIVER) | | | | | | |
| | COMMERCIAL CARRIER: NAME, ADDRESS, CITY, STATE, ZIP | | | COMMERCIAL CARRIER PHONE: INCLUDE AREA CODE | | | |
| VEHICLE | LP STATE <u>OH</u> | LICENSE PLATE # <u>FFA4110</u> | VEHICLE IDENTIFICATION # <u>1G8B6KZBK8AF118453</u> | | VEHICLE YEAR <u>2010</u> | VEHICLE MAKE <u>CHEV</u> | |
| | <input checked="" type="checkbox"/> INSURANCE VERIFIED | INSURANCE COMPANY <u>GRANGE INDEMNITY</u> | | INSURANCE POLICY # <u>4267011</u> | COLOR <u>WHITE</u> | VEHICLE MODEL <u>3500HD</u> | |
| | TYPE OF USE | | US DOT # | | TOWED BY: COMPANY NAME <u>SANDYS</u> | | |
| | <input type="checkbox"/> COMMERCIAL | <input type="checkbox"/> GOVERNMENT | <input type="checkbox"/> IN EMERGENCY RESPONSE | | | HAZARDOUS MATERIAL CLASS # <u>PLACARD ID #</u> | |
| | <input type="checkbox"/> INTERLOCK DEVICE EQUIPPED | <input type="checkbox"/> HIT/SKIP UNIT | #OCCUPANTS <u>01</u> | VEHICLE WEIGHT GVWR/GCWR | | | |
| | | | 1 - ≤10K LBS. | 2 - 10,001 - 26K LBS. | | 3 - >26K LBS. | |
| | UNIT TYPE <u>04</u> | | 1 - PASSENGER CAR 7 - MOTORCYCLE 2-WHEELED 12 - GOLF CART 18 - LIMO (LIVERY VEHICLE) 23 - PEDESTRIAN / SKATER 2 - PASSENGER VAN (MINIVAN) 8 - MOTORCYCLE 3-WHEELED 13 - SNOWMOBILE 19 - BUS (16+ PASSENGERS) 24 - WHEELCHAIR (ANY TYPE) 3 - SPORT UTILITY VEHICLE 9 - AUTOCYCLE 14 - SINGLE UNIT TRUCK 20 - OTHER VEHICLE 25 - OTHER NON-MOTORIST 4 - PICK UP 10 - MOPED OR MOTORIZED BICYCLE 15 - SEMI-TRACTOR 21 - HEAVY EQUIPMENT 26 - BICYCLE 5 - CARGO VAN 11 - ALL TERRAIN VEHICLE (ATV / UTV) 16 - FARM EQUIPMENT 22 - ANIMAL WITH RIDER OR ANIMAL-DRAWN VEHICLE 27 - TRAIN 6 - VAN (9-15 SEATS) | | | | |
| | # OF TRAILING UNITS | | WAS VEHICLE OPERATING IN AUTONOMOUS MODE WHEN CRASH OCCURRED? | | | | |
| | | | 1 - YES 2 - NO 9 - OTHER / UNKNOWN | | AUTONOMOUS MODE LEVEL | | |
| | | | 0 - NO AUTOMATION 1 - DRIVER ASSISTANCE 2 - PARTIAL AUTOMATION 3 - CONDITIONAL AUTOMATION 4 - HIGH AUTOMATION 5 - FULL AUTOMATION 9 - UNKNOWN | | | | |
| SPECIAL FUNCTION <u>01</u> | | 1 - NONE 6 - BUS - CHARTER/TOUR 11 - FIRE 16 - FARM 21 - MAIL CARRIER 2 - TAXI 7 - BUS - INTERCITY 12 - MILITARY 17 - MOWING 99 - OTHER / UNKNOWN 3 - ELECTRONIC RIDE SHARING 8 - BUS - SHUTTLE 13 - POLICE 18 - SNOW REMOVAL 4 - SCHOOL TRANSPORT 9 - BUS - OTHER 14 - PUBLIC UTILITY 19 - TOWING 5 - BUS - TRANSIT/COMMUTER 10 - AMBULANCE 15 - CONSTRUCTION EQUIPMENT 20 - SAFETY SERVICE PATROL | | | | | |
| CARGO BODY TYPE <u>01</u> | | 1 - NO CARGO BODY TYPE / NOT APPLICABLE 3 - VEHICLE TOWING ANOTHER MOTOR VEHICLE 5 - INTERMODAL CONTAINER CHASSIS 8 - POLE 12 - CONCRETE MIXER 2 - BUS 4 - LOGGING 6 - CARGO VAN/ENCLOSED BOX 9 - CARGO TANK 13 - AUTO TRANSPORTER 7 - GRAIN/CHIPS/GRAVEL 11 - DUMP 14 - GARBAGE/REFUSE 99 - OTHER / UNKNOWN | | | | | |
| VEHICLE DEFECTS | | 1 - TURN SIGNALS 4 - BRAKES 7 - WORN OR SLICK TIRES 9 - MOTOR TROUBLE 99 - OTHER / UNKNOWN 2 - HEAD LAMPS 5 - STEERING 8 - TRAILER EQUIPMENT DEFECTIVE 10 - DISABLED FROM PRIOR ACCIDENT 3 - TAIL LAMPS 6 - TIRE BLOWOUT | | | | | |
| NON-MOTORIST LOCATION AT IMPACT | | 1 - INTERSECTION - MARKED CROSSWALK 3 - INTERSECTION - OTHER 6 - BICYCLE LANE 9 - MEDIAN/CROSSING ISLAND 12 - FIRST RESPONDER AT INCIDENT SCENE 2 - INTERSECTION - UNMARKED CROSSWALK 4 - MIDBLOCK - MARKED CROSSWALK 7 - SHOULDER / ROADSIDE 10 - DRIVEWAY ACCESS 99 - OTHER / UNKNOWN 5 - TRAVEL LANE - OTHER LOCATION 8 - SIDEWALK 11 - SHARED USE PATHS OR TRAILS | | | | | |
| ACTION | | 1 - NON-CONTACT 1 - STRAIGHT AHEAD 7 - MAKING U-TURN 13 - NEGOTIATING A CURVE 18 - APPROACHING OR LEAVING VEHICLE 2 - NON-COLLISION 2 - BACKING 8 - ENTERING TRAFFIC LANE 14 - ENTERING OR CROSSING SPECIFIED LOCATION 19 - STANDING 3 - STRIKING 3 - CHANGING LANES 9 - LEAVING TRAFFIC LANE 15 - WALKING, RUNNING, JOGGING, PLAYING 20 - OTHER NON-MOTORIST 4 - STRUCK 4 - OVERTAKING/PASSING 10 - PARKED 16 - WORKING 21 - STANDING OUTSIDE DISABLED VEHICLE 5 - BOTH STRIKING & STRUCK 5 - MAKING RIGHT TURN 11 - SLOWING OR STOPPED IN TRAFFIC 17 - PUSHING VEHICLE 99 - OTHER / UNKNOWN 9 - OTHER / UNKNOWN 6 - MAKING LEFT TURN 12 - DRIVERLESS | | | | | |
| CONTRIBUTING CIRCUMSTANCES | | 1 - NONE 7 - LEFT OF CENTER 13 - IMPROPER START FROM A PARKED POSITION 17 - VISION OBSTRUCTION 21 - LYING IN ROADWAY 2 - FAILURE TO YIELD 8 - FOLLOWING TOO CLOSE / ACDA 14 - STOPPED OR PARKED ILLEGALLY 18 - OPERATING DEFECTIVE EQUIPMENT 22 - NOT DISCERNIBLE 3 - RAN RED LIGHT 9 - IMPROPER LANE CHANGE 15 - SWERVING TO AVOID 19 - LOAD SHIFTING/FALLING/SPILLING 23 - OPENING DOOR INTO ROADWAY 4 - RAN STOP SIGN 10 - IMPROPER PASSING 16 - WRONG WAY 20 - IMPROPER CROSSING 99 - OTHER IMPROPER ACTION 5 - UNSAFE SPEED 11 - DROVE OFF ROAD 12 - IMPROPER BACKING | | | | | |
| SEQUENCE OF EVENTS | | 1 - OVERTURN/ROLLOVER 6 - EQUIPMENT FAILURE 11 - CROSS CENTERLINE - OPPOSITE DIRECTION OF TRAVEL 16 - RAILWAY VEHICLE 22 - WORK ZONE MAINTENANCE EQUIPMENT 2 - FIRE/EXPLOSION 7 - SEPARATION OF UNITS 12 - DOWNHILL RUNAWAY 17 - ANIMAL - FARM 23 - STRUCK BY FALLING, SHIFTING CARGO OR ANYTHING SET IN MOTION BY A MOTOR VEHICLE 3 - IMMERSION 8 - RAN OFF ROAD RIGHT 13 - OTHER NON-COLLISION 18 - ANIMAL - DEER 24 - OTHER MOVABLE OBJECT 4 - JACKKNIFE 9 - RAN OFF ROAD LEFT 14 - PEDESTRIAN 19 - ANIMAL - OTHER 20 - MOTOR VEHICLE IN TRANSPORT 21 - PARKED MOTOR VEHICLE 5 - CARGO / EQUIPMENT LOSS OR SHIFT 10 - CROSS MEDIAN 15 - PEDAL CYCLE 43 - CURB 50 - WORK ZONE MAINTENANCE EQUIPMENT 25 - IMPACT ATTENUATOR / CRASH CUSHION 31 - GUARDRAIL END 37 - TRAFFIC SIGN POST 44 - DITCH 51 - WALL 26 - BRIDGE OVERHEAD STRUCTURE 32 - PORTABLE BARRIER 38 - OVERHEAD SIGN POST 45 - EMBANKMENT 52 - BUILDING 27 - BRIDGE PIER OR ABUTMENT 33 - MEDIAN CABLE BARRIER 39 - LIGHT / LUMINARIES SUPPORT 46 - FENCE 53 - TUNNEL 28 - BRIDGE PARAPET 34 - MEDIAN GUARDRAIL BARRIER 40 - UTILITY POLE 47 - MAILBOX 54 - OTHER FIXED OBJECT 29 - BRIDGE RAIL 35 - MEDIAN CONCRETE BARRIER 41 - OTHER POST, POLE OR SUPPORT 48 - TREE 99 - OTHER / UNKNOWN 30 - GUARDRAIL FACE 36 - MEDIAN OTHER BARRIER 42 - CULVERT 49 - FIRE HYDRANT | | | | | |
| FIRST HARMFUL EVENT <u>2</u> | | MOST HARMFUL EVENT <u>4</u> | | | | | |

| | |
|---|--|
| LOCAL REPORT NUMBER | |
| L P 2 0 0 3 0 4 0 0 1 0 3 7 | |
| DAMAGE | |
| DAMAGE SCALE | |
| 4 1 - NONE 3 - FUNCTIONAL DAMAGE 2 - MINOR DAMAGE 4 - DISABLING DAMAGE 9 - UNKNOWN | |
| DAMAGED AREA(S) INDICATE ALL THAT APPLY | |
| | |
| <input type="checkbox"/> - NO DAMAGE [0] <input checked="" type="checkbox"/> - UNDERCARRIAGE [14] <input type="checkbox"/> - TOP [13] <input type="checkbox"/> - ALL AREAS [15] <input type="checkbox"/> - UNIT NOT AT SCENE [16] | |
| INITIAL POINT OF CONTACT | |
| 0 - NO DAMAGE 14 - UNDERCARRIAGE 1-12 - REFER TO UNIT DIAGRAM 15 - VEHICLE NOT AT SCENE 13 - TOP 99 - UNKNOWN | |
| TRAFFIC | |
| TRAFFICWAY FLOW | TRAFFIC CONTROL |
| 1 - ONE-WAY 2 - TWO-WAY | 1 - ROUNDABOUT 4 - STOP SIGN 2 - SIGNAL 5 - YIELD SIGN 3 - FLASHER 6 - NO CONTROL |
| # OF THROUGH LANES ON ROAD | RAIL GRADE CROSSING |
| <u>2</u> | 1 - NOT INVOLVED 2 - INVOLVED-ACTIVE CROSSING 3 - INVOLVED-PASSIVE CROSSING |
| UNIT / NON-MOTORIST DIRECTION | |
| FROM <u>1</u> TO <u>2</u> 1 - NORTH 5 - NORTHEAST 2 - SOUTH 6 - NORTHWEST 3 - EAST 7 - SOUTHEAST 4 - WEST 8 - SOUTHWEST 9 - OTHER / UNKNOWN | |
| UNIT SPEED | DETECTED SPEED |
| <u>050</u> | 1 - STATED / ESTIMATED SPEED 2 - CALCULATED / EDR 3 - UNDETERMINED |
| POSTED SPEED | |
| <u>50</u> | |



MOTORIST / Non-MOTORIST

LOCAL REPORT NUMBER
 L P 2 0 0 3 0 4 0 0 1 0 3 7

| | | | | | | | | | | |
|---|---|--|---|---|--|--------------------------------|--|----------------------|--|--|
| UNIT # 0 1 | NAME: LAST, FIRST, MIDDLE ADAMS, DONALD G | | DATE OF BIRTH 0 6 / 0 2 / 1 9 4 2 | | AGE 7 7 | GENDER M | | | | |
| ADDRESS: STREET, CITY, STATE, ZIP 2387 MCCLELLAND AVE, KINGS MILLS, OH, 45034 | | | | CONTACT PHONE - INCLUDE AREA CODE 5 1 3 8 9 7 4 2 7 7 | | | | | | |
| INJURIES TAKEN BY 5 | EMS AGENCY (NAME) | INJURED TAKEN TO: MEDICAL FACILITY (NAME, CITY) | | SAFETY EQUIPMENT USED 0 4 | <input type="checkbox"/> DOT-COMPLIANT MC HELMET | SEATING POSITION 0 1 | AIR BAG USAGE 1 | EJECTION 1 | TRAPPED 1 | |
| OL STATE O H | OPERATOR LICENSE NUMBER RR484046 | OFFENSE CHARGED 4511.202 | LOCAL CODE <input type="checkbox"/> | OFFENSE DESCRIPTION FAIL TO MAINTAIN CONTROL | | | CITATION NUMBER LP017497 | | | |
| OL CLASS 4 | ENDORSEMENT SELECT UP TO 2 | RESTRICTION SELECT UP TO 3 | DRIVER DISTRACTED BY 9 | ALCOHOL / DRUG SUSPECTED <input type="checkbox"/> ALCOHOL <input type="checkbox"/> MARIJUANA <input type="checkbox"/> OTHER DRUG | | CONDITION 1 | ALCOHOL TEST STATUS TYPE VALUE | | DRUG TEST(S) STATUS TYPE RESULT SELECT UP TO 4 | |

| | | | | | | | | | | |
|--|--------------------------------------|--|-----------------------------|---|--|-------------------------|--|-----------------|--|--|
| UNIT # | NAME: LAST, FIRST, MIDDLE | | DATE OF BIRTH | | AGE | GENDER | | | | |
| ADDRESS: STREET, CITY, STATE, ZIP | | | | CONTACT PHONE - INCLUDE AREA CODE | | | | | | |
| INJURIES TAKEN BY | EMS AGENCY (NAME) | INJURED TAKEN TO: MEDICAL FACILITY (NAME, CITY) | | SAFETY EQUIPMENT USED | <input type="checkbox"/> DOT-COMPLIANT MC HELMET | SEATING POSITION | AIR BAG USAGE | EJECTION | TRAPPED | |
| OL STATE | OPERATOR LICENSE NUMBER | OFFENSE CHARGED | LOCAL CODE | OFFENSE DESCRIPTION | | | CITATION NUMBER | | | |
| OL CLASS | ENDORSEMENT SELECT UP TO 2 | RESTRICTION SELECT UP TO 3 | DRIVER DISTRACTED BY | ALCOHOL / DRUG SUSPECTED <input type="checkbox"/> ALCOHOL <input type="checkbox"/> MARIJUANA <input type="checkbox"/> OTHER DRUG | | CONDITION | ALCOHOL TEST STATUS TYPE VALUE | | DRUG TEST(S) STATUS TYPE RESULT SELECT UP TO 4 | |

| | | | | | | | | | | |
|--|--------------------------------------|--|-----------------------------|---|--|-------------------------|--|-----------------|--|--|
| UNIT # | NAME: LAST, FIRST, MIDDLE | | DATE OF BIRTH | | AGE | GENDER | | | | |
| ADDRESS: STREET, CITY, STATE, ZIP | | | | CONTACT PHONE - INCLUDE AREA CODE | | | | | | |
| INJURIES TAKEN BY | EMS AGENCY (NAME) | INJURED TAKEN TO: MEDICAL FACILITY (NAME, CITY) | | SAFETY EQUIPMENT USED | <input type="checkbox"/> DOT-COMPLIANT MC HELMET | SEATING POSITION | AIR BAG USAGE | EJECTION | TRAPPED | |
| OL STATE | OPERATOR LICENSE NUMBER | OFFENSE CHARGED | LOCAL CODE | OFFENSE DESCRIPTION | | | CITATION NUMBER | | | |
| OL CLASS | ENDORSEMENT SELECT UP TO 2 | RESTRICTION SELECT UP TO 3 | DRIVER DISTRACTED BY | ALCOHOL / DRUG SUSPECTED <input type="checkbox"/> ALCOHOL <input type="checkbox"/> MARIJUANA <input type="checkbox"/> OTHER DRUG | | CONDITION | ALCOHOL TEST STATUS TYPE VALUE | | DRUG TEST(S) STATUS TYPE RESULT SELECT UP TO 4 | |

| INJURIES | SEATING POSITION | AIR BAG | OL CLASS | OL RESTRICTION(S) | DRIVER DISTRACTION | TEST STATUS |
|---|--|---|--|---|--|--|
| 1 - FATAL 2 - SUSPECTED SERIOUS INJURY 3 - SUSPECTED MINOR INJURY 4 - POSSIBLE INJURY 5 - NO APPARENT INJURY | 1 - FRONT - LEFT SIDE (MOTORCYCLE DRIVER) 2 - FRONT - MIDDLE 3 - FRONT - RIGHT SIDE 4 - SECOND - LEFT SIDE (MOTORCYCLE PASSENGER) 5 - SECOND - MIDDLE 6 - SECOND - RIGHT SIDE 7 - THIRD - LEFT SIDE (MOTORCYCLE SIDE CAR) 8 - THIRD - MIDDLE 9 - THIRD - RIGHT SIDE 10 - SLEEPER SECTION OF TRUCK CAB | 1 - NOT DEPLOYED 2 - DEPLOYED FRONT 3 - DEPLOYED SIDE 4 - DEPLOYED BOTH FRONT / SIDE 5 - NOT APPLICABLE 9 - DEPLOYMENT UNKNOWN | 1 - CLASS A 2 - CLASS B 3 - CLASS C 4 - REGULAR CLASS (OHIO = D) 5 - M/C MOPED ONLY 6 - NO VALID OL | 1 - ALCOHOL INTERLOCK DEVICE 2 - CDL INTRASTATE ONLY 3 - CORRECTIVE LENSES 4 - FARM WAIVER 5 - EXCEPT CLASS A BUS & CLASS B BUS 6 - EXCEPT CLASS A & CLASS B BUS 7 - EXCEPT TRACTOR-TRAILER 8 - INTERMEDIATE LICENSE RESTRICTIONS 9 - LEARNER'S PERMIT RESTRICTIONS 10 - LIMITED TO DAYLIGHT ONLY 11 - LIMITED TO EMPLOYMENT 12 - LIMITED - OTHER 13 - MECHANICAL DEVICES (SPECIAL BRAKES, HAND CONTROLS, OR OTHER ADAPTIVE DEVICES) 14 - MILITARY VEHICLES ONLY 15 - MOTOR VEHICLES WITHOUT AIR BRAKES 16 - OUTSIDE MIRROR 17 - PROSTHETIC AID 18 - OTHER | 1 - NOT DISTRACTED 2 - MANUALLY OPERATING AN ELECTRONIC COMMUNICATION DEVICE (TEXTING, TYPING, DIALING) 3 - TALKING ON HANDS-FREE COMMUNICATION DEVICE 4 - TALKING ON HAND-HELD COMMUNICATION DEVICE 5 - OTHER ACTIVITY WITH AN ELECTRONIC DEVICE 6 - PASSENGER 7 - OTHER DISTRACTION INSIDE THE VEHICLE 8 - OTHER DISTRACTION OUTSIDE THE VEHICLE 9 - OTHER / UNKNOWN | 1 - NONE GIVEN 2 - TEST REFUSED 3 - TEST GIVEN, CONTAMINATED SAMPLE / UNUSABLE 4 - TEST GIVEN, RESULTS KNOWN 5 - TEST GIVEN, RESULTS UNKNOWN |
| INJURED TAKEN BY 1 - NOT TRANSPORTED / TREATED AT SCENE 2 - EMS 3 - POLICE 9 - OTHER / UNKNOWN | | EJECTION 1 - NOT EJECTED 2 - PARTIALLY EJECTED 3 - TOTALLY EJECTED 4 - NOT APPLICABLE | OL ENDORSEMENT H - HAZMAT M - MOTORCYCLE P - PASSENGER N - TANKER Q - MOTOR SCOOTER R - THREE-WHEEL MOTORCYCLE S - SCHOOL BUS T - DOUBLE & TRIPLE TRAILERS X - TANKER / HAZMAT | | | ALCOHOL TEST TYPE 1 - NONE 2 - BLOOD 3 - URINE 4 - BREATH 5 - OTHER |
| SAFETY EQUIPMENT 1 - NONE USED 2 - SHOULDER BELT ONLY USED 4 - SHOULDER & LAP BELT USED 5 - CHILD RESTRAINT SYSTEM - FORWARD FACING 6 - CHILD RESTRAINT SYSTEM - REAR FACING 7 - BOOSTER SEAT 8 - HELMET USED 9 - PROTECTIVE PADS USED (ELBOW, KNEES, ETC.) 10 - REFLECTIVE CLOTHING 11 - LIGHTING - PEDESTRIAN / BICYCLE ONLY 99 - OTHER / UNKNOWN | 11 - PASSENGER IN OTHER ENCLOSED CARGO AREA (NON-TRAILING UNIT, BUS, PICK-UP WITH CAP) 12 - PASSENGER IN UNENCLOSED CARGO AREA 13 - TRAILING UNIT 14 - RIDING ON VEHICLE EXTERIOR (NON-TRAILING UNIT) 15 - NON-MOTORIST 99 - OTHER / UNKNOWN | TRAPPED 1 - NOT TRAPPED 2 - EXTRICATED BY MECHANICAL MEANS 3 - FREED BY NON-MECHANICAL MEANS | | | CONDITION 1 - APPARENTLY NORMAL 2 - PHYSICAL IMPAIRMENT 3 - EMOTIONAL (E.G., DEPRESSED, ANGRY, DISTURBED) 4 - ILLNESS 5 - FELL ASLEEP, FAINTED, FATIGUED, ETC. 6 - UNDER THE INFLUENCE OF MEDICATIONS / DRUGS / ALCOHOL 9 - OTHER / UNKNOWN | DRUG TEST TYPE 1 - NONE 2 - BLOOD 3 - URINE 4 - OTHER |
| | | | | | | DRUG TEST RESULT(S) 1 - AMPHETAMINES 2 - BARBITURATES 3 - BENZODIAZEPINES 4 - CANNABINOIDS 5 - COCAINE 6 - OPIATES / OPIOIDS 7 - OTHER 8 - NEGATIVE RESULTS |