

# TRAFFIC CRASH REPORT

\*DENOTES MANDATORY FIELD FOR SUPPLEMENT REPORT

LOCAL REPORT NUMBER\*

<input checked="" type="checkbox"/> PHOTOS TAKEN <input checked="" type="checkbox"/> OH-2 <input checked="" type="checkbox"/> OH-3 <input type="checkbox"/> SECONDARY CRASH <input type="checkbox"/> OH-1P <input type="checkbox"/> OTHER <input type="checkbox"/> PRIVATE PROPERTY		LOCAL INFORMATION REPORTING AGENCY NAME* <b>CLEARCREEK TWP PD</b>		NCIC* <b>0 8 3 1 6</b>		<b>L P 1 9 0 5 0 6 0 0 2 2 0 0</b>	
COUNTY* <b>8 3</b>		LOCALITY* <b>3</b>		LOCATION: CITY, VILLAGE, TOWNSHIP* <b>CLEARCREEK</b>		CRASH DATE / TIME* <b>05062019 1719</b>	
ROUTE TYPE <b>W</b>		ROUTE NUMBER <b>3</b>		PREFIX 1-NORTH 2-SOUTH 3-EAST 4-WEST		LOCATION ROAD NAME <b>PEKIN</b>	
ROUTE TYPE <b>L N</b>		ROUTE NUMBER <b>8 4</b>		PREFIX 1-NORTH 2-SOUTH 3-EAST 4-WEST		REFERENCE ROAD NAME (ROAD, MILEPOST, HOUSE #) <b>BELLE TERRACE</b>	
REFERENCE POINT 1- INTERSECTION 2- MILE POST 3- HOUSE # <b>1</b>		DIRECTION FROM REFERENCE 1-NORTH 2-SOUTH 3-EAST 4-WEST <b>3</b>		ROUTE TYPE IR - INTERSTATE ROUTE(TP) US - FEDERAL US ROUTE SR - STATE ROUTE CR - NUMBERED COUNTY ROUTE TR - NUMBERED TOWNSHIP ROUTE		ROAD TYPE AL - ALLEY    HW - HIGHWAY    RD - ROAD AV - AVENUE    LA - LANE    SQ - SQUARE BL - BOULEVARD    MP - MILEPOST    ST - STREET CR - CIRCLE    OV - OVAL    TE - TERRACE CT - COURT    PK - PARKWAY    TL - TRAIL DR - DRIVE    PI - PIKE    WA - WAY HE - HEIGHTS    PL - PLACE	
DISTANCE FROM REFERENCE <b>0 6 0</b>		DISTANCE UNIT OF MEASURE 1- MILES 2- FEET 3- YARDS <b>2</b>		INTERSECTION RELATED <input type="checkbox"/> WITHIN INTERSECTION OR ON APPROACH <input type="checkbox"/> WITHIN INTERCHANGE AREA		NUMBER OF APPROACHES <b>1</b>	
LOCATION OF FIRST HARMFUL EVENT 1- ON ROADWAY 2- ON SHOULDER 3- IN MEDIAN 4- ON ROADSIDE 5- ON GORE 6- OUTSIDE TRAFFIC WAY 7- ON RAMP 8- OFF RAMP <b>0 2</b>		MANNER OF CRASH COLLISION/IMPACT 1- NOT COLLISION BETWEEN TWO MOTOR VEHICLES IN TRANSPORT 2- REAR-END 3- HEAD-ON <b>1</b>		4- REAR-TO-REAR 5- BACKING 6- ANGLE 7- SIDESWIPE, SAME DIRECTION 8- SIDESWIPE, OPPOSITE DIRECTION 9- OTHER / UNKNOWN		DIRECTION OF TRAVEL 1- NORTH 2- SOUTH 3- EAST 4- WEST <b>1</b>	
<input type="checkbox"/> WORK ZONE RELATED <input type="checkbox"/> WORKERS PRESENT <input type="checkbox"/> LAW ENFORCEMENT PRESENT <input type="checkbox"/> ACTIVE SCHOOL ZONE		WORK ZONE TYPE 1- LANE CLOSURE 2- LANE SHIFT/CROSSOVER 3- WORK ON SHOULDER OR MEDIAN 4- INTERMITTENT OR MOVING WORK 5- OTHER		LOCATION OF CRASH IN WORK ZONE 1- BEFORE THE 1ST WORK ZONE WARNING SIGN 2- ADVANCE WARNING AREA 3- TRANSITION AREA 4- ACTIVITY AREA 5- TERMINATION AREA		CONTOUR <b>2</b> 1- STRAIGHT LEVEL 2- STRAIGHT GRADE 3- CURVE LEVEL 4- CURVE GRADE 9- OTHER/UNKNOWN	
LIGHT CONDITION 1- DAYLIGHT 2- DAWN/DUSK 3- DARK - LIGHTED ROADWAY 4- DARK - ROADWAY NOT LIGHTED 5- DARK - UNKNOWN ROADWAY LIGHTING 9- OTHER / UNKNOWN <b>1</b>		WEATHER 1- CLEAR 2- CLOUDY 3- FOG, SMOG, SMOKE 4- RAIN 5- SLEET, HAIL <b>0 1</b>		6- SNOW 7- SEVERE CROSSWINDS 8- BLOWING SAND, SOIL, DIRT, SNOW 9- FREEZING RAIN OR FREEZING DRIZZLE 99- OTHER / UNKNOWN		CONDITIONS <b>1</b> 1- DRY 2- WET 3- SNOW 4- ICE 5- SAND, MUD, DIRT, OIL, GRAVEL 6- WATER (STANDING, MOVING) 7- SLUSH 9- OTHER/UNKNOWN	
SURFACE <b>2</b> 1- CONCRETE 2- BLACKTOP, BITUMINOUS, ASPHALT 3- BRICK/BLOCK 4- SLAG, GRAVEL, STONE 5- DIRT 9- OTHER/UNKNOWN		NARRATIVE <b>UNIT #1 WAS TRAVELING WEST ON PEKIN RD APPROACHING THE INTERSECTION OF BELLE TERRACE LN. UNIT #1 FAILED TO MAINTAIN CONTROL AND DROVE OFF THE RIGHT SIDE OF THE ROADWAY. UNIT #1 CAME BACK ONTO THE ROADWAY CROSSING THE CENTER LINE AND DRIVING OFF THE RIGHT SIDE. UNIT #1 FLIPPED OVER TWICE BEFORE COMING TO FINAL REST, PARTIALLY ON A FENCE OFF THE RIGHT SIDE OF THE ROAD.</b>					
CRASH REPORTED DATE / TIME <b>0 5 0 6 2 0 1 9 1 7 1 9</b>		DISPATCH DATE / TIME <b>0 5 0 6 2 0 1 9 1 7 1 9</b>		ARRIVAL DATE / TIME <b>0 5 0 6 2 0 1 9 1 7 2 5</b>		SCENE CLEARED DATE / TIME <b>0 5 0 6 2 0 1 9 1 9 4 3</b>	
TOTAL TIME ROADWAY CLOSED <b>1 4 4</b>		OTHER INVESTIGATION TIME <b>0 3 0</b>		TOTAL MINUTES <b>1 7 4</b>		OFFICER'S NAME* <b>CHARLES S. SWEET</b>	
OFFICER'S BADGE NUMBER* <b>1 L 3 0</b>		CHECKED BY OFFICER'S NAME* <b>JASON L BATES</b>		CHECKED BY OFFICER'S BADGE NUMBER* <b>1 L 2 2</b>		REPORT TAKEN BY <input checked="" type="checkbox"/> POLICE AGENCY <input type="checkbox"/> MOTORIST <input type="checkbox"/> SUPPLEMENT (CORRECTION OR ADDITION TO AN EXISTING REPORT SENT TO DOPS)	

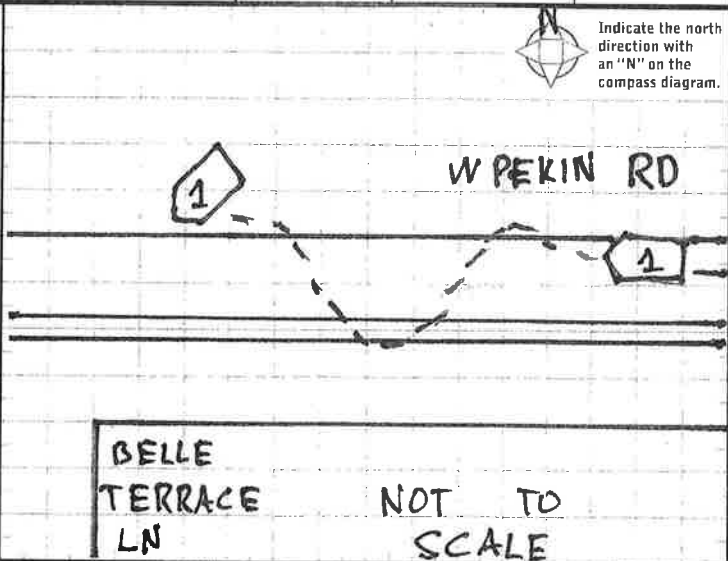

**OWNER**

UNIT # 01 OWNER NAME: LAST, FIRST, MIDDLE (☐ SAME AS DRIVER)  
**DODGE, DARIN**

OWNER PHONE: INCLUDE AREA CODE (☐ SAME AS DRIVER)  
9378627000

OWNER ADDRESS: STREET, CITY, STATE, ZIP (☐ SAME AS DRIVER)  
**1985 ROXANNA NEW BURLINGTON RD, WAYNESVILLE, OH, 45068**

COMMERCIAL CARRIER: NAME, ADDRESS, CITY, STATE, ZIP  
 COMMERCIAL CARRIER PHONE: INCLUDE AREA CODE

**VEHICLE**

LP STATE OH LICENSE PLATE # PKC6306 VEHICLE IDENTIFICATION # 1HSMTAAN86H124219 VEHICLE YEAR 2006 VEHICLE MAKE INTERNATIO

INSURANCE VERIFIED INSURANCE COMPANY WESTFIELD INSURANCE POLICY # TRA3766758 COLOR WHITE VEHICLE MODEL DT466

COMMERCIAL  GOVERNMENT  IN EMERGENCY RESPONSE TYPE OF USE

INTERLOCK DEVICE EQUIPPED  HIT/SKIP UNIT # OCCUPANTS 01 US DOT # 1 TOWED BY: COMPANY NAME MOORMANS

HAZARDOUS MATERIAL CLASS #      PLACARD ID #     

UNIT TYPE: 1, 4  
 1 - PASSENGER CAR 7 - MOTORCYCLE 2-WHEELED 12 - GOLF CART 18 - LIMO (LIVERY VEHICLE) 23 - PEDESTRIAN / SKATER  
 2 - PASSENGER VAN (MINIVAN) 8 - MOTORCYCLE 3-WHEELED 13 - SNOWMOBILE 19 - BUS (16+ PASSENGERS) 24 - WHEELCHAIR (ANY TYPE)  
 3 - SPORT UTILITY VEHICLE 9 - AUTOCYCLE 14 - SINGLE UNIT TRUCK 20 - OTHER VEHICLE 25 - OTHER NON-MOTORIST  
 4 - PICK UP 10 - MOPED OR MOTORIZED BICYCLE 15 - SEMI-TRACTOR 21 - HEAVY EQUIPMENT 26 - BICYCLE  
 5 - CARGO VAN 11 - ALL TERRAIN VEHICLE (ATV / UTV) 16 - FARM EQUIPMENT 22 - ANIMAL WITH RIDER OR ANIMAL-DRAWN VEHICLE 27 - TRAIN  
 6 - VAN (9-15 SEATS) 17 - MOTORHOME

# OF TRAILING UNITS     

WAS VEHICLE OPERATING IN AUTONOMOUS MODE WHEN CRASH OCCURRED?       
 0 - NO AUTOMATION 1 - DRIVER ASSISTANCE 3 - CONDITIONAL AUTOMATION 9 - UNKNOWN  
 1 - YES 2 - NO 9 - OTHER / UNKNOWN 2 - PARTIAL AUTOMATION 5 - FULL AUTOMATION

AUTONOMOUS MODE LEVEL

SPECIAL FUNCTION 9, 9  
 1 - NONE 6 - BUS - CHARTER/TOUR 11 - FIRE 16 - FARM 21 - MAIL CARRIER  
 2 - TAXI 7 - BUS - INTERCITY 12 - MILITARY 17 - MOWING 99 - OTHER / UNKNOWN  
 3 - ELECTRONIC RIDE SHARING 8 - BUS - SHUTTLE 13 - POLICE 18 - SNOW REMOVAL  
 4 - SCHOOL TRANSPORT 9 - BUS - OTHER 14 - PUBLIC UTILITY 19 - TOWING  
 5 - BUS - TRANSIT/COMMUTER 10 - AMBULANCE 15 - CONSTRUCTION EQUIPMENT 20 - SAFETY SERVICE PATROL

CARGO BODY TYPE 1, 1  
 1 - NO CARGO BODY TYPE / NOT APPLICABLE 3 - VEHICLE TOWING ANOTHER MOTOR VEHICLE 5 - INTERMODAL CONTAINER CHASSIS 8 - POLE 12 - CONCRETE MIXER  
 2 - BUS 4 - LOGGING 6 - CARGO VAN/ENCLOSED BOX 9 - CARGO TANK 13 - AUTO TRANSPORTER  
 7 - GRAIN/CHIPS/GRAVEL 10 - FLAT BED 11 - DUMP 14 - GARBAGE/REFUSE 19 - OTHER / UNKNOWN

VEHICLE DEFECTS       
 1 - TURN SIGNALS 4 - BRAKES 7 - WORN OR SLICK TIRES 9 - MOTOR TROUBLE 99 - OTHER / UNKNOWN  
 2 - HEAD LAMPS 5 - STEERING 8 - TRAILER EQUIPMENT DEFECTIVE 10 - DISABLED FROM PRIOR ACCIDENT  
 3 - TAIL LAMPS 6 - TIRE BLOWOUT

NON-MOTORIST LOCATION AT IMPACT       
 1 - INTERSECTION - MARKED CROSSWALK 3 - INTERSECTION - OTHER 6 - BICYCLE LANE 9 - MEDIAN/CROSSING ISLAND 12 - FIRST RESPONDER AT INCIDENT SCENE  
 2 - INTERSECTION - UNMARKED CROSSWALK 4 - MIDBLOCK - MARKED CROSSWALK 7 - SHOULDER / ROADSIDE 10 - DRIVEWAY ACCESS 99 - OTHER / UNKNOWN  
 5 - TRAVEL LANE - OTHER LOCATION 8 - SIDEWALK 11 - SHARED USE PATHS OR TRAILS

ACTION 3 PRE-CRASH ACTIONS 0, 1  
 1 - NON-CONTACT 1 - STRAIGHT AHEAD 7 - MAKING U-TURN 13 - NEGOTIATING A CURVE 18 - APPROACHING OR LEAVING VEHICLE  
 2 - NON-COLLISION 2 - BACKING 8 - ENTERING TRAFFIC LANE 14 - ENTERING OR CROSSING SPECIFIED LOCATION 19 - STANDING  
 3 - STRIKING 3 - CHANGING LANES 9 - LEAVING TRAFFIC LANE 15 - WALKING, RUNNING, JOGGING, PLAYING 20 - OTHER NON-MOTORIST  
 4 - STRUCK 4 - OVERTAKING/PASSING 10 - PARKED 16 - WORKING 21 - STANDING OUTSIDE DISABLED VEHICLE  
 5 - BOTH STRIKING & STRUCK 5 - MAKING RIGHT TURN 11 - SLOWING OR STOPPED IN TRAFFIC 17 - PUSHING VEHICLE 99 - OTHER / UNKNOWN  
 9 - OTHER / UNKNOWN 6 - MAKING LEFT TURN 12 - DRIVERLESS

CONTRIBUTING CIRCUMSTANCES 1, 1  
 1 - NONE 7 - LEFT OF CENTER 13 - IMPROPER START FROM A PARKED POSITION 17 - VISION OBSTRUCTION 21 - LYING IN ROADWAY  
 2 - FAILURE TO YIELD 8 - FOLLOWING TOO CLOSE / ACDA 14 - STOPPED OR PARKED ILLEGALLY 18 - OPERATING DEFECTIVE EQUIPMENT 22 - NOT DISCERNIBLE  
 3 - RAN RED LIGHT 9 - IMPROPER LANE CHANGE 15 - SWERVING TO AVOID 19 - LOAD SHIFTING/FALLING/SPILLING 23 - OPENING DOOR INTO ROADWAY  
 4 - RAN STOP SIGN 10 - IMPROPER PASSING 16 - WRONG WAY 20 - IMPROPER CROSSING 99 - OTHER IMPROPER ACTION  
 5 - UNSAFE SPEED 11 - DROVE OFF ROAD 17 - IMPROPER BACKING

**EVENT(S)**

SEQUENCE OF EVENTS  
 1 0, 8 1 - OVERTURN/ROLLOVER 6 - EQUIPMENT FAILURE  
 2 4, 4 2 - FIRE/EXPLOSION 7 - SEPARATION OF UNITS  
 3 0, 8 3 - IMMERSION 8 - RAN OFF ROAD RIGHT  
 4 4, 4 4 - JACKKNIFE 9 - RAN OFF ROAD LEFT  
 5 0, 1 5 - CARGO / EQUIPMENT LOSS OR SHIFT 10 - CROSS MEDIAN  
 6 4, 6 25 - IMPACT ATTENUATOR / CRASH CUSHION 31 - GUARDRAIL END 37 - TRAFFIC SIGN POST 43 - CURB 50 - WORK ZONE MAINTENANCE EQUIPMENT  
 26 - BRIDGE OVERHEAD STRUCTURE 32 - PORTABLE BARRIER 38 - OVERHEAD SIGN POST 44 - DITCH 51 - WALL  
 27 - BRIDGE PIER OR ABUTMENT BARRIER 33 - MEDIAN CABLE BARRIER 39 - LIGHT / LUMINARIES SUPPORT 45 - EMBANKMENT 52 - BUILDING  
 28 - BRIDGE PARAPET 34 - MEDIAN GUARDRAIL BARRIER 40 - UTILITY POLE 46 - FENCE 53 - TUNNEL  
 29 - BRIDGE RAIL 35 - MEDIAN CONCRETE BARRIER 41 - OTHER POST, POLE OR SUPPORT 47 - MAILBOX 54 - OTHER FIXED OBJECT  
 30 - GUARDRAIL FACE 36 - MEDIAN OTHER BARRIER 42 - CULVERT 48 - TREE 99 - OTHER / UNKNOWN  
 49 - FIRE HYDRANT

FIRST HARMFUL EVENT 5 MOST HARMFUL EVENT 5

LOCAL REPORT NUMBER  
L P 190506002200

**DAMAGE**

DAMAGE SCALE  
4 1 - NONE 3 - FUNCTIONAL DAMAGE  
 2 - MINOR DAMAGE 4 - DISABLING DAMAGE  
 9 - UNKNOWN

**DAMAGED AREA(S)**  
 INDICATE ALL THAT APPLY

NO DAMAGE [ 0 ]  UNDERCARRIAGE [ 14 ]  
 TOP [ 13 ]  ALL AREAS [ 15 ]  
 UNIT NOT AT SCENE [ 16 ]

INITIAL POINT OF CONTACT  
1, 3 0 - NO DAMAGE 14 - UNDERCARRIAGE  
 1-12 - REFER TO UNIT DIAGRAM 15 - VEHICLE NOT AT SCENE  
 13 - TOP 99 - UNKNOWN

**TRAFFIC**

TRAFFICWAY FLOW  
2 1 - ONE-WAY 2 - TWO-WAY

TRAFFIC CONTROL  
6 1 - ROUNDABOUT 4 - STOP SIGN  
 2 - SIGNAL 5 - YIELD SIGN  
 3 - FLASHER 6 - NO CONTROL

# OF THROUGH LANES ON ROAD 2

RAIL GRADE CROSSING  
     1 - NOT INVOLVED  
 2 - INVOLVED-ACTIVE CROSSING  
 3 - INVOLVED-PASSIVE CROSSING

**UNIT / NON-MOTORIST DIRECTION**

FROM 3 TO 4

1 - NORTH 5 - NORTHEAST  
 2 - SOUTH 6 - NORTHWEST  
 3 - EAST 7 - SOUTHEAST  
 4 - WEST 8 - SOUTHWEST  
 9 - OTHER / UNKNOWN

UNIT SPEED 050

POSTED SPEED 55

DETECTED SPEED  
1 1 - STATED / ESTIMATED SPEED  
 2 - CALCULATED / EDR  
 3 - UNDETERMINED



# MOTORIST / Non-MOTORIST

LOCAL REPORT NUMBER  
L P 1 9 0 5 0 6 0 0 2 2 0 0

<b>UNIT #</b> 0 1	<b>NAME: LAST, FIRST, MIDDLE</b> WARD, MARK, ZACHARY		<b>DATE OF BIRTH</b> 0 6 / 0 9 / 1 9 8 8		<b>AGE</b> 3 0	<b>GENDER</b> M			
<b>ADDRESS: STREET, CITY, STATE, ZIP</b> 531 N KING ST, XENIA, OH, 45385				<b>CONTACT PHONE - INCLUDE AREA CODE</b> 9 3 7 5 5 8 6 1 0 1					
<b>INJURIES</b> 5	<b>INJURED TAKEN BY</b>	<b>EMS AGENCY (NAME)</b>	<b>INJURED TAKEN TO: MEDICAL FACILITY (NAME, CITY)</b>	<b>SAFETY EQUIPMENT USED</b> 0 4	<input type="checkbox"/> DOT-COMPLIANT MC HELMET	<b>SEATING POSITION</b> 0 1	<b>AIR BAG USAGE</b> 1	<b>EJECTION</b> 1	<b>TRAPPED</b> 1
<b>OL STATE</b> O H	<b>OPERATOR LICENSE NUMBER</b> SW039882		<b>OFFENSE CHARGED</b> 4511.202	<b>LOCAL CODE</b> <input type="checkbox"/>	<b>OFFENSE DESCRIPTION</b> FAILURE TO CONTROL		<b>CITATION NUMBER</b> 017600		
<b>OL CLASS</b> 2	<b>ENDORSEMENT</b> N	<b>RESTRICTION</b>	<b>DRIVER DISTRACTED BY</b> 1	<b>ALCOHOL / DRUG SUSPECTED</b> <input type="checkbox"/> ALCOHOL <input type="checkbox"/> MARIJUANA <input type="checkbox"/> OTHER DRUG		<b>CONDITION</b> 1	<b>ALCOHOL TEST</b> STATUS: 1, TYPE: 1, VALUE: .		<b>DRUG TEST(S)</b> STATUS: 1, TYPE: 1, RESULT: .

<b>UNIT #</b>	<b>NAME: LAST, FIRST, MIDDLE</b>		<b>DATE OF BIRTH</b>		<b>AGE</b>	<b>GENDER</b>			
<b>ADDRESS: STREET, CITY, STATE, ZIP</b>				<b>CONTACT PHONE - INCLUDE AREA CODE</b>					
<b>INJURIES</b>	<b>INJURED TAKEN BY</b>	<b>EMS AGENCY (NAME)</b>	<b>INJURED TAKEN TO: MEDICAL FACILITY (NAME, CITY)</b>	<b>SAFETY EQUIPMENT USED</b>	<input type="checkbox"/> DOT-COMPLIANT MC HELMET	<b>SEATING POSITION</b>	<b>AIR BAG USAGE</b>	<b>EJECTION</b>	<b>TRAPPED</b>
<b>OL STATE</b>	<b>OPERATOR LICENSE NUMBER</b>		<b>OFFENSE CHARGED</b>	<b>LOCAL CODE</b>	<b>OFFENSE DESCRIPTION</b>		<b>CITATION NUMBER</b>		
<b>OL CLASS</b>	<b>ENDORSEMENT</b>	<b>RESTRICTION</b>	<b>DRIVER DISTRACTED BY</b>	<b>ALCOHOL / DRUG SUSPECTED</b> <input type="checkbox"/> ALCOHOL <input type="checkbox"/> MARIJUANA <input type="checkbox"/> OTHER DRUG		<b>CONDITION</b>	<b>ALCOHOL TEST</b> STATUS: , TYPE: , VALUE: .		<b>DRUG TEST(S)</b> STATUS: , TYPE: , RESULT: .

<b>UNIT #</b>	<b>NAME: LAST, FIRST, MIDDLE</b>		<b>DATE OF BIRTH</b>		<b>AGE</b>	<b>GENDER</b>			
<b>ADDRESS: STREET, CITY, STATE, ZIP</b>				<b>CONTACT PHONE - INCLUDE AREA CODE</b>					
<b>INJURIES</b>	<b>INJURED TAKEN BY</b>	<b>EMS AGENCY (NAME)</b>	<b>INJURED TAKEN TO: MEDICAL FACILITY (NAME, CITY)</b>	<b>SAFETY EQUIPMENT USED</b>	<input type="checkbox"/> DOT-COMPLIANT MC HELMET	<b>SEATING POSITION</b>	<b>AIR BAG USAGE</b>	<b>EJECTION</b>	<b>TRAPPED</b>
<b>OL STATE</b>	<b>OPERATOR LICENSE NUMBER</b>		<b>OFFENSE CHARGED</b>	<b>LOCAL CODE</b>	<b>OFFENSE DESCRIPTION</b>		<b>CITATION NUMBER</b>		
<b>OL CLASS</b>	<b>ENDORSEMENT</b>	<b>RESTRICTION</b>	<b>DRIVER DISTRACTED BY</b>	<b>ALCOHOL / DRUG SUSPECTED</b> <input type="checkbox"/> ALCOHOL <input type="checkbox"/> MARIJUANA <input type="checkbox"/> OTHER DRUG		<b>CONDITION</b>	<b>ALCOHOL TEST</b> STATUS: , TYPE: , VALUE: .		<b>DRUG TEST(S)</b> STATUS: , TYPE: , RESULT: .

INJURIES	SEATING POSITION	AIR BAG	OL CLASS	OL RESTRICTION(S)	DRIVER DISTRACTION	TEST STATUS
1 - FATAL	1 - FRONT - LEFT SIDE (MOTORCYCLE DRIVER)	1 - NOT DEPLOYED	1 - CLASS A	1 - ALCOHOL INTERLOCK DEVICE	1 - NOT DISTRACTED	1 - NONE GIVEN
2 - SUSPECTED SERIOUS INJURY	2 - FRONT - MIDDLE	2 - DEPLOYED FRONT	2 - CLASS B	2 - CDL INTRASTATE ONLY	2 - MANUALLY OPERATING AN ELECTRONIC COMMUNICATION DEVICE (TEXTING, TYPING, DIALING)	2 - TEST REFUSED
3 - SUSPECTED MINOR INJURY	3 - FRONT - RIGHT SIDE	3 - DEPLOYED SIDE	3 - CLASS C	3 - CORRECTIVE LENSES	3 - TALKING ON HANDS-FREE COMMUNICATION DEVICE	3 - TEST GIVEN, CONTAMINATED SAMPLE / UNUSABLE
4 - POSSIBLE INJURY	4 - SECOND - LEFT SIDE (MOTORCYCLE PASSENGER)	4 - DEPLOYED BOTH FRONT / SIDE	4 - REGULAR CLASS (OHIO = D)	4 - FARM WAIVER	4 - TALKING ON HAND-HELD COMMUNICATION DEVICE	4 - TEST GIVEN, RESULTS KNOWN
5 - NO APPARENT INJURY	5 - SECOND - MIDDLE	5 - NOT APPLICABLE	5 - M/C MOPEO ONLY	5 - EXCEPT CLASS A BUS	5 - OTHER ACTIVITY WITH AN ELECTRONIC DEVICE	5 - TEST GIVEN, RESULTS UNKNOWN
<b>INJURED TAKEN BY</b>	6 - SECOND - RIGHT SIDE	9 - DEPLOYMENT UNKNOWN	6 - NO VALID OL	6 - EXCEPT CLASS A & CLASS B BUS	6 - PASSENGER	<b>ALCOHOL TEST TYPE</b>
1 - NOT TRANSPORTED / TREATED AT SCENE	7 - THIRD - LEFT SIDE (MOTORCYCLE SIDE CAR)	<b>EJECTION</b>	<b>OL ENDORSEMENT</b>	7 - EXCEPT TRACTOR-TRAILER	7 - OTHER DISTRACTION INSIDE THE VEHICLE	1 - NONE
2 - EMS	8 - THIRD - MIDDLE	1 - NOT EJECTED	H - HAZMAT	8 - INTERMEDIATE LICENSE RESTRICTIONS	8 - OTHER DISTRACTION OUTSIDE THE VEHICLE	2 - BLOOD
3 - POLICE	9 - THIRD - RIGHT SIDE	2 - PARTIALLY EJECTED	M - MOTORCYCLE	9 - LEARNER'S PERMIT RESTRICTIONS	9 - OTHER / UNKNOWN	3 - URINE
9 - OTHER / UNKNOWN	10 - SLEEPER SECTION OF TRUCK CAB	3 - TOTALLY EJECTED	P - PASSENGER	10 - LIMITED TO DAYLIGHT ONLY	<b>CONDITION</b>	4 - BREATH
<b>SAFETY EQUIPMENT</b>	11 - PASSENGER IN OTHER ENCLOSED CARGO AREA (NON-TRAILING UNIT, BUS, PICK-UP WITH CAP)	4 - NOT APPLICABLE	N - TANKER	11 - LIMITED TO EMPLOYMENT	1 - APPARENTLY NORMAL	5 - OTHER
1 - NONE USED	12 - PASSENGER IN UNENCLOSED CARGO AREA	<b>TRAPPED</b>	Q - MOTOR SCOOTER	12 - LIMITED - OTHER	2 - PHYSICAL IMPAIRMENT	<b>DRUG TEST TYPE</b>
2 - SHOULDER BELT ONLY USED	13 - TRAILING UNIT	1 - NOT TRAPPED	R - THREE-WHEEL MOTORCYCLE	13 - MECHANICAL DEVICES (SPECIAL BRAKES, HAND CONTROLS, OR OTHER ADAPTIVE DEVICES)	3 - EMOTIONAL (E.G., DEPRESSED, ANGRY, DISTURBED)	1 - NONE
3 - LAP BELT ONLY USED	14 - RIDING ON VEHICLE EXTERIOR (NON-TRAILING UNIT)	2 - EXTRICATED BY MECHANICAL MEANS	S - SCHOOL BUS	14 - MILITARY VEHICLES ONLY	4 - ILLNESS	2 - BLOOD
4 - SHOULDER & LAP BELT USED	15 - NON-MOTORIST	3 - FREED BY NON-MECHANICAL MEANS	T - DOUBLE & TRIPLE TRAILERS	15 - MOTOR VEHICLES WITHOUT AIR BRAKES	5 - FELL ASLEEP, FAINTED, FATIGUED, ETC.	3 - URINE
5 - CHILD RESTRAINT SYSTEM - FORWARD FACING	99 - OTHER / UNKNOWN		X - TANKER / HAZMAT	16 - OUTSIDE MIRROR	6 - UNDER THE INFLUENCE OF MEDICATIONS / DRUGS / ALCOHOL	4 - OTHER
6 - CHILD RESTRAINT SYSTEM - REAR FACING				17 - PROSTHETIC AID	9 - OTHER / UNKNOWN	<b>DRUG TEST RESULT(S)</b>
7 - BOOSTER SEAT				18 - OTHER		1 - AMPHETAMINES
8 - HELMET USED						2 - BARBITURATES
9 - PROTECTIVE PADS USED (ELBOW, KNEES, ETC.)						3 - BENZODIAZEPINES
10 - REFLECTIVE CLOTHING						4 - CANNABINOIDS
11 - LIGHTING - PEDESTRIAN / BICYCLE ONLY						5 - COCAINE
99 - OTHER / UNKNOWN						6 - OPIATES / OPIOIDS
						7 - OTHER
						8 - NEGATIVE RESULTS

LOCAL REPORT NUMBER LLP190506002200	REPORTING AGENCY CLEARCREEK TWP PD	DATE OF CRASH M 05   D 06   Y 2019
IN COUNTY OF WARREN	CRASH LOCATION W PEKIN RD AND BELLE TERRACE LN	
DAMAGE TO THE FENCE AT 1358 W PEKIN. PROPERTY BELONGS TO ROY MILLER 513-535-2321.		
OFFICER'S SIGNATURE <b>X</b>		BADGE NUMBER