

TRAFFIC CRASH REPORT

*DENOTES MANDATORY FIELD FOR SUPPLEMENT REPORT

LOCAL REPORT NUMBER*

| | | | | |
|--|--------------------------------|--------------------------------|------------------------|-----------------------------|
| <input checked="" type="checkbox"/> PHOTOS TAKEN | <input type="checkbox"/> OH-2 | <input type="checkbox"/> OH-3 | LOCAL INFORMATION | L P 1 9 0 5 1 6 0 0 2 3 9 9 |
| <input type="checkbox"/> SECONDARY CRASH | <input type="checkbox"/> OH-1P | <input type="checkbox"/> OTHER | REPORTING AGENCY NAME* | HIT/SKIP |
| <input type="checkbox"/> PRIVATE PROPERTY | | | CLEARCREEK TWP PD | 1 - SOLVED |
| | | | NCIC* | NUMBER OF UNITS |
| | | | 0 8 3 1 6 | 0 2 |

| | | | | |
|---------|-----------|------------------------------------|-------------------------|---------------|
| COUNTY* | LOCALITY* | LOCATION: CITY, VILLAGE, TOWNSHIP* | CRAH DATE / TIME* | CRAH SEVERITY |
| 8 3 | 3 | CLEARCREEK | 0 5 1 6 2 0 1 9 2 2 1 9 | 5 |

| | | | | | |
|------------|--------------|--------|--------------------|-----------|--------------------------|
| ROUTE TYPE | ROUTE NUMBER | PREFIX | LOCATION ROAD NAME | ROAD TYPE | LATITUDE DECIMAL DEGREES |
| S R | 7 3 | | | | 3 9 . 5 4 9 8 1 6 |

| | | | | | |
|------------|--------------|--------|---|-----------|---------------------------|
| ROUTE TYPE | ROUTE NUMBER | PREFIX | REFERENCE ROAD NAME (ROAD, MILEPOST, HOUSE #) | ROAD TYPE | LONGITUDE DECIMAL DEGREES |
| | | | RED LION-5 POINTS | R D | 8 4 . 2 1 0 3 2 0 |

| | | | | |
|-------------------------|--------------------------|------------------------------|----------------|--|
| REFERENCE POINT | DIRECTION | ROUTE TYPE | ROAD TYPE | INTERSECTION RELATED |
| 1 - INTERSECTION | 1 - NORTH | JR - INTERSTATE ROUTE(TP) | AL - ALLEY | <input checked="" type="checkbox"/> WITHIN INTERSECTION OR ON APPROACH |
| 2 - MILE POST | 2 - SOUTH | US - FEDERAL US ROUTE | AV - AVENUE | <input type="checkbox"/> WITHIN INTERCHANGE AREA |
| 3 - HOUSE # | 3 - EAST | SR - STATE ROUTE | BL - BOULEVARD | NUMBER OF APPROACHES |
| | 4 - WEST | CR - NUMBERED COUNTY ROUTE | MP - MILEPOST | 4 |
| DISTANCE FROM REFERENCE | DISTANCE UNIT OF MEASURE | TR - NUMBERED TOWNSHIP ROUTE | OV - OVAL | |
| | 1 - MILES | | PK - PARKWAY | |
| | 2 - FEET | | TE - TERRACE | |
| | 3 - YARDS | | TL - TRAIL | |
| | | | WA - WAY | |
| | | | HE - HEIGHTS | |
| | | | PL - PLACE | |

| | | | |
|---------------------------------|---|---------------------|---------------------------------------|
| LOCATION OF FIRST HARMFUL EVENT | MANNER OF CRASH COLLISION/IMPACT | DIRECTION OF TRAVEL | MEDIAN TYPE |
| 0 1 | 6 | 1 - NORTH | 1 - DIVIDED FLUSH MEDIAN (<4 FEET) |
| 1 - ON ROADWAY | 1 - NOT COLLISION BETWEEN TWO MOTOR VEHICLES IN TRANSPORT | 2 - SOUTH | 2 - DIVIDED FLUSH MEDIAN (≥4 FEET) |
| 2 - ON SHOULDER | 2 - REAR-END | 3 - EAST | 3 - DIVIDED, DEPRESSED MEDIAN |
| 3 - IN MEDIAN | 3 - HEAD-ON | 4 - WEST | 4 - DIVIDED, RAISED MEDIAN (ANY TYPE) |
| 4 - ON ROADSIDE | | | 9 - OTHER/UNKNOWN |
| 5 - ON GORE | | | |
| 6 - OUTSIDE TRAFFIC WAY | | | |
| 7 - ON RAMP | | | |
| 8 - OFF RAMP | | | |
| 9 - CROSSOVER | | | |
| 10 - DRIVEWAY/ALLEY ACCESS | | | |
| 11 - RAILWAY GRADE CROSSING | | | |
| 12 - SHARED USE PATHS OR TRAILS | | | |
| 13 - BIKE LANE | | | |
| 14 - TOLL BOOTH | | | |
| 19 - OTHER / UNKNOWN | | | |
| | 4 - REAR-TO-REAR | | |
| | 5 - BACKING | | |
| | 6 - ANGLE | | |
| | 7 - SIDESWIPE, SAME DIRECTION | | |
| | 8 - SIDESWIPE, OPPOSITE DIRECTION | | |
| | 9 - OTHER / UNKNOWN | | |

| | | | | | |
|--|---------------------------------|---|--------------------|----------------------------------|-----------------------------------|
| WORK ZONE RELATED | WORK ZONE TYPE | LOCATION OF CRASH IN WORK ZONE | CONTOUR | CONDITIONS | SURFACE |
| <input type="checkbox"/> | 1 - LANE CLOSURE | 1 - BEFORE THE 1ST WORK ZONE WARNING SIGN | 2 | 2 | 2 |
| <input type="checkbox"/> WORKERS PRESENT | 2 - LANE SHIFT/CROSSOVER | 2 - ADVANCE WARNING AREA | 1 - STRAIGHT LEVEL | 1 - DRY | 1 - CONCRETE |
| <input type="checkbox"/> LAW ENFORCEMENT PRESENT | 3 - WORK ON SHOULDER OR MEDIAN | 3 - TRANSITION AREA | 2 - STRAIGHT GRADE | 2 - WET | 2 - BLACKTOP, BITUMINOUS, ASPHALT |
| <input type="checkbox"/> ACTIVE SCHOOL ZONE | 4 - INTERMITTENT OR MOVING WORK | 4 - ACTIVITY AREA | 3 - CURVE LEVEL | 3 - SNOW | 3 - BRICK/BLOCK |
| | 5 - OTHER | 5 - TERMINATION AREA | 4 - CURVE GRADE | 4 - ICE | 4 - SLAG, GRAVEL, STONE |
| | | | 9 - OTHER/UNKNOWN | 5 - SAND, MUD, DIRT, OIL, GRAVEL | 5 - DIRT |
| | | | | 6 - WATER (STANDING, MOVING) | 9 - OTHER/UNKNOWN |
| | | | | 7 - SLUSH | |
| | | | | 9 - OTHER/UNKNOWN | |

| | |
|-------------------------------------|---------------------------------------|
| LIGHT CONDITION | WEATHER |
| 3 | 0 4 |
| 1 - DAYLIGHT | 1 - CLEAR |
| 2 - DAWN/DUSK | 2 - CLOUDY |
| 3 - DARK - LIGHTED ROADWAY | 3 - FOG, SMOG, SMOKE |
| 4 - DARK - ROADWAY NOT LIGHTED | 4 - RAIN |
| 5 - DARK - UNKNOWN ROADWAY LIGHTING | 5 - SLEET, HAIL |
| 9 - OTHER / UNKNOWN | 6 - SNOW |
| | 7 - SEVERE CROSSWINDS |
| | 8 - BLOWING SAND, SOIL, DIRT, SNOW |
| | 9 - FREEZING RAIN OR FREEZING DRIZZLE |
| | 99 - OTHER / UNKNOWN |

NARRATIVE

Unit 1 was traveling north on Red Lion 5 Points. Unit 2 was traveling east on St. Rt. 73. Unit 2 stated he had a green light and was proceeding through the intersection when he struck Unit 1. Unit 1 stated she thought she had a green light. No witnesses to determine who had the green light.

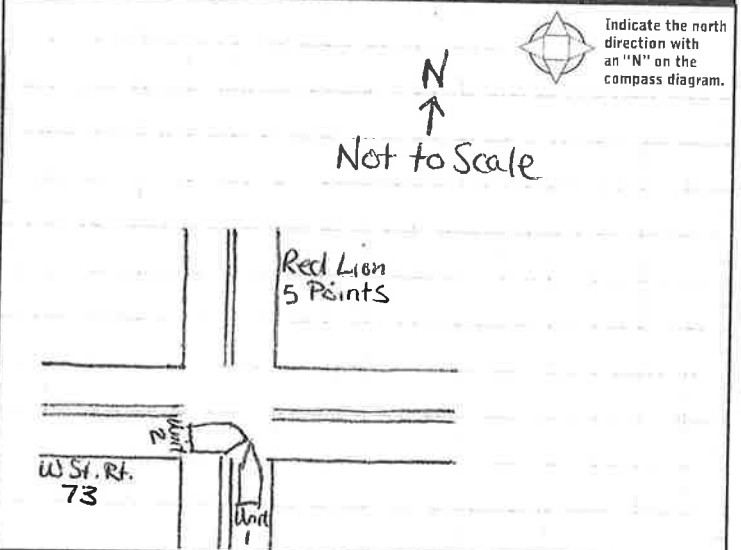

| | | | | |
|---------------------------|--------------------------|-------------------------|------------------------------------|---|
| CRAH REPORTED DATE / TIME | DISPATCH DATE / TIME | ARRIVAL DATE / TIME | SCENE CLEARED DATE / TIME | REPORT TAKEN BY |
| 0 5 1 6 2 0 1 9 2 2 1 9 | 0 5 1 6 2 0 1 9 2 2 2 0 | 0 5 1 6 2 0 1 9 2 2 2 2 | 0 5 1 6 2 0 1 9 2 2 5 3 | <input checked="" type="checkbox"/> POLICE AGENCY |
| TOTAL TIME ROADWAY CLOSED | OTHER INVESTIGATION TIME | TOTAL MINUTES | OFFICER'S NAME* | <input type="checkbox"/> MOTORIST |
| 3 0 | 6 3 | 6 3 | Stephanie Williams | <input type="checkbox"/> SUPPLEMENT (CORRECTION OR ADDITION TO ORIGINAL REPORT) |
| | | | OFFICER'S BADGE NUMBER* | |
| | | | 1 L 5 7 | |
| | | | CHECKED BY OFFICER'S NAME* | |
| | | | CPL ERIC NEY | |
| | | | CHECKED BY OFFICER'S BADGE NUMBER* | |
| | | | 1 L 2 5 | |

OWNER

UNIT # 01 **OWNER NAME:** LAST, FIRST, MIDDLE (☐ SAME AS DRIVER) Thomas, Daniel, D
OWNER ADDRESS: STREET, CITY, STATE, ZIP (☐ SAME AS DRIVER) 8322 Red Lion 5 Points
COMMERCIAL CARRIER: NAME, ADDRESS, CITY, STATE, ZIP **COMMERCIAL CARRIER PHONE:** INCLUDE AREA CODE 9377603150

LP STATE OH **LICENSE PLATE #** GTU8666 **VEHICLE IDENTIFICATION #** 1J4GL38K02W350395 **VEHICLE YEAR** 2002 **VEHICLE MAKE** Jeep
 INSURANCE VERIFIED **INSURANCE COMPANY** Safeco **INSURANCE POLICY #** K3111537 **COLOR** Green **VEHICLE MODEL** Liberty
 COMMERCIAL **GOVERNMENT** **IN EMERGENCY RESPONSE** **US DOT #** _____ **TOWED BY:** COMPANY NAME _____
 INTERLOCK DEVICE EQUIPPED **HIT/SKIP UNIT** **#OCCUPANTS** 01 **VEHICLE WEIGHT GVWR/GCWR**
 1 - <10K LBS. 2 - 10,001 - 26K LBS. 3 - >26K LBS. **HAZARDOUS MATERIAL**
 MATERIAL RELEASED **CLASS #** **PLACARD ID #**

VEHICLE

UNIT TYPE 03
 1 - PASSENGER CAR 7 - MOTORCYCLE 2-WHEELED 12 - GOLF CART 18 - LIMO (LIVERY VEHICLE) 23 - PEDESTRIAN / SKATER
 2 - PASSENGER VAN (MINIVAN) 8 - MOTORCYCLE 3-WHEELED 13 - SNOWMOBILE 19 - BUS (16+ PASSENGERS) 24 - WHEELCHAIR (ANY TYPE)
 3 - SPORT UTILITY VEHICLE 9 - AUTOCYCLE 14 - SINGLE UNIT TRUCK 20 - OTHER VEHICLE 25 - OTHER NON-MOTORIST
 4 - PICK UP 10 - MOPED OR MOTORIZED BICYCLE 15 - SEMI-TRACTOR 21 - HEAVY EQUIPMENT 26 - BICYCLE
 5 - CARGO VAN 11 - ALL TERRAIN VEHICLE (ATV / UTV) 16 - FARM EQUIPMENT 22 - ANIMAL WITH RIDER OR ANIMAL-DRAWN VEHICLE 27 - TRAIN
 6 - VAN (9-15 SEATS) 17 - MOTORHOME 99 - UNKNOWN OR HIT/SKIP
OF TRAILING UNITS _____

WAS VEHICLE OPERATING IN AUTONOMOUS MODE WHEN CRASH OCCURRED? 2
 1 - YES 2 - NO 9 - OTHER / UNKNOWN **AUTONOMOUS MODE LEVEL**
 0 - NO AUTOMATION 1 - DRIVER ASSISTANCE 3 - CONDITIONAL AUTOMATION 9 - UNKNOWN
 1 - PARTIAL AUTOMATION 2 - PARTIAL AUTOMATION 4 - HIGH AUTOMATION 5 - FULL AUTOMATION

SPECIAL FUNCTION 01
 1 - NONE 6 - BUS - CHARTER/TOUR 11 - FIRE 16 - FARM 21 - MAIL CARRIER
 2 - TAXI 7 - BUS - INTERCITY 12 - MILITARY 17 - MOWING 99 - OTHER / UNKNOWN
 3 - ELECTRONIC RIDE SHARING 8 - BUS - SHUTTLE 13 - POLICE 18 - SNOW REMOVAL
 4 - SCHOOL TRANSPORT 9 - BUS - OTHER 14 - PUBLIC UTILITY 19 - TOWING
 5 - BUS - TRANSIT/COMMUTER 10 - AMBULANCE 15 - CONSTRUCTION EQUIPMENT 20 - SAFETY SERVICE PATROL

CARGO BODY TYPE 01
 1 - NO CARGO BODY TYPE / NOT APPLICABLE 3 - VEHICLE TOWING ANOTHER MOTOR VEHICLE 5 - INTERMODAL CONTAINER CHASSIS 8 - POLE 12 - CONCRETE MIXER
 2 - BUS 4 - LOGGING 6 - CARGO VAN/ENCLOSED BOX 9 - CARGO TANK 13 - AUTO TRANSPORTER
 7 - GRAIN/CHIPS/GRAVEL 11 - DUMP 10 - FLAT BED 14 - GARBAGE/REFUSE 99 - OTHER / UNKNOWN

VEHICLE DEFECTS
 1 - TURN SIGNALS 4 - BRAKES 7 - WORN OR SLICK TIRES 9 - MOTOR TROUBLE 99 - OTHER / UNKNOWN
 2 - HEAD LAMPS 5 - STEERING 8 - TRAILER EQUIPMENT DEFECTIVE 10 - DISABLED FROM PRIOR ACCIDENT
 3 - TAIL LAMPS 6 - TIRE BLOWOUT

NON-MOTORIST LOCATION AT IMPACT
 1 - INTERSECTION - MARKED CROSSWALK 3 - INTERSECTION - OTHER 6 - BICYCLE LANE 9 - MEDIAN/CROSSING ISLAND 12 - FIRST RESPONDER AT INCIDENT SCENE
 2 - INTERSECTION - UN-MARKED CROSSWALK 4 - MIDBLOCK - MARKED CROSSWALK 7 - SHOULDER / ROADSIDE 10 - DRIVEWAY ACCESS 15 - VEHICLE NOT AT SCENE DIAGRAM
 5 - TRAVEL LANE - OTHER LOCATION 8 - SIDEWALK 11 - SHARED USE PATHS OR TRAILS 99 - OTHER / UNKNOWN

ACTION 4 **PRE-CRASH ACTIONS** 01
 1 - NON-CONTACT 2 - NON-COLLISION 3 - STRIKING 4 - STRUCK & STRUCK 5 - BOTH STRIKING & STRUCK 9 - OTHER / UNKNOWN
 1 - STRAIGHT AHEAD 2 - BACKING 3 - CHANGING LANES 4 - OVERTAKING/PASSING 5 - MAKING RIGHT TURN 6 - MAKING LEFT TURN
 7 - MAKING U-TURN 8 - ENTERING TRAFFIC LANE 9 - LEAVING TRAFFIC LANE 10 - PARKED 11 - SLOWING OR STOPPED IN TRAFFIC 12 - DRIVERLESS
 13 - NEGOTIATING A CURVE 14 - ENTERING OR CROSSING SPECIFIED LOCATION 15 - WALKING, RUNNING, JOGGING, PLAYING 16 - WORKING 17 - PUSHING VEHICLE 18 - APPROACHING OR LEAVING VEHICLE 19 - STANDING 20 - OTHER NON-MOTORIST 21 - STANDING OUTSIDE DISABLED VEHICLE 99 - OTHER / UNKNOWN

CONTRIBUTING CIRCUMSTANCES 22
 1 - NONE 2 - FAILURE TO YIELD 3 - RAN RED LIGHT 4 - RAN STOP SIGN 5 - UNSAFE SPEED 6 - IMPROPER TURN
 7 - LEFT OF CENTER 8 - FOLLOWING TOO CLOSE / ACDA 9 - IMPROPER LANE CHANGE 10 - IMPROPER PASSING 11 - DROVE OFF ROAD 12 - IMPROPER BACKING
 13 - IMPROPER START FROM A PARKED POSITION 14 - STOPPED OR PARKED ILLEGALLY 15 - SWERVING TO AVOID 16 - WRONG WAY 17 - VISION OBSTRUCTION 18 - OPERATING DEFECTIVE EQUIPMENT 19 - LOAD SHIFTING/FALLING/SPILLING 20 - IMPROPER CROSSING 21 - LYING IN ROADWAY 22 - NOT DISCERNIBLE 23 - OPENING DOOR INTO ROADWAY 99 - OTHER IMPROPER ACTION

SEQUENCE OF EVENTS 20
 1 - OVERTURN/ROLL OVER 2 - FIRE/EXPLOSION 3 - IMMERSION 4 - JACKKNIFE 5 - CARGO / EQUIPMENT LOSS OR SHIFT
 6 - EQUIPMENT FAILURE 7 - SEPARATION OF UNITS 8 - RAN OFF ROAD RIGHT 9 - RAN OFF ROAD LEFT 10 - CROSS MEDIAN
NON-COLLISION
 11 - CROSS CENTERLINE - OPPOSITE DIRECTION OF TRAVEL 12 - DOWNHILL RUNAWAY 13 - OTHER NON-COLLISION 14 - PEDESTRIAN 15 - PEDALCYCLE 16 - RAILWAY VEHICLE 17 - ANIMAL - FARM 18 - ANIMAL - DEER 19 - ANIMAL - OTHER 20 - MOTOR VEHICLE IN TRANSPORT 21 - PARKED MOTOR VEHICLE 22 - WORK ZONE MAINTENANCE EQUIPMENT 23 - STRUCK BY FALLING, SHIFTING CARGO OR ANYTHING SET IN MOTION BY A MOTOR VEHICLE 24 - OTHER MOVABLE OBJECT

COLLISION WITH FIXED OBJECT - STRUCK
 25 - IMPACT ATTENUATOR / CRASH CUSHION 26 - BRIDGE OVERHEAD STRUCTURE 27 - BRIDGE PIER OR ABUTMENT 28 - BRIDGE PARAPET 29 - BRIDGE RAIL 30 - GUARDRAIL FACE 31 - GUARDRAIL END 32 - PORTABLE BARRIER 33 - MEDIAN CABLE BARRIER 34 - MEDIAN GUARDRAIL BARRIER 35 - MEDIAN CONCRETE BARRIER 36 - MEDIAN OTHER BARRIER 37 - TRAFFIC SIGN POST 38 - OVERHEAD SIGN POST 39 - LIGHT / LUMINARIES SUPPORT 40 - UTILITY POLE 41 - OTHER POST, POLE OR SUPPORT 42 - CULVERT 43 - CURB 44 - DITCH 45 - EMBANKMENT 46 - FENCE 47 - MAILBOX 48 - TREE 49 - FIRE HYDRANT 50 - WORK ZONE MAINTENANCE EQUIPMENT 51 - WALL 52 - BUILDING 53 - TUNNEL 54 - OTHER FIXED OBJECT 99 - OTHER / UNKNOWN

FIRST HARMFUL EVENT 1 **MOST HARMFUL EVENT** 1

LOCAL REPORT NUMBER
 L P 1 9 0 5 1 6 0 0 2 3 9 9

DAMAGE

DAMAGE SCALE
 3 1 - NONE 2 - MINOR DAMAGE 3 - FUNCTIONAL DAMAGE 4 - DISABLING DAMAGE 9 - UNKNOWN

DAMAGED AREA(S)
 INDICATE ALL THAT APPLY

- NO DAMAGE [0] - UNDERCARRIAGE [14]
 - TOP [13] - ALL AREAS [15]
 - UNIT NOT AT SCENE [16]

INITIAL POINT OF CONTACT
 0 - NO DAMAGE 1 - 12 - REFER TO UNIT DIAGRAM 14 - UNDERCARRIAGE 15 - VEHICLE NOT AT SCENE 99 - UNKNOWN
 1 1 13 - TOP

TRAFFIC

TRAFFICWAY FLOW 2
 1 - ONE-WAY 2 - TWO-WAY

TRAFFIC CONTROL 2
 1 - ROUNDABOUT 2 - SIGNAL 3 - FLASHER 4 - STOP SIGN 5 - YIELD SIGN 6 - NO CONTROL

OF THROUGH LANES ON ROAD 2

RAIL GRADE CROSSING
 1 - NOT INVOLVED 2 - INVOLVED-ACTIVE CROSSING 3 - INVOLVED-PASSIVE CROSSING

UNIT / NON-MOTORIST DIRECTION
 FROM 2 TO 1
 1 - NORTH 2 - SOUTH 3 - EAST 4 - WEST 5 - NORTHEAST 6 - NORTHWEST 7 - SOUTHEAST 8 - SOUTHWEST 9 - OTHER / UNKNOWN

UNIT SPEED 5

POSTED SPEED 4 5

DETECTED SPEED 1
 1 - STATED / ESTIMATED SPEED 2 - CALCULATED / EDR 3 - UNDETERMINED

OWNER

UNIT # 02 **OWNER NAME:** LAST, FIRST, MIDDLE (☐ SAME AS DRIVER)
 Balgac, Robert

OWNER ADDRESS: STREET, CITY, STATE, ZIP (☐ SAME AS DRIVER)
 8387 Turning Leaf Xing

COMMERCIAL CARRIER: NAME, ADDRESS, CITY, STATE, ZIP

OWNER PHONE: INC. UDE AREA CODE (☐ SAME AS DRIVER)
 9044951646

COMMERCIAL CARRIER PHONE: INC. UDE AREA CODE

LP STATE OH **LICENSE PLATE #** GTW8018 **VEHICLE IDENTIFICATION #** 5N1DR2MM3HC674990 **VEHICLE YEAR** 2017 **VEHICLE MAKE** Nissan

INSURANCE VERIFIED **INSURANCE COMPANY** Geico **INSURANCE POLICY #** 4112819802 **COLOR** White **VEHICLE MODEL** Pathfinder

COMMERCIAL **GOVERNMENT** **IN EMERGENCY RESPONSE** **US DOT #**

INTERLOCK DEVICE EQUIPPED **HIT/SKIP UNIT** **#OCCUPANTS** 01 **VEHICLE WEIGHT GVWR/GCWR**
 1 - ≤10K LBS.
 2 - 10,001 - 26K LBS.
 3 - >26K LBS.

TOWED BY: COMPANY NAME
 Sandy's

MATERIAL RELEASED **HAZARDOUS MATERIAL CLASS #** **PLACARD ID #**
 PLACARD

UNIT TYPE 03

| | | | | |
|-----------------------------|--------------------------------------|------------------------|--|----------------------------|
| 1 - PASSENGER CAR | 7 - MOTORCYCLE 2-WHEELED | 12 - GOLF CART | 18 - LIMO (LIVERY VEHICLE) | 23 - PEDESTRIAN / SKATER |
| 2 - PASSENGER VAN (MINIVAN) | 8 - MOTORCYCLE 3-WHEELED | 13 - SNOWMOBILE | 19 - BUS (16+ PASSENGERS) | 24 - WHEELCHAIR (ANY TYPE) |
| 3 - SPORT UTILITY VEHICLE | 9 - AUTOCYCLE | 14 - SINGLE UNIT TRUCK | 20 - OTHER VEHICLE | 25 - OTHER NON-MOTORIST |
| 4 - PICK UP | 10 - MOPED OR MOTORIZED BICYCLE | 15 - SEMI-TRACTOR | 21 - HEAVY EQUIPMENT | 26 - BICYCLE |
| 5 - CARGO VAN | 11 - ALL TERRAIN VEHICLE (ATV / UTV) | 16 - FARM EQUIPMENT | 22 - ANIMAL WITH RIDER OR ANIMAL-DRAWN VEHICLE | 99 - UNKNOWN OR HIT/SKIP |
| 6 - VAN (9-15 SEATS) | | 17 - MOTORHOME | | |

of TRAILING UNITS

WAS VEHICLE OPERATING IN AUTONOMOUS MODE WHEN CRASH OCCURRED? 2

1 - YES 2 - NO 9 - OTHER / UNKNOWN

AUTONOMOUS MODE LEVEL

0 - NO AUTOMATION
 1 - DRIVER ASSISTANCE
 2 - PARTIAL AUTOMATION
 3 - CONDITIONAL AUTOMATION
 4 - HIGH AUTOMATION
 5 - FULL AUTOMATION
 9 - UNKNOWN

SPECIAL FUNCTION 01

| | | | | |
|-----------------------------|------------------------|-----------------------------|----------------------------|----------------------|
| 1 - NONE | 6 - BUS - CHARTER/TOUR | 11 - FIRE | 16 - FARM | 21 - MAIL CARRIER |
| 2 - TAXI | 7 - BUS - INTERCITY | 12 - MILITARY | 17 - MOWING | 99 - OTHER / UNKNOWN |
| 3 - ELECTRONIC RIDE SHARING | 8 - BUS - SHUTTLE | 13 - POLICE | 18 - SNOW REMOVAL | |
| 4 - SCHOOL TRANSPORT | 9 - BUS - OTHER | 14 - PUBLIC UTILITY | 19 - TOWING | |
| 5 - BUS - TRANSIT/COMMUTER | 10 - AMBULANCE | 15 - CONSTRUCTION EQUIPMENT | 20 - SAFETY SERVICE PATROL | |

CARGO BODY TYPE 01

| | | | | |
|---|--|----------------------------------|----------------|-----------------------|
| 1 - NO CARGO BODY TYPE / NOT APPLICABLE | 3 - VEHICLE TOWING ANOTHER MOTOR VEHICLE | 5 - INTERMODAL CONTAINER CHASSIS | 8 - POLE | 12 - CONCRETE MIXER |
| 2 - BUS | 4 - LOGGING | 6 - CARGO VAN/ENCLOSED BOX | 9 - CARGO TANK | 13 - AUTO TRANSPORTER |
| | | 7 - GRAIN/CHIPS/GRAVEL | 10 - FLAT BED | 14 - GARBAGE/REFUSE |
| | | | 11 - DUMP | 99 - OTHER / UNKNOWN |

VEHICLE DEFECTS

| | | | | |
|------------------|------------------|---------------------------------|-----------------------------------|----------------------|
| 1 - TURN SIGNALS | 4 - BRAKES | 7 - WORN OR SLICK TIRES | 9 - MOTOR TROUBLE | 99 - OTHER / UNKNOWN |
| 2 - HEAD LAMPS | 5 - STEERING | 8 - TRAILER EQUIPMENT DEFECTIVE | 10 - DISABLED FROM PRIOR ACCIDENT | |
| 3 - TAIL LAMPS | 6 - TIRE BLOWOUT | | | |

NON-MOTORIST LOCATION AT IMPACT

| | | | | |
|---------------------------------------|----------------------------------|-------------------------|---------------------------------|--|
| 1 - INTERSECTION - MARKED CROSSWALK | 3 - INTERSECTION - OTHER | 6 - BICYCLE LANE | 9 - MEDIUM CROSSING ISLAND | 12 - FIRST RESPONDER AT INCIDENT SCENE |
| 2 - INTERSECTION - UNMARKED CROSSWALK | 4 - MIDLICK - MARKED CROSSWALK | 7 - SHOULDER / ROADSIDE | 10 - DRIVEWAY ACCESS | 99 - OTHER / UNKNOWN |
| | 5 - TRAVEL LANE - OTHER LOCATION | 8 - SIDEWALK | 11 - SHARED USE PATHS OR TRAILS | |

ACTION 3

| | | | | |
|----------------------------|------------------------|------------------------------------|--|--|
| 1 - NON-CONTACT | 1 - STRAIGHT AHEAD | 7 - MAKING U-TURN | 13 - NEGOTIATING A CURVE OR LEAVING VEHICLE | 18 - APPROACHING OR LEAVING VEHICLE |
| 2 - NON-COLLISION | 2 - BACKING | 8 - ENTERING TRAFFIC LANE | 14 - ENTERING OR CROSSING SPECIFIED LOCATION | 19 - STANDING |
| 3 - STRIKING | 3 - CHANGING LANES | 9 - LEAVING TRAFFIC LANE | 15 - WALKING, RUNNING, JOGGING, PLAYING | 20 - OTHER NON-MOTORIST |
| 4 - STRUCK | 4 - OVERTAKING/PASSING | 10 - PARKED | 16 - WORKING | 21 - STANDING OUTSIDE DISABLED VEHICLE |
| 5 - BOTH STRIKING & STRUCK | 5 - MAKING RIGHT TURN | 11 - SLOWING OR STOPPED IN TRAFFIC | 17 - PUSHING VEHICLE | 99 - OTHER / UNKNOWN |
| 9 - OTHER / UNKNOWN | 6 - MAKING LEFT TURN | 12 - DRIVERLESS | | |

PRE-CRASH ACTIONS 01

CONTRIBUTING CIRCUMSTANCES 22

| | | | | |
|----------------------|--------------------------------|--|--------------------------------------|--------------------------------|
| 1 - NONE | 7 - LEFT OF CENTER | 13 - IMPROPER START FROM A PARKED POSITION | 17 - VISION OBSTRUCTION | 21 - LYING IN ROADWAY |
| 2 - FAILURE TO YIELD | 8 - FOLLOWING TOO CLOSE / ACDA | 14 - STOPPED OR PARKED ILLEGALLY | 18 - OPERATING DEFECTIVE EQUIPMENT | 22 - NOT DISCERNIBLE |
| 3 - RAN RED LIGHT | 9 - IMPROPER LANE CHANGE | 15 - SWERVING TO AVOID | 19 - LOAD SHIFTING/FALLING/ SPILLING | 23 - OPENING DOOR INTO ROADWAY |
| 4 - RAN STOP SIGN | 10 - IMPROPER PASSING | 16 - WRONG WAY | 20 - IMPROPER CROSSING | 99 - OTHER IMPROPER ACTION |
| 5 - UNSAFE SPEED | 11 - DROVE OFF ROAD | | | |
| 6 - IMPROPER TURN | 12 - IMPROPER BACKING | | | |

SEQUENCE OF EVENTS

1 2 0

| | | | | |
|-------------------------------------|-------------------------|--|---------------------------------|---|
| 1 - OVERTURN/ROLLOVER | 6 - EQUIPMENT FAILURE | 11 - CROSS CENTERLINE - OPPOSITE DIRECTION OF TRAVEL | 16 - RAILWAY VEHICLE | 22 - WORK ZONE MAINTENANCE EQUIPMENT |
| 2 - FIRE/EXPLOSION | 7 - SEPARATION OF UNITS | 12 - DOWNHILL RUNAWAY | 17 - ANIMAL - FARM | 23 - STRUCK BY FALLING, SHIFTING CARGO OR ANYTHING SET IN MOTION BY A MOTOR VEHICLE |
| 3 - IMMERSION | 8 - RAN OFF ROAD RIGHT | 13 - OTHER NON-COLLISION | 18 - ANIMAL - DEER | 24 - OTHER MOVABLE OBJECT |
| 4 - JACKKNIFE | 9 - RAN OFF ROAD LEFT | 14 - PEDESTRIAN | 19 - ANIMAL - OTHER | |
| 5 - CARGO / EQUIPMENT LOSS OR SHIFT | 10 - CROSS MEDIAN | 15 - PEDALCYCLE | 20 - MOTOR VEHICLE IN TRANSPORT | |

COLLISION WITH FIXED OBJECT - STRUCK

| | | | | |
|--|-------------------------------|----------------------------------|-------------------|--------------------------------------|
| 25 - IMPACT ATTENUATOR / CRASH CUSHION | 31 - GUARDRAIL END | 37 - TRAFFIC SIGN POST | 43 - CURB | 50 - WORK ZONE MAINTENANCE EQUIPMENT |
| 26 - BRIDGE OVERHEAD STRUCTURE | 32 - PORTABLE BARRIER | 38 - OVERHEAD SIGN POST | 44 - DITCH | 51 - WALL |
| 27 - BRIDGE PIER OR ABUTMENT | 33 - MEDIAN CABLE BARRIER | 39 - LIGHT / LUMINARIES SUPPORT | 45 - EMBANKMENT | 52 - BUILDING |
| 28 - BRIDGE PARAPET | 34 - MEDIAN GUARDRAIL BARRIER | 40 - UTILITY POLE | 46 - FENCE | 53 - TUNNEL |
| 29 - BRIDGE RAIL | 35 - MEDIAN CONCRETE BARRIER | 41 - OTHER POST, POLE OR SUPPORT | 47 - MAILBOX | 54 - OTHER FIXED OBJECT |
| 30 - GUARDRAIL FACE | 36 - MEDIAN OTHER BARRIER | 42 - CULVERT | 48 - TREE | 99 - OTHER / UNKNOWN |
| | | | 49 - FIRE HYDRANT | |

FIRST HARMFUL EVENT 1 **MOST HARMFUL EVENT** 1

LOCAL REPORT NUMBER

L P 1 9 0 5 1 6 0 0 2 3 9 9

DAMAGE

DAMAGE SCALE

4 1 - NONE 3 - FUNCTIONAL DAMAGE
 2 - MINOR DAMAGE 4 - DISABLING DAMAGE
 9 - UNKNOWN

DAMAGED AREA(S)
 INDICATE ALL THAT APPLY

NO DAMAGE [0] **UNDERCARRIAGE** [14]
 TOP [13] **ALL AREAS** [15]
 UNIT NOT AT SCENE [16]

INITIAL POINT OF CONTACT

0 - NO DAMAGE 14 - UNDERCARRIAGE
 1 - 12 - REFER TO UNIT DIAGRAM 15 - VEHICLE NOT AT SCENE
 13 - TOP 99 - UNKNOWN

EVENT(S)

TRAFFICWAY FLOW 2

1 - ONE-WAY
 2 - TWO-WAY

TRAFFIC CONTROL 2

1 - ROUNDABOUT 4 - STOP SIGN
 2 - SIGNAL 5 - YIELD SIGN
 3 - FLASHER 6 - NO CONTROL

OF THROUGH LANES ON ROAD 2

RAIL GRADE CROSSING

1 - NOT INVOLVED
 2 - INVOLVED-ACTIVE CROSSING
 3 - INVOLVED-PASSIVE CROSSING

UNIT / NON-MOTORIST DIRECTION

FROM 4 TO 3

1 - NORTH 5 - NORTHEAST
 2 - SOUTH 6 - NORTHWEST
 3 - EAST 7 - SOUTHEAST
 4 - WEST 8 - SOUTHWEST
 9 - OTHER / UNKNOWN

UNIT SPEED 45

DETECTED SPEED 1

1 - STATED / ESTIMATED SPEED
 2 - CALCULATED / EDR
 3 - UNDETERMINED

POSTED SPEED 50



MOTORIST / Non-MOTORIST

LOCAL REPORT NUMBER
L P 1 9 0 5 1 6 0 0 2 3 9 9

| | | | | | | | | | | |
|--|--|-----------------------------------|--|---|--|--------------------------------|---|----------------------|---|--|
| UNIT # 0 1 | NAME: LAST, FIRST, MIDDLE Thomas, Lauren | | DATE OF BIRTH 0 2 / 2 9 / 2 0 0 0 | | AGE 1 9 | GENDER F | | | | |
| ADDRESS: STREET, CITY, STATE, ZIP 8322 Red Lion 5 Points | | | | CONTACT PHONE - INCLUDE AREA CODE 9 3 7 7 6 0 3 1 5 0 | | | | | | |
| INJURIES 5 | INJURED TAKEN BY | EMS AGENCY (NAME) | INJURED TAKEN TO: MEDICAL FACILITY (NAME, CITY) | SAFETY EQUIPMENT USED 4 | <input type="checkbox"/> DOT-COMPLIANT MC HELMET | SEATING POSITION 0 1 | AIR BAG USAGE 1 | EJECTION 1 | TRAPPED 1 | |
| OL STATE O H | OPERATOR LICENSE NUMBER UN481999 | | OFFENSE CHARGED | LOCAL CODE <input type="checkbox"/> | OFFENSE DESCRIPTION | | CITATION NUMBER | | | |
| OL CLASS 4 | ENDORSEMENT SELECT UP TO 2 | RESTRICTION SELECT UP TO 3 | DRIVER DISTRACTED BY 1 | ALCOHOL / DRUG SUSPECTED <input type="checkbox"/> ALCOHOL <input type="checkbox"/> MARIJUANA <input type="checkbox"/> OTHER DRUG | | CONDITION 1 | ALCOHOL TEST STATUS TYPE VALUE 1 1 | | DRUG TEST(S) STATUS TYPE RESULT SELECT UP TO 4 1 1 | |

| | | | | | | | | | | |
|--|--|--|--|---|--|--------------------------------|---|----------------------|---|--|
| UNIT # 0 2 | NAME: LAST, FIRST, MIDDLE Balgac, Robert | | DATE OF BIRTH 0 3 / 3 0 / 1 9 7 6 | | AGE 4 3 | GENDER M | | | | |
| ADDRESS: STREET, CITY, STATE, ZIP 8387 Turning Leaf Xing | | | | CONTACT PHONE - INCLUDE AREA CODE 9 0 7 4 9 5 1 6 4 6 | | | | | | |
| INJURIES 5 | INJURED TAKEN BY | EMS AGENCY (NAME) | INJURED TAKEN TO: MEDICAL FACILITY (NAME, CITY) | SAFETY EQUIPMENT USED 4 | <input type="checkbox"/> DOT-COMPLIANT MC HELMET | SEATING POSITION 0 1 | AIR BAG USAGE 1 | EJECTION 1 | TRAPPED 1 | |
| OL STATE O H | OPERATOR LICENSE NUMBER UP888352 | | OFFENSE CHARGED | LOCAL CODE <input type="checkbox"/> | OFFENSE DESCRIPTION | | CITATION NUMBER | | | |
| OL CLASS 4 | ENDORSEMENT SELECT UP TO 2 | RESTRICTION SELECT UP TO 3 0 3 | DRIVER DISTRACTED BY 1 | ALCOHOL / DRUG SUSPECTED <input type="checkbox"/> ALCOHOL <input type="checkbox"/> MARIJUANA <input type="checkbox"/> OTHER DRUG | | CONDITION 1 | ALCOHOL TEST STATUS TYPE VALUE 1 1 | | DRUG TEST(S) STATUS TYPE RESULT SELECT UP TO 4 1 1 | |

| | | | | | | | | | | |
|--|-----------------------------------|-----------------------------------|--|--|--|-------------------------|------------------------|-----------------|---------------------|--|
| UNIT # | NAME: LAST, FIRST, MIDDLE | | DATE OF BIRTH | | AGE | GENDER | | | | |
| ADDRESS: STREET, CITY, STATE, ZIP | | | | CONTACT PHONE - INCLUDE AREA CODE | | | | | | |
| INJURIES | INJURED TAKEN BY | EMS AGENCY (NAME) | INJURED TAKEN TO: MEDICAL FACILITY (NAME, CITY) | SAFETY EQUIPMENT USED | <input type="checkbox"/> DOT-COMPLIANT MC HELMET | SEATING POSITION | AIR BAG USAGE | EJECTION | TRAPPED | |
| OL STATE | OPERATOR LICENSE NUMBER | | OFFENSE CHARGED | LOCAL CODE | OFFENSE DESCRIPTION | | CITATION NUMBER | | | |
| OL CLASS | ENDORSEMENT SELECT UP TO 2 | RESTRICTION SELECT UP TO 3 | DRIVER DISTRACTED BY | ALCOHOL / DRUG SUSPECTED | | CONDITION | ALCOHOL TEST | | DRUG TEST(S) | |

| INJURIES | SEATING POSITION | AIR BAG | OL CLASS | OL RESTRICTION(S) | DRIVER DISTRACTION | TEST STATUS |
|---|--|---|--|---|--|--|
| 1 - FATAL 2 - SUSPECTED SERIOUS INJURY 3 - SUSPECTED MINOR INJURY 4 - POSSIBLE INJURY 5 - NO APPARENT INJURY | 1 - FRONT - LEFT SIDE (MOTORCYCLE DRIVER) 2 - FRONT - MIDDLE 3 - FRONT - RIGHT SIDE 4 - SECOND - LEFT SIDE (MOTORCYCLE PASSENGER) 5 - SECOND - MIDDLE 6 - SECOND - RIGHT SIDE 7 - THIRD - LEFT SIDE (MOTORCYCLE SIDE CAR) 8 - THIRD - MIDDLE 9 - THIRD - RIGHT SIDE 10 - SLEEPER SECTION OF TRUCK CAB | 1 - NOT DEPLOYED 2 - DEPLOYED FRONT 3 - DEPLOYED SIDE 4 - DEPLOYED BOTH FRONT / SIDE 5 - NOT APPLICABLE 9 - DEPLOYMENT UNKNOWN | 1 - CLASS A 2 - CLASS B 3 - CLASS C 4 - REGULAR CLASS (OHIO = D) 5 - M/C MOPED ONLY 6 - NO VALID OL | 1 - ALCOHOL INTERLOCK DEVICE 2 - CDL INTRASTATE ONLY 3 - CORRECTIVE LENSES 4 - FARM WAIVER 5 - EXCEPT CLASS A BUS & CLASS B BUS 7 - EXCEPT TRACTOR-TRAILER 8 - INTERMEDIATE LICENSE RESTRICTIONS 9 - LEARNER'S PERMIT RESTRICTIONS 10 - LIMITED TO DAYLIGHT ONLY 11 - LIMITED TO EMPLOYMENT 12 - LIMITED - OTHER 13 - MECHANICAL DEVICES (SPECIAL BRAKES, HAND CONTROLS, OR OTHER ADAPTIVE DEVICES) 14 - MILITARY VEHICLES ONLY 15 - MOTOR VEHICLES WITHOUT AIR BRAKES 16 - OUTSIDE MIRROR 17 - PROSTHETIC AID 18 - OTHER | 1 - NOT DISTRACTED 2 - MANUALLY OPERATING AN ELECTRONIC COMMUNICATION DEVICE (TEXTING, TYPING, DIALING) 3 - TALKING ON HANDS-FREE COMMUNICATION DEVICE 4 - TALKING ON HAND-HELD COMMUNICATION DEVICE 5 - OTHER ACTIVITY WITH AN ELECTRONIC DEVICE 6 - PASSENGER 7 - OTHER DISTRACTION INSIDE THE VEHICLE 8 - OTHER DISTRACTION OUTSIDE THE VEHICLE 9 - OTHER / UNKNOWN | 1 - NONE GIVEN 2 - TEST REFUSED 3 - TEST GIVEN, CONTAMINATED SAMPLE / UNUSABLE 4 - TEST GIVEN, RESULTS KNOWN 5 - TEST GIVEN, RESULTS UNKNOWN |
| INJURED TAKEN BY 1 - NOT TRANSPORTED / TREATED AT SCENE 2 - EMS 3 - POLICE 9 - OTHER / UNKNOWN | | EJECTION 1 - NOT EJECTED 2 - PARTIALLY EJECTED 3 - TOTALLY EJECTED 4 - NOT APPLICABLE | OL ENDORSEMENT H - HAZMAT M - MOTORCYCLE P - PASSENGER N - TANKER Q - MOTOR SCOOTER R - THREE-WHEEL MOTORCYCLE S - SCHOOL BUS T - DOUBLE & TRIPLE TRAILERS X - TANKER / HAZMAT | | CONDITION 1 - APPARENTLY NORMAL 2 - PHYSICAL IMPAIRMENT 3 - EMOTIONAL (E.G. DEPRESSED, ANGRY, DISTURBED) 4 - ILLNESS 5 - FELL ASLEEP, FAINTED, FATIGUED, ETC. 6 - UNDER THE INFLUENCE OF MEDICATIONS / DRUGS / ALCOHOL 9 - OTHER / UNKNOWN | ALCOHOL TEST TYPE 1 - NONE 2 - BLOOD 3 - URINE 4 - BREATH 5 - OTHER |
| SAFETY EQUIPMENT 1 - NONE USED 2 - SHOULDER BELT ONLY USED 3 - LAP BELT ONLY USED 4 - SHOULDER & LAP BELT USED 5 - CHILD RESTRAINT SYSTEM - FORWARD FACING 6 - CHILD RESTRAINT SYSTEM - REAR FACING 7 - BOOSTER SEAT 8 - HELMET USED 9 - PROTECTIVE PADS USED (ELBOW, KNEES, ETC.) 10 - REFLECTIVE CLOTHING 11 - LIGHTING - PEDESTRIAN / BICYCLE ONLY 99 - OTHER / UNKNOWN | 11 - PASSENGER IN OTHER ENCLOSED CARGO AREA (NON-TRAILING UNIT, BUS, PICK-UP WITH CAP) 12 - PASSENGER IN UNENCLOSED CARGO AREA 13 - TRAILING UNIT 14 - RIDING ON VEHICLE EXTERIOR (NON-TRAILING UNIT) 15 - NON-MOTORIST 99 - OTHER / UNKNOWN | TRAPPED 1 - NOT TRAPPED 2 - EXTRICATED BY MECHANICAL MEANS 3 - FREED BY NON-MECHANICAL MEANS | | | | DRUG TEST TYPE 1 - NONE 2 - BLOOD 3 - URINE 4 - OTHER |
| | | | | | | DRUG TEST RESULT(S) 1 - AMPHETAMINES 2 - BARBITURATES 3 - BENZODIAZEPINES 4 - CANNABINOIDS 5 - COCAINE 6 - OPIATES / OPIOIDS 7 - OTHER 8 - NEGATIVE RESULTS |