

TRAFFIC CRASH REPORT

*DENOTES MANDATORY FIELD FOR SUPPLEMENT REPORT

LOCAL REPORT NUMBER*

<input type="checkbox"/> PHOTOS TAKEN <input type="checkbox"/> SECONDARY CRASH <input type="checkbox"/> PRIVATE PROPERTY		<input type="checkbox"/> OH-2 <input checked="" type="checkbox"/> OH-1P <input type="checkbox"/> OTHER	<input checked="" type="checkbox"/> OH-3 <input type="checkbox"/> OTHER	LOCAL INFORMATION REPORTING AGENCY NAME* CLEARCREEK TOWNSHIP POLICE		NCIC* 0, 8, 3, 1, 6		LOCAL REPORT NUMBER* L P 1 9 0 6 0 1 0 0 2 7 1 0	
COUNTY* 8, 3	LOCALITY* 1 - CITY 2 - VILLAGE 3 - TOWNSHIP 3	LOCATION: CITY, VILLAGE, TOWNSHIP* CLEARCREEK		CRASH DATE / TIME* 06012019 1650		NUMBER OF UNITS 0, 2		UNIT IN ERROR 98 - ANIMAL 99 - UNKNOWN 0, 1	
ROUTE TYPE <input type="checkbox"/> 1 - NORTH <input type="checkbox"/> 2 - SOUTH <input type="checkbox"/> 3 - EAST <input type="checkbox"/> 4 - WEST		LOCATION ROAD NAME BUNNELL HILL		ROAD TYPE R, D		LATITUDE DECIMAL DEGREES 39.559258		CRASH SEVERITY 1 - FATAL 2 - SERIOUS INJURY SUSPECTED 3 - MINOR INJURY SUSPECTED 4 - INJURY POSSIBLE 5 - PROPERTY DAMAGE ONLY 5	
ROUTE TYPE <input type="checkbox"/> 1 - NORTH <input type="checkbox"/> 2 - SOUTH <input type="checkbox"/> 3 - EAST <input type="checkbox"/> 4 - WEST		REFERENCE ROAD NAME (ROAD, MILEPOST, HOUSE #) 8346		ROAD TYPE <input type="checkbox"/> 1 - NORTH <input type="checkbox"/> 2 - SOUTH <input type="checkbox"/> 3 - EAST <input type="checkbox"/> 4 - WEST		LONGITUDE DECIMAL DEGREES -84.193982			
REFERENCE POINT 1 - INTERSECTION 2 - MILE POST 3 - HOUSE # 3		DIRECTION FROM REFERENCE 1 - NORTH 2 - SOUTH 3 - EAST 4 - WEST		ROUTE TYPE IR - INTERSTATE ROUTE (TP) US - FEDERAL US ROUTE SR - STATE ROUTE CR - NUMBERED COUNTY ROUTE TR - NUMBERED TOWNSHIP ROUTE		ROAD TYPE AL - ALLEY AV - AVENUE BL - BOULEVARD CR - CIRCLE CT - COURT DR - DRIVE HE - HEIGHTS		HW - HIGHWAY LA - LANE MP - MILEPOST OV - OVAL PK - PARKWAY PI - PIKE PL - PLACE	
DISTANCE FROM REFERENCE <input type="checkbox"/> 1 - MILES <input type="checkbox"/> 2 - FEET <input type="checkbox"/> 3 - YARDS		INTERSECTION RELATED <input type="checkbox"/> WITHIN INTERSECTION OR ON APPROACH <input type="checkbox"/> WITHIN INTERCHANGE AREA		NUMBER OF APPROACHES <input type="checkbox"/>		ROADWAY <input type="checkbox"/> ROADWAY DIVIDED			
LOCATION OF FIRST HARMFUL EVENT 1 - ON ROADWAY 2 - ON SHOULDER 3 - IN MEDIAN 4 - ON ROADSIDE 5 - ON GORE 6 - OUTSIDE TRAFFIC WAY 7 - ON RAMP 8 - OFF RAMP		9 - CROSSOVER 10 - DRIVEWAY/ALLEY ACCESS 11 - RAILWAY GRADE CROSSING 12 - SHARED USE PATHS OR TRAILS 13 - BIKE LANE 14 - TOLL BOOTH 99 - OTHER / UNKNOWN		MANNER OF CRASH COLLISION/IMPACT 1 - NOT COLLISION BETWEEN TWO MOTOR VEHICLES IN TRANSPORT 2 - REAR-END 3 - HEAD-ON		4 - REAR-TO-REAR 5 - BACKING 6 - ANGLE 7 - SIDESWIPE, SAME DIRECTION 8 - SIDESWIPE, OPPOSITE DIRECTION 9 - OTHER / UNKNOWN		DIRECTION OF TRAVEL 1 - NORTH 2 - SOUTH 3 - EAST 4 - WEST	
<input type="checkbox"/> WORK ZONE RELATED <input type="checkbox"/> WORKERS PRESENT <input type="checkbox"/> LAW ENFORCEMENT PRESENT <input type="checkbox"/> ACTIVE SCHOOL ZONE		WORK ZONE TYPE 1 - LANE CLOSURE 2 - LANE SHIFT/CROSSOVER 3 - WORK ON SHOULDER OR MEDIAN 4 - INTERMITTENT OR MOVING WORK 5 - OTHER		LOCATION OF CRASH IN WORK ZONE 1 - BEFORE THE 1ST WORK ZONE WARNING SIGN 2 - ADVANCE WARNING AREA 3 - TRANSITION AREA 4 - ACTIVITY AREA 5 - TERMINATION AREA		CONTOUR 2 1 - STRAIGHT LEVEL 2 - STRAIGHT GRADE 3 - CURVE LEVEL 4 - CURVE GRADE 9 - OTHER/UNKNOWN		CONDITIONS 1 1 - DRY 2 - WET 3 - SNOW 4 - ICE 5 - SAND, MUD, DIRT, OIL, GRAVEL 6 - WATER (STANDING, MOVING) 7 - SLUSH 9 - OTHER/UNKNOWN	
LIGHT CONDITION 1 1 - DAYLIGHT 2 - DAWN/DUSK 3 - DARK - LIGHTED ROADWAY 4 - DARK - ROADWAY NOT LIGHTED 5 - DARK - UNKNOWN ROADWAY LIGHTING 9 - OTHER / UNKNOWN		WEATHER 0, 2 1 - CLEAR 2 - CLOUDY 3 - FOG, SMOG, SMOKE 4 - RAIN 5 - SLEET, HAIL		6 - SNOW 7 - SEVERE CROSSWINDS 8 - BLOWING SAND, SOIL, DIRT, SNOW 9 - FREEZING RAIN OR FREEZING DRIZZLE 99 - OTHER / UNKNOWN		SURFACE 2 1 - CONCRETE 2 - BLACKTOP, BITUMINOUS, ASPHALT 3 - BRICK/BLOCK 4 - SLAG, GRAVEL, STONE 5 - DIRT 9 - OTHER/UNKNOWN			

NARRATIVE

TRAFFIC UNIT #1 WAS TRAVELING SOUTH ON BUNNELL HILL ROAD AND WHEN AT ADDRESS 8346, FAILED TO STOP WITHIN ASSURED CLEAR DISTANCE AHEAD AND COLLIDED WITH THE REAR END OF TRAFFIC UNIT #2, WHICH WAS ALSO TRAVELING SOUTH. THE BRAKE LIGHTS OF TRAFFIC UNIT #2 WERE OPERATING PROPERLY.

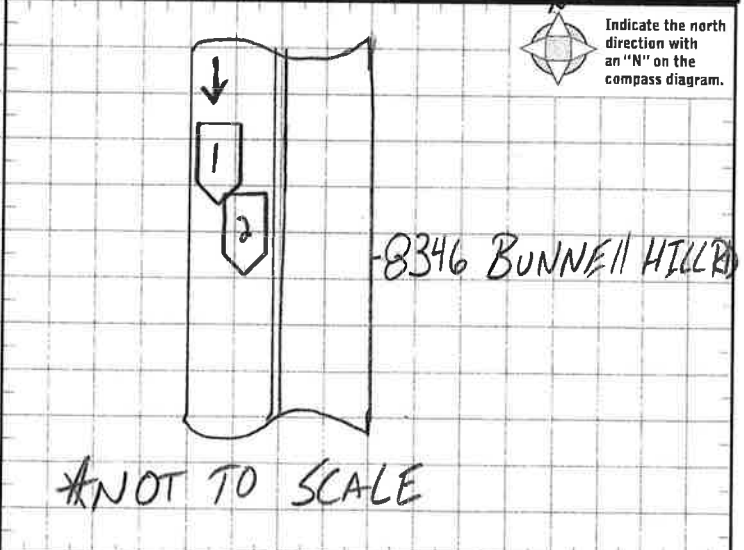

CRASH REPORTED DATE / TIME 06012019 1650		DISPATCH DATE / TIME 06012019 1650		ARRIVAL DATE / TIME 06012019 1658		SCENE CLEARED DATE / TIME 06012019 1731		REPORT TAKEN BY <input checked="" type="checkbox"/> POLICE AGENCY <input type="checkbox"/> MOTORIST	
TOTAL TIME ROADWAY CLOSED 0 6 0		OTHER INVESTIGATION TIME 1 0 1		OFFICER'S NAME* OFFICER ROACH		CHECKED BY OFFICER'S NAME* CPL E NEY		<input type="checkbox"/> SUPPLEMENT (CORRECTION OR ADDITION TO AN EXISTING REPORT SENT TO CSRS)	
		TOTAL MINUTES 1 0 1		OFFICER'S BADGE NUMBER* 1 L 3 1		CHECKED BY OFFICER'S BADGE NUMBER* 1 L 2 5			

OWNER	UNIT # 01	OWNER NAME: LAST, FIRST, MIDDLE (☐ SAME AS DRIVER)	OWNER PHONE: INCLUDE AREA CODE (☐ SAME AS DRIVER)																																	
	OWNER ADDRESS: STREET, CITY, STATE, ZIP (☐ SAME AS DRIVER)																																			
COMMERCIAL CARRIER: NAME, ADDRESS, CITY, STATE, ZIP		COMMERCIAL CARRIER PHONE: INCLUDE AREA CODE																																		
VEHICLE	LP STATE OH	LICENSE PLATE # MACC88	VEHICLE IDENTIFICATION # 5T1ELU42N46Z2109526	VEHICLE YEAR 2006	VEHICLE MAKE TOYOTA																															
	<input checked="" type="checkbox"/> INSURANCE VERIFIED	INSURANCE COMPANY ALLSTATE	INSURANCE POLICY # 992497598	COLOR RED	VEHICLE MODEL TACOMA																															
	<input type="checkbox"/> COMMERCIAL	<input type="checkbox"/> GOVERNMENT	<input type="checkbox"/> IN EMERGENCY RESPONSE	US DOT #																																
	<input type="checkbox"/> INTERLOCK DEVICE EQUIPPED	<input type="checkbox"/> HIT/SKIP UNIT	#OCCUPANTS 04	VEHICLE WEIGHT GVWR/GCWR 1 - ≤10K LBS. 2 - 10,001 - 26K LBS. 3 - >26K LBS.																																
	TYPE OF USE			TOWED BY: COMPANY NAME																																
	<input type="checkbox"/> HAZARDOUS MATERIAL			<input type="checkbox"/> MATERIAL RELEASED CLASS # <input type="checkbox"/> PLACARD PLACARD ID #																																
	UNIT TYPE																																			
	<table style="width:100%; border: none;"> <tr> <td>1 - PASSENGER CAR</td> <td>7 - MOTORCYCLE 2-WHEELED</td> <td>12 - GOLF CART</td> <td>18 - LIMO (LIVERY VEHICLE)</td> <td>23 - PEDESTRIAN / SKATER</td> </tr> <tr> <td>2 - PASSENGER VAN (MINIVAN)</td> <td>8 - MOTORCYCLE 3-WHEELED</td> <td>13 - SNOWMOBILE</td> <td>19 - BUS (16+ PASSENGERS)</td> <td>24 - WHEELCHAIR (ANY TYPE)</td> </tr> <tr> <td>3 - SPORT UTILITY VEHICLE</td> <td>9 - AUTOCYCLE</td> <td>14 - SINGLE UNIT TRUCK</td> <td>20 - OTHER VEHICLE</td> <td>25 - OTHER NON-MOTORIST</td> </tr> <tr> <td>4 - PICK UP</td> <td>10 - MOPED OR MOTORIZED BICYCLE</td> <td>15 - SEMI-TRACTOR</td> <td>21 - HEAVY EQUIPMENT</td> <td>26 - BICYCLE</td> </tr> <tr> <td>5 - CARGO VAN</td> <td>11 - ALL TERRAIN VEHICLE (ATV / UTV)</td> <td>16 - FARM EQUIPMENT</td> <td>22 - ANIMAL WITH RIDER OR ANIMAL-DRAWN VEHICLE</td> <td>27 - TRAIN</td> </tr> <tr> <td>6 - VAN (9-15 SEATS)</td> <td></td> <td>17 - MOTORHOME</td> <td></td> <td>99 - UNKNOWN OR HIT/SKIP</td> </tr> </table>						1 - PASSENGER CAR	7 - MOTORCYCLE 2-WHEELED	12 - GOLF CART	18 - LIMO (LIVERY VEHICLE)	23 - PEDESTRIAN / SKATER	2 - PASSENGER VAN (MINIVAN)	8 - MOTORCYCLE 3-WHEELED	13 - SNOWMOBILE	19 - BUS (16+ PASSENGERS)	24 - WHEELCHAIR (ANY TYPE)	3 - SPORT UTILITY VEHICLE	9 - AUTOCYCLE	14 - SINGLE UNIT TRUCK	20 - OTHER VEHICLE	25 - OTHER NON-MOTORIST	4 - PICK UP	10 - MOPED OR MOTORIZED BICYCLE	15 - SEMI-TRACTOR	21 - HEAVY EQUIPMENT	26 - BICYCLE	5 - CARGO VAN	11 - ALL TERRAIN VEHICLE (ATV / UTV)	16 - FARM EQUIPMENT	22 - ANIMAL WITH RIDER OR ANIMAL-DRAWN VEHICLE	27 - TRAIN	6 - VAN (9-15 SEATS)		17 - MOTORHOME		99 - UNKNOWN OR HIT/SKIP
	1 - PASSENGER CAR	7 - MOTORCYCLE 2-WHEELED	12 - GOLF CART	18 - LIMO (LIVERY VEHICLE)	23 - PEDESTRIAN / SKATER																															
	2 - PASSENGER VAN (MINIVAN)	8 - MOTORCYCLE 3-WHEELED	13 - SNOWMOBILE	19 - BUS (16+ PASSENGERS)	24 - WHEELCHAIR (ANY TYPE)																															
3 - SPORT UTILITY VEHICLE	9 - AUTOCYCLE	14 - SINGLE UNIT TRUCK	20 - OTHER VEHICLE	25 - OTHER NON-MOTORIST																																
4 - PICK UP	10 - MOPED OR MOTORIZED BICYCLE	15 - SEMI-TRACTOR	21 - HEAVY EQUIPMENT	26 - BICYCLE																																
5 - CARGO VAN	11 - ALL TERRAIN VEHICLE (ATV / UTV)	16 - FARM EQUIPMENT	22 - ANIMAL WITH RIDER OR ANIMAL-DRAWN VEHICLE	27 - TRAIN																																
6 - VAN (9-15 SEATS)		17 - MOTORHOME		99 - UNKNOWN OR HIT/SKIP																																
# of TRAILING UNITS																																				
WAS VEHICLE OPERATING IN AUTONOMOUS MODE WHEN CRASH OCCURRED?																																				
<table style="width:100%; border: none;"> <tr> <td>1 - YES</td> <td>2 - NO</td> <td>9 - OTHER / UNKNOWN</td> <td colspan="3">AUTONOMOUS MODE LEVEL</td> </tr> <tr> <td colspan="3"></td> <td>0 - NO AUTOMATION</td> <td>3 - CONDITIONAL AUTOMATION</td> <td>9 - UNKNOWN</td> </tr> <tr> <td colspan="3"></td> <td>1 - DRIVER ASSISTANCE</td> <td>4 - HIGH AUTOMATION</td> <td></td> </tr> <tr> <td colspan="3"></td> <td>2 - PARTIAL AUTOMATION</td> <td>5 - FULL AUTOMATION</td> <td></td> </tr> </table>						1 - YES	2 - NO	9 - OTHER / UNKNOWN	AUTONOMOUS MODE LEVEL						0 - NO AUTOMATION	3 - CONDITIONAL AUTOMATION	9 - UNKNOWN				1 - DRIVER ASSISTANCE	4 - HIGH AUTOMATION					2 - PARTIAL AUTOMATION	5 - FULL AUTOMATION								
1 - YES	2 - NO	9 - OTHER / UNKNOWN	AUTONOMOUS MODE LEVEL																																	
			0 - NO AUTOMATION	3 - CONDITIONAL AUTOMATION	9 - UNKNOWN																															
			1 - DRIVER ASSISTANCE	4 - HIGH AUTOMATION																																
			2 - PARTIAL AUTOMATION	5 - FULL AUTOMATION																																
SPECIAL FUNCTION																																				
<table style="width:100%; border: none;"> <tr> <td>1 - NONE</td> <td>6 - BUS - CHARTER/TOUR</td> <td>11 - FIRE</td> <td>16 - FARM</td> <td>21 - MAIL CARRIER</td> </tr> <tr> <td>2 - TAXI</td> <td>7 - BUS - INTERCITY</td> <td>12 - MILITARY</td> <td>17 - MOWING</td> <td>99 - OTHER / UNKNOWN</td> </tr> <tr> <td>3 - ELECTRONIC RIDE SHARING</td> <td>8 - BUS - SHUTTLE</td> <td>13 - POLICE</td> <td>18 - SNOW REMOVAL</td> <td></td> </tr> <tr> <td>4 - SCHOOL TRANSPORT</td> <td>9 - BUS - OTHER</td> <td>14 - PUBLIC UTILITY</td> <td>19 - TOWING</td> <td></td> </tr> <tr> <td>5 - BUS - TRANSIT/COMMUTER</td> <td>10 - AMBULANCE</td> <td>15 - CONSTRUCTION EQUIPMENT</td> <td>20 - SAFETY SERVICE PATROL</td> <td></td> </tr> </table>						1 - NONE	6 - BUS - CHARTER/TOUR	11 - FIRE	16 - FARM	21 - MAIL CARRIER	2 - TAXI	7 - BUS - INTERCITY	12 - MILITARY	17 - MOWING	99 - OTHER / UNKNOWN	3 - ELECTRONIC RIDE SHARING	8 - BUS - SHUTTLE	13 - POLICE	18 - SNOW REMOVAL		4 - SCHOOL TRANSPORT	9 - BUS - OTHER	14 - PUBLIC UTILITY	19 - TOWING		5 - BUS - TRANSIT/COMMUTER	10 - AMBULANCE	15 - CONSTRUCTION EQUIPMENT	20 - SAFETY SERVICE PATROL							
1 - NONE	6 - BUS - CHARTER/TOUR	11 - FIRE	16 - FARM	21 - MAIL CARRIER																																
2 - TAXI	7 - BUS - INTERCITY	12 - MILITARY	17 - MOWING	99 - OTHER / UNKNOWN																																
3 - ELECTRONIC RIDE SHARING	8 - BUS - SHUTTLE	13 - POLICE	18 - SNOW REMOVAL																																	
4 - SCHOOL TRANSPORT	9 - BUS - OTHER	14 - PUBLIC UTILITY	19 - TOWING																																	
5 - BUS - TRANSIT/COMMUTER	10 - AMBULANCE	15 - CONSTRUCTION EQUIPMENT	20 - SAFETY SERVICE PATROL																																	
CARGO BODY TYPE																																				
<table style="width:100%; border: none;"> <tr> <td>1 - NO CARGO BODY TYPE / NOT APPLICABLE</td> <td>3 - VEHICLE TOWING ANOTHER MOTOR VEHICLE</td> <td>5 - INTERMODAL CONTAINER CHASSIS</td> <td>8 - POLE</td> <td>12 - CONCRETE MIXER</td> </tr> <tr> <td>2 - BUS</td> <td>4 - LOGGING</td> <td>6 - CARGO VAN/ENCLOSED BOX</td> <td>9 - CARGO TANK</td> <td>13 - AUTO TRANSPORTER</td> </tr> <tr> <td></td> <td></td> <td>7 - GRAIN/CHIPS/GRAVEL</td> <td>10 - FLAT BED</td> <td>14 - GARBAGE/REFUSE</td> </tr> <tr> <td></td> <td></td> <td></td> <td>11 - DUMP</td> <td>99 - OTHER / UNKNOWN</td> </tr> </table>						1 - NO CARGO BODY TYPE / NOT APPLICABLE	3 - VEHICLE TOWING ANOTHER MOTOR VEHICLE	5 - INTERMODAL CONTAINER CHASSIS	8 - POLE	12 - CONCRETE MIXER	2 - BUS	4 - LOGGING	6 - CARGO VAN/ENCLOSED BOX	9 - CARGO TANK	13 - AUTO TRANSPORTER			7 - GRAIN/CHIPS/GRAVEL	10 - FLAT BED	14 - GARBAGE/REFUSE				11 - DUMP	99 - OTHER / UNKNOWN											
1 - NO CARGO BODY TYPE / NOT APPLICABLE	3 - VEHICLE TOWING ANOTHER MOTOR VEHICLE	5 - INTERMODAL CONTAINER CHASSIS	8 - POLE	12 - CONCRETE MIXER																																
2 - BUS	4 - LOGGING	6 - CARGO VAN/ENCLOSED BOX	9 - CARGO TANK	13 - AUTO TRANSPORTER																																
		7 - GRAIN/CHIPS/GRAVEL	10 - FLAT BED	14 - GARBAGE/REFUSE																																
			11 - DUMP	99 - OTHER / UNKNOWN																																
VEHICLE DEFECTS																																				
<table style="width:100%; border: none;"> <tr> <td>1 - TURN SIGNALS</td> <td>4 - BRAKES</td> <td>7 - WORN OR SLICK TIRES</td> <td>9 - MOTOR TROUBLE</td> <td>99 - OTHER / UNKNOWN</td> </tr> <tr> <td>2 - HEAD LAMPS</td> <td>5 - STEERING</td> <td>8 - TRAILER EQUIPMENT DEFECTIVE</td> <td>10 - DISABLED FROM PRIOR ACCIDENT</td> <td></td> </tr> <tr> <td>3 - TAIL LAMPS</td> <td>6 - TIRE BLOWOUT</td> <td></td> <td></td> <td></td> </tr> </table>						1 - TURN SIGNALS	4 - BRAKES	7 - WORN OR SLICK TIRES	9 - MOTOR TROUBLE	99 - OTHER / UNKNOWN	2 - HEAD LAMPS	5 - STEERING	8 - TRAILER EQUIPMENT DEFECTIVE	10 - DISABLED FROM PRIOR ACCIDENT		3 - TAIL LAMPS	6 - TIRE BLOWOUT																			
1 - TURN SIGNALS	4 - BRAKES	7 - WORN OR SLICK TIRES	9 - MOTOR TROUBLE	99 - OTHER / UNKNOWN																																
2 - HEAD LAMPS	5 - STEERING	8 - TRAILER EQUIPMENT DEFECTIVE	10 - DISABLED FROM PRIOR ACCIDENT																																	
3 - TAIL LAMPS	6 - TIRE BLOWOUT																																			
NON-MOTORIST LOCATION AT IMPACT																																				
<table style="width:100%; border: none;"> <tr> <td>1 - INTERSECTION - MARKED CROSSWALK</td> <td>3 - INTERSECTION - OTHER</td> <td>6 - BICYCLE LANE</td> <td>9 - MEDIAN/CROSSING ISLAND</td> <td>12 - FIRST RESPONDER AT INCIDENT SCENE</td> </tr> <tr> <td>2 - INTERSECTION - UNMARKED CROSSWALK</td> <td>4 - MIDLICK - MARKED CROSSWALK</td> <td>7 - SHOULDER / ROADSIDE</td> <td>10 - DRIVEWAY ACCESS</td> <td>99 - OTHER / UNKNOWN</td> </tr> <tr> <td>5 - TRAVEL LANE - OTHER LOCATION</td> <td></td> <td>8 - SIDEWALK</td> <td>11 - SHARED USE PATHS OR TRAILS</td> <td></td> </tr> </table>						1 - INTERSECTION - MARKED CROSSWALK	3 - INTERSECTION - OTHER	6 - BICYCLE LANE	9 - MEDIAN/CROSSING ISLAND	12 - FIRST RESPONDER AT INCIDENT SCENE	2 - INTERSECTION - UNMARKED CROSSWALK	4 - MIDLICK - MARKED CROSSWALK	7 - SHOULDER / ROADSIDE	10 - DRIVEWAY ACCESS	99 - OTHER / UNKNOWN	5 - TRAVEL LANE - OTHER LOCATION		8 - SIDEWALK	11 - SHARED USE PATHS OR TRAILS																	
1 - INTERSECTION - MARKED CROSSWALK	3 - INTERSECTION - OTHER	6 - BICYCLE LANE	9 - MEDIAN/CROSSING ISLAND	12 - FIRST RESPONDER AT INCIDENT SCENE																																
2 - INTERSECTION - UNMARKED CROSSWALK	4 - MIDLICK - MARKED CROSSWALK	7 - SHOULDER / ROADSIDE	10 - DRIVEWAY ACCESS	99 - OTHER / UNKNOWN																																
5 - TRAVEL LANE - OTHER LOCATION		8 - SIDEWALK	11 - SHARED USE PATHS OR TRAILS																																	
ACTION																																				
<table style="width:100%; border: none;"> <tr> <td>1 - NON-CONTACT</td> <td>1 - STRAIGHT AHEAD</td> <td>7 - MAKING U-TURN</td> <td>13 - NEGOTIATING A CURVE</td> <td>18 - APPROACHING OR LEAVING VEHICLE</td> </tr> <tr> <td>2 - NON-COLLISION</td> <td>2 - BACKING</td> <td>8 - ENTERING TRAFFIC LANE</td> <td>14 - ENTERING OR CROSSING SPECIFIED LOCATION</td> <td>19 - STANDING</td> </tr> <tr> <td>3 - STRIKING</td> <td>3 - CHANGING LANES</td> <td>9 - LEAVING TRAFFIC LANE</td> <td>15 - WALKING, RUNNING, JOGGING, PLAYING</td> <td>20 - OTHER NON-MOTORIST</td> </tr> <tr> <td>4 - STRUCK</td> <td>4 - OVERTAKING/PASSING</td> <td>10 - PARKED</td> <td>16 - WORKING</td> <td>21 - STANDING OUTSIDE DISABLED VEHICLE</td> </tr> <tr> <td>5 - BOTH STRIKING & STRUCK</td> <td>5 - MAKING RIGHT TURN</td> <td>11 - SLOWING OR STOPPED IN TRAFFIC</td> <td>17 - PUSHING VEHICLE</td> <td>99 - OTHER / UNKNOWN</td> </tr> <tr> <td>9 - OTHER / UNKNOWN</td> <td>6 - MAKING LEFT TURN</td> <td>12 - DRIVERLESS</td> <td></td> <td></td> </tr> </table>						1 - NON-CONTACT	1 - STRAIGHT AHEAD	7 - MAKING U-TURN	13 - NEGOTIATING A CURVE	18 - APPROACHING OR LEAVING VEHICLE	2 - NON-COLLISION	2 - BACKING	8 - ENTERING TRAFFIC LANE	14 - ENTERING OR CROSSING SPECIFIED LOCATION	19 - STANDING	3 - STRIKING	3 - CHANGING LANES	9 - LEAVING TRAFFIC LANE	15 - WALKING, RUNNING, JOGGING, PLAYING	20 - OTHER NON-MOTORIST	4 - STRUCK	4 - OVERTAKING/PASSING	10 - PARKED	16 - WORKING	21 - STANDING OUTSIDE DISABLED VEHICLE	5 - BOTH STRIKING & STRUCK	5 - MAKING RIGHT TURN	11 - SLOWING OR STOPPED IN TRAFFIC	17 - PUSHING VEHICLE	99 - OTHER / UNKNOWN	9 - OTHER / UNKNOWN	6 - MAKING LEFT TURN	12 - DRIVERLESS			
1 - NON-CONTACT	1 - STRAIGHT AHEAD	7 - MAKING U-TURN	13 - NEGOTIATING A CURVE	18 - APPROACHING OR LEAVING VEHICLE																																
2 - NON-COLLISION	2 - BACKING	8 - ENTERING TRAFFIC LANE	14 - ENTERING OR CROSSING SPECIFIED LOCATION	19 - STANDING																																
3 - STRIKING	3 - CHANGING LANES	9 - LEAVING TRAFFIC LANE	15 - WALKING, RUNNING, JOGGING, PLAYING	20 - OTHER NON-MOTORIST																																
4 - STRUCK	4 - OVERTAKING/PASSING	10 - PARKED	16 - WORKING	21 - STANDING OUTSIDE DISABLED VEHICLE																																
5 - BOTH STRIKING & STRUCK	5 - MAKING RIGHT TURN	11 - SLOWING OR STOPPED IN TRAFFIC	17 - PUSHING VEHICLE	99 - OTHER / UNKNOWN																																
9 - OTHER / UNKNOWN	6 - MAKING LEFT TURN	12 - DRIVERLESS																																		
CONTRIBUTING CIRCUMSTANCES																																				
<table style="width:100%; border: none;"> <tr> <td>1 - NONE</td> <td>7 - LEFT OF CENTER</td> <td>13 - IMPROPER START FROM A PARKED POSITION</td> <td>17 - VISION OBSTRUCTION</td> <td>21 - LYING IN ROADWAY</td> </tr> <tr> <td>2 - FAILURE TO YIELD</td> <td>8 - FOLLOWING TOO CLOSE / ACDA</td> <td>14 - STOPPED OR PARKED ILLEGALLY</td> <td>18 - OPERATING DEFECTIVE EQUIPMENT</td> <td>22 - NOT DISCERNIBLE</td> </tr> <tr> <td>3 - RAN RED LIGHT</td> <td>9 - IMPROPER LANE CHANGE</td> <td>15 - SWERVING TO AVOID</td> <td>19 - LOAD SHIFTING/FALLING/ SPILLING</td> <td>23 - OPENING DOOR INTO ROADWAY</td> </tr> <tr> <td>4 - RAN STOP SIGN</td> <td>10 - IMPROPER PASSING</td> <td>16 - WRONG WAY</td> <td>20 - IMPROPER CROSSING</td> <td>99 - OTHER IMPROPER ACTION</td> </tr> <tr> <td>5 - UNSAFE SPEED</td> <td>11 - DROVE OFF ROAD</td> <td></td> <td></td> <td></td> </tr> <tr> <td>6 - IMPROPER TURN</td> <td>12 - IMPROPER BACKING</td> <td></td> <td></td> <td></td> </tr> </table>						1 - NONE	7 - LEFT OF CENTER	13 - IMPROPER START FROM A PARKED POSITION	17 - VISION OBSTRUCTION	21 - LYING IN ROADWAY	2 - FAILURE TO YIELD	8 - FOLLOWING TOO CLOSE / ACDA	14 - STOPPED OR PARKED ILLEGALLY	18 - OPERATING DEFECTIVE EQUIPMENT	22 - NOT DISCERNIBLE	3 - RAN RED LIGHT	9 - IMPROPER LANE CHANGE	15 - SWERVING TO AVOID	19 - LOAD SHIFTING/FALLING/ SPILLING	23 - OPENING DOOR INTO ROADWAY	4 - RAN STOP SIGN	10 - IMPROPER PASSING	16 - WRONG WAY	20 - IMPROPER CROSSING	99 - OTHER IMPROPER ACTION	5 - UNSAFE SPEED	11 - DROVE OFF ROAD				6 - IMPROPER TURN	12 - IMPROPER BACKING				
1 - NONE	7 - LEFT OF CENTER	13 - IMPROPER START FROM A PARKED POSITION	17 - VISION OBSTRUCTION	21 - LYING IN ROADWAY																																
2 - FAILURE TO YIELD	8 - FOLLOWING TOO CLOSE / ACDA	14 - STOPPED OR PARKED ILLEGALLY	18 - OPERATING DEFECTIVE EQUIPMENT	22 - NOT DISCERNIBLE																																
3 - RAN RED LIGHT	9 - IMPROPER LANE CHANGE	15 - SWERVING TO AVOID	19 - LOAD SHIFTING/FALLING/ SPILLING	23 - OPENING DOOR INTO ROADWAY																																
4 - RAN STOP SIGN	10 - IMPROPER PASSING	16 - WRONG WAY	20 - IMPROPER CROSSING	99 - OTHER IMPROPER ACTION																																
5 - UNSAFE SPEED	11 - DROVE OFF ROAD																																			
6 - IMPROPER TURN	12 - IMPROPER BACKING																																			
EVENT(S)	SEQUENCE OF EVENTS																																			
	<table style="width:100%; border: none;"> <tr> <td>1 - OVERTURN/ROLLOVER</td> <td>6 - EQUIPMENT FAILURE</td> <td>11 - CROSS CENTERLINE - OPPOSITE DIRECTION OF TRAVEL</td> <td>16 - RAILWAY VEHICLE</td> <td>22 - WORK ZONE MAINTENANCE EQUIPMENT</td> </tr> <tr> <td>2 - FIRE/EXPLOSION</td> <td>7 - SEPARATION OF UNITS</td> <td>12 - DOWNHILL RUNAWAY</td> <td>17 - ANIMAL - FARM</td> <td>23 - STRUCK BY FALLING, SHIFTING CARGO OR ANYTHING SET IN MOTION BY A MOTOR VEHICLE</td> </tr> <tr> <td>3 - IMMERSION</td> <td>8 - RAN OFF ROAD RIGHT</td> <td>13 - OTHER NON-COLLISION</td> <td>18 - ANIMAL - DEER</td> <td>24 - OTHER MOVABLE OBJECT</td> </tr> <tr> <td>4 - JACKKNIFE</td> <td>9 - RAN OFF ROAD LEFT</td> <td>14 - PEDESTRIAN</td> <td>19 - ANIMAL - OTHER</td> <td></td> </tr> <tr> <td>5 - CARGO / EQUIPMENT LOSS OR SHIFT</td> <td>10 - CROSS/MEDIAN</td> <td>15 - PEDALCYCLE</td> <td>20 - MOTOR VEHICLE IN TRANSPORT</td> <td></td> </tr> </table>					1 - OVERTURN/ROLLOVER	6 - EQUIPMENT FAILURE	11 - CROSS CENTERLINE - OPPOSITE DIRECTION OF TRAVEL	16 - RAILWAY VEHICLE	22 - WORK ZONE MAINTENANCE EQUIPMENT	2 - FIRE/EXPLOSION	7 - SEPARATION OF UNITS	12 - DOWNHILL RUNAWAY	17 - ANIMAL - FARM	23 - STRUCK BY FALLING, SHIFTING CARGO OR ANYTHING SET IN MOTION BY A MOTOR VEHICLE	3 - IMMERSION	8 - RAN OFF ROAD RIGHT	13 - OTHER NON-COLLISION	18 - ANIMAL - DEER	24 - OTHER MOVABLE OBJECT	4 - JACKKNIFE	9 - RAN OFF ROAD LEFT	14 - PEDESTRIAN	19 - ANIMAL - OTHER		5 - CARGO / EQUIPMENT LOSS OR SHIFT	10 - CROSS/MEDIAN	15 - PEDALCYCLE	20 - MOTOR VEHICLE IN TRANSPORT							
	1 - OVERTURN/ROLLOVER	6 - EQUIPMENT FAILURE	11 - CROSS CENTERLINE - OPPOSITE DIRECTION OF TRAVEL	16 - RAILWAY VEHICLE	22 - WORK ZONE MAINTENANCE EQUIPMENT																															
	2 - FIRE/EXPLOSION	7 - SEPARATION OF UNITS	12 - DOWNHILL RUNAWAY	17 - ANIMAL - FARM	23 - STRUCK BY FALLING, SHIFTING CARGO OR ANYTHING SET IN MOTION BY A MOTOR VEHICLE																															
	3 - IMMERSION	8 - RAN OFF ROAD RIGHT	13 - OTHER NON-COLLISION	18 - ANIMAL - DEER	24 - OTHER MOVABLE OBJECT																															
	4 - JACKKNIFE	9 - RAN OFF ROAD LEFT	14 - PEDESTRIAN	19 - ANIMAL - OTHER																																
	5 - CARGO / EQUIPMENT LOSS OR SHIFT	10 - CROSS/MEDIAN	15 - PEDALCYCLE	20 - MOTOR VEHICLE IN TRANSPORT																																
	NON-COLLISION																																			
	<table style="width:100%; border: none;"> <tr> <td>25 - IMPACT ATTENUATOR / CRASH CUSHION</td> <td>31 - GUARDRAIL END</td> <td>37 - TRAFFIC SIGN POST</td> <td>43 - CURB</td> <td>50 - WORK ZONE MAINTENANCE EQUIPMENT</td> </tr> <tr> <td>26 - BRIDGE OVERHEAD STRUCTURE</td> <td>32 - PORTABLE BARRIER</td> <td>38 - OVERHEAD SIGN POST</td> <td>44 - DITCH</td> <td>51 - WALL</td> </tr> <tr> <td>27 - BRIDGE PIER OR ABUTMENT</td> <td>33 - MEDIAN CABLE BARRIER</td> <td>39 - LIGHT / LUMINARIES SUPPORT</td> <td>45 - EMBANKMENT</td> <td>52 - BUILDING</td> </tr> <tr> <td>28 - BRIDGE PARAPET</td> <td>34 - MEDIAN GUARDRAIL BARRIER</td> <td>40 - UTILITY POLE</td> <td>46 - FENCE</td> <td>53 - TUNNEL</td> </tr> <tr> <td>29 - BRIDGE RAIL</td> <td>35 - MEDIAN CONCRETE BARRIER</td> <td>41 - OTHER POST, POLE OR SUPPORT</td> <td>47 - MAILBOX</td> <td>54 - OTHER FIXED OBJECT</td> </tr> <tr> <td>30 - GUARDRAIL FACE</td> <td>36 - MEDIAN OTHER BARRIER</td> <td>42 - CULVERT</td> <td>48 - TREE</td> <td>99 - OTHER / UNKNOWN</td> </tr> </table>					25 - IMPACT ATTENUATOR / CRASH CUSHION	31 - GUARDRAIL END	37 - TRAFFIC SIGN POST	43 - CURB	50 - WORK ZONE MAINTENANCE EQUIPMENT	26 - BRIDGE OVERHEAD STRUCTURE	32 - PORTABLE BARRIER	38 - OVERHEAD SIGN POST	44 - DITCH	51 - WALL	27 - BRIDGE PIER OR ABUTMENT	33 - MEDIAN CABLE BARRIER	39 - LIGHT / LUMINARIES SUPPORT	45 - EMBANKMENT	52 - BUILDING	28 - BRIDGE PARAPET	34 - MEDIAN GUARDRAIL BARRIER	40 - UTILITY POLE	46 - FENCE	53 - TUNNEL	29 - BRIDGE RAIL	35 - MEDIAN CONCRETE BARRIER	41 - OTHER POST, POLE OR SUPPORT	47 - MAILBOX	54 - OTHER FIXED OBJECT	30 - GUARDRAIL FACE	36 - MEDIAN OTHER BARRIER	42 - CULVERT	48 - TREE	99 - OTHER / UNKNOWN	
	25 - IMPACT ATTENUATOR / CRASH CUSHION	31 - GUARDRAIL END	37 - TRAFFIC SIGN POST	43 - CURB	50 - WORK ZONE MAINTENANCE EQUIPMENT																															
26 - BRIDGE OVERHEAD STRUCTURE	32 - PORTABLE BARRIER	38 - OVERHEAD SIGN POST	44 - DITCH	51 - WALL																																
27 - BRIDGE PIER OR ABUTMENT	33 - MEDIAN CABLE BARRIER	39 - LIGHT / LUMINARIES SUPPORT	45 - EMBANKMENT	52 - BUILDING																																
28 - BRIDGE PARAPET	34 - MEDIAN GUARDRAIL BARRIER	40 - UTILITY POLE	46 - FENCE	53 - TUNNEL																																
29 - BRIDGE RAIL	35 - MEDIAN CONCRETE BARRIER	41 - OTHER POST, POLE OR SUPPORT	47 - MAILBOX	54 - OTHER FIXED OBJECT																																
30 - GUARDRAIL FACE	36 - MEDIAN OTHER BARRIER	42 - CULVERT	48 - TREE	99 - OTHER / UNKNOWN																																
COLLISION WITH FIXED OBJECT - STRUCK																																				
<table style="width:100%; border: none;"> <tr> <td>1 - FIRST HARMFUL EVENT</td> <td>1 - MOST HARMFUL EVENT</td> <td></td> <td></td> <td></td> </tr> </table>					1 - FIRST HARMFUL EVENT	1 - MOST HARMFUL EVENT																														
1 - FIRST HARMFUL EVENT	1 - MOST HARMFUL EVENT																																			

LOCAL REPORT NUMBER													
L P 1 9 0 6 0 1 0 0 2 7 1 0													
DAMAGE													
DAMAGE SCALE													
<table style="width:100%; border: none;"> <tr> <td>1 - NONE</td> <td>3 - FUNCTIONAL DAMAGE</td> </tr> <tr> <td>2 - MINOR DAMAGE</td> <td>4 - DISABLING DAMAGE</td> </tr> <tr> <td colspan="2" style="text-align: center;">9 - UNKNOWN</td> </tr> </table>		1 - NONE	3 - FUNCTIONAL DAMAGE	2 - MINOR DAMAGE	4 - DISABLING DAMAGE	9 - UNKNOWN							
1 - NONE	3 - FUNCTIONAL DAMAGE												
2 - MINOR DAMAGE	4 - DISABLING DAMAGE												
9 - UNKNOWN													
DAMAGED AREA(S) INDICATE ALL THAT APPLY													
<input type="checkbox"/> - NO DAMAGE [0] <input type="checkbox"/> - UNDERCARRIAGE [14] <input type="checkbox"/> - TOP [13] <input type="checkbox"/> - ALL AREAS [15] <input type="checkbox"/> - UNIT NOT AT SCENE [16]													
INITIAL POINT OF CONTACT													
<table style="width:100%; border: none;"> <tr> <td>0 - NO DAMAGE</td> <td>14 - UNDERCARRIAGE</td> </tr> <tr> <td>1-12 - REFER TO UNIT DIAGRAM</td> <td>15 - VEHICLE NOT AT SCENE</td> </tr> <tr> <td>13 - TOP</td> <td>99 - UNKNOWN</td> </tr> </table>		0 - NO DAMAGE	14 - UNDERCARRIAGE	1-12 - REFER TO UNIT DIAGRAM	15 - VEHICLE NOT AT SCENE	13 - TOP	99 - UNKNOWN						
0 - NO DAMAGE	14 - UNDERCARRIAGE												
1-12 - REFER TO UNIT DIAGRAM	15 - VEHICLE NOT AT SCENE												
13 - TOP	99 - UNKNOWN												
TRAFFIC													
TRAFFICWAY FLOW	TRAFFIC CONTROL												
<table style="width:100%; border: none;"> <tr> <td>1 - ONE-WAY</td> <td>4 - STOP SIGN</td> </tr> <tr> <td>2 - TWO-WAY</td> <td>5 - YIELD SIGN</td> </tr> <tr> <td></td> <td>6 - NO CONTROL</td> </tr> </table>	1 - ONE-WAY	4 - STOP SIGN	2 - TWO-WAY	5 - YIELD SIGN		6 - NO CONTROL	<table style="width:100%; border: none;"> <tr> <td>1 - ROUNDABOUT</td> <td>4 - STOP SIGN</td> </tr> <tr> <td>2 - SIGNAL</td> <td>5 - YIELD SIGN</td> </tr> <tr> <td>3 - FLASHER</td> <td>6 - NO CONTROL</td> </tr> </table>	1 - ROUNDABOUT	4 - STOP SIGN	2 - SIGNAL	5 - YIELD SIGN	3 - FLASHER	6 - NO CONTROL
1 - ONE-WAY	4 - STOP SIGN												
2 - TWO-WAY	5 - YIELD SIGN												
	6 - NO CONTROL												
1 - ROUNDABOUT	4 - STOP SIGN												
2 - SIGNAL	5 - YIELD SIGN												
3 - FLASHER	6 - NO CONTROL												
# of THROUGH LANES ON ROAD	RAIL GRADE CROSSING												
2	<table style="width:100%; border: none;"> <tr> <td>1 - NOT INVOLVED</td> </tr> <tr> <td>2 - INVOLVED-ACTIVE CROSSING</td> </tr> <tr> <td>3 - INVOLVED-PASSIVE CROSSING</td> </tr> </table>	1 - NOT INVOLVED	2 - INVOLVED-ACTIVE CROSSING	3 - INVOLVED-PASSIVE CROSSING									
1 - NOT INVOLVED													
2 - INVOLVED-ACTIVE CROSSING													
3 - INVOLVED-PASSIVE CROSSING													
UNIT / NON-MOTORIST DIRECTION													
<table style="width:100%; border: none;"> <tr> <td>1 - NORTH</td> <td>5 - NORTHEAST</td> </tr> <tr> <td>2 - SOUTH</td> <td>6 - NORTHWEST</td> </tr> <tr> <td>3 - EAST</td> <td>7 - SOUTHEAST</td> </tr> <tr> <td>4 - WEST</td> <td>8 - SOUTHWEST</td> </tr> <tr> <td colspan="2" style="text-align: center;">9 - OTHER / UNKNOWN</td> </tr> </table>		1 - NORTH	5 - NORTHEAST	2 - SOUTH	6 - NORTHWEST	3 - EAST	7 - SOUTHEAST	4 - WEST	8 - SOUTHWEST	9 - OTHER / UNKNOWN			
1 - NORTH	5 - NORTHEAST												
2 - SOUTH	6 - NORTHWEST												
3 - EAST	7 - SOUTHEAST												
4 - WEST	8 - SOUTHWEST												
9 - OTHER / UNKNOWN													
UNIT SPEED	DETECTED SPEED												
0 1 5	<table style="width:100%; border: none;"> <tr> <td>1 - STATED / ESTIMATED SPEED</td> </tr> <tr> <td>2 - CALCULATED / EDR</td> </tr> <tr> <td>3 - UNDETERMINED</td> </tr> </table>	1 - STATED / ESTIMATED SPEED	2 - CALCULATED / EDR	3 - UNDETERMINED									
1 - STATED / ESTIMATED SPEED													
2 - CALCULATED / EDR													
3 - UNDETERMINED													
POSTED SPEED													
5 0													

OWNER	UNIT # 02	OWNER NAME: LAST, FIRST, MIDDLE (☐ SAME AS DRIVER)	OWNER PHONE: INCLUDE AREA CODE (☐ SAME AS DRIVER)			
	OWNER ADDRESS: STREET, CITY, STATE, ZIP (☐ SAME AS DRIVER)					
	COMMERCIAL CARRIER: NAME, ADDRESS, CITY, STATE, ZIP		COMMERCIAL CARRIER PHONE: INCLUDE AREA CODE			
VEHICLE	LP STATE OH	LICENSE PLATE # GAP7425	VEHICLE IDENTIFICATION # JTJHCFL1D25E5004745	VEHICLE YEAR 2014	VEHICLE MAKE LEXUS	
	<input checked="" type="checkbox"/> INSURANCE VERIFIED	INSURANCE COMPANY BOORD-HEENE	INSURANCE POLICY # 52-001706-00	COLOR WHITE	VEHICLE MODEL IS250	
	<input type="checkbox"/> COMMERCIAL	<input type="checkbox"/> GOVERNMENT	<input type="checkbox"/> IN EMERGENCY RESPONSE	US DOT #		
	<input type="checkbox"/> INTERLOCK DEVICE EQUIPPED	<input type="checkbox"/> HIT/SKIP UNIT	#OCCUPANTS 01	VEHICLE WEIGHT GVWR/GCWR 1 - <10K LBS. 2 - 10,001 - 26K LBS. 3 - >26K LBS.		
	TYPE OF USE			TOWED BY: COMPANY NAME		
	<input type="checkbox"/> COMMERCIAL <input type="checkbox"/> GOVERNMENT <input type="checkbox"/> IN EMERGENCY RESPONSE			<input type="checkbox"/> HAZARDOUS MATERIAL <input type="checkbox"/> MATERIAL RELEASED <input type="checkbox"/> PLACARD CLASS # PLACARD ID #		
	UNIT TYPE 01			UNIT TYPE		
	# OF TRAILING UNITS			UNIT TYPE		
	WAS VEHICLE OPERATING IN AUTONOMOUS MODE WHEN CRASH OCCURRED?			AUTONOMOUS MODE LEVEL		
	1 - YES 2 - NO 9 - OTHER / UNKNOWN			0 - NO AUTOMATION 1 - DRIVER ASSISTANCE 2 - PARTIAL AUTOMATION 3 - CONDITIONAL AUTOMATION 4 - HIGH AUTOMATION 5 - FULL AUTOMATION 9 - UNKNOWN		
SPECIAL FUNCTION 01			SPECIAL FUNCTION			
1 - NONE 2 - TAXI 3 - ELECTRONIC RIDE SHARING 4 - SCHOOL TRANSPORT 5 - BUS - TRANSIT/COMMUTER			6 - BUS - CHARTER/TOUR 7 - BUS - INTERCITY 8 - BUS - SHUTTLE 9 - BUS - OTHER 10 - AMBULANCE 11 - FIRE 12 - MILITARY 13 - POLICE 14 - PUBLIC UTILITY 15 - CONSTRUCTION EQUIPMENT 16 - FARM 17 - MOWING 18 - SNOW REMOVAL 19 - TOWING 20 - SAFETY SERVICE PATROL 21 - MAIL CARRIER 99 - OTHER / UNKNOWN			
CARGO BODY TYPE 01			CARGO BODY TYPE			
1 - NO CARGO BODY TYPE / NOT APPLICABLE 2 - BUS			3 - VEHICLE TOWING ANOTHER MOTOR VEHICLE 4 - LOGGING 5 - INTERMODAL CONTAINER CHASSIS 6 - CARGO VAN/ENCLOSED BOX 7 - GRAIN/CHIPS/GRAVEL 8 - POLE 9 - CARGO TANK 10 - FLAT BED 11 - DUMP 12 - CONCRETE MIXER 13 - AUTOTRANSPORTER 14 - GARBAGE/REFUSE 99 - OTHER / UNKNOWN			
VEHICLE DEFECTS			VEHICLE DEFECTS			
1 - TURN SIGNALS 2 - HEAD LAMPS 3 - TAIL LAMPS			4 - BRAKES 5 - STEERING 6 - TIRE BLOWOUT 7 - WORN OR SLICK TIRES 8 - TRAILER EQUIPMENT DEFECTIVE 9 - MOTOR TROUBLE 10 - DISABLED FROM PRIOR ACCIDENT 99 - OTHER / UNKNOWN			
NON-MOTORIST LOCATION AT IMPACT			NON-MOTORIST LOCATION AT IMPACT			
1 - INTERSECTION - MARKED CROSSWALK 2 - INTERSECTION - UNMARKED CROSSWALK			3 - INTERSECTION - OTHER 4 - MIDLICK - MARKED CROSSWALK 5 - TRAVEL LANE - OTHER LOCATION 6 - BICYCLE LANE 7 - SHOULDER / ROADSIDE 8 - SIDEWALK 9 - MEDIAN/CROSSING ISLAND 10 - DRIVEWAY ACCESS 11 - SHARED USE PATHS OR TRAILS 12 - FIRST RESPONDER AT INCIDENT SCENE 99 - OTHER / UNKNOWN			
ACTION 4			ACTION			
1 - NON-CONTACT 2 - NON-COLLISION 3 - STRIKING 4 - STRUCK 5 - BOTH STRIKING & STRUCK 9 - OTHER / UNKNOWN			1 - STRAIGHT AHEAD 2 - BACKING 3 - CHANGING LANES 4 - OVERTAKING/PASSING 5 - MAKING RIGHT TURN 6 - MAKING LEFT TURN 7 - MAKING U-TURN 8 - ENTERING TRAFFIC LANE 9 - LEAVING TRAFFIC LANE 10 - PARKED 11 - SLOWING OR STOPPED IN TRAFFIC 12 - DRIVERLESS 13 - NEGOTIATING A CURVE 14 - ENTERING OR CROSSING SPECIFIED LOCATION 15 - WALKING, RUNNING, JOGGING, PLAYING 16 - WORKING 17 - PUSHING VEHICLE 18 - APPROACHING OR LEAVING VEHICLE 19 - STANDING 20 - OTHER NON-MOTORIST 21 - STANDING OUTSIDE DISABLED VEHICLE 99 - OTHER / UNKNOWN			
CONTRIBUTING CIRCUMSTANCES 01			CONTRIBUTING CIRCUMSTANCES			
1 - NONE 2 - FAILURE TO YIELD 3 - RAN RED LIGHT 4 - RAN STOP SIGN 5 - UNSAFE SPEED 6 - IMPROPER TURN			7 - LEFT OF CENTER 8 - FOLLOWING TOO CLOSE / ACDA 9 - IMPROPER LANE CHANGE 10 - IMPROPER PASSING 11 - DROVE OFF ROAD 12 - IMPROPER BACKING 13 - IMPROPER START FROM A PARKED POSITION 14 - STOPPED OR PARKED ILLEGALLY 15 - SWERVING TO AVOID 16 - WRONG WAY 17 - VISION OBSTRUCTION 18 - OPERATING DEFECTIVE EQUIPMENT 19 - LOAD SHIFTING/FALLING/SPILLING 20 - IMPROPER CROSSING 21 - LYING IN ROADWAY 22 - NOT DISCERNIBLE 23 - OPENING DOOR INTO ROADWAY 99 - OTHER IMPROPER ACTION			
SEQUENCE OF EVENTS			SEQUENCE OF EVENTS			
1 2 0			1 2 0			
1 - OVERTURN/ROLL OVER 2 - FIRE/EXPLOSION 3 - IMMERSION 4 - JACKKNIFE 5 - CARGO / EQUIPMENT LOSS OR SHIFT			6 - EQUIPMENT FAILURE 7 - SEPARATION OF UNITS 8 - RAN OFF ROAD RIGHT 9 - RAN OFF ROAD LEFT 10 - CROSS MEDIAN 11 - CROSS CENTERLINE - OPPOSITE DIRECTION OF TRAVEL 12 - DOWNHILL RUNAWAY 13 - OTHER NON-COLLISION 14 - PEDESTRIAN 15 - PEDALCYCLE 16 - RAILWAY VEHICLE 17 - ANIMAL - FARM 18 - ANIMAL - DEER 19 - ANIMAL - OTHER 20 - MOTOR VEHICLE IN TRANSPORT 21 - PARKED MOTOR VEHICLE 22 - WORK ZONE MAINTENANCE EQUIPMENT 23 - STRUCK BY FALLING, SHIFTING CARGO OR ANYTHING SET IN MOTION BY A MOTOR VEHICLE 24 - OTHER MOVABLE OBJECT			
COLLISION WITH FIXED OBJECT - STRUCK			COLLISION WITH FIXED OBJECT - STRUCK			
25 - IMPACT ATTENUATOR / CRASH CUSHION 26 - BRIDGE OVERHEAD STRUCTURE 27 - BRIDGE PIER OR ABUTMENT 28 - BRIDGE PARAPET 29 - BRIDGE RAIL 30 - GUARDRAIL FACE			31 - GUARDRAIL END 32 - PORTABLE BARRIER 33 - MEDIAN CABLE BARRIER 34 - MEDIAN GUARDRAIL BARRIER 35 - MEDIAN CONCRETE BARRIER 36 - MEDIAN OTHER BARRIER 37 - TRAFFIC SIGN POST 38 - OVERHEAD SIGN POST 39 - LIGHT / LUMINARIES SUPPORT 40 - UTILITY POLE 41 - OTHER POST, POLE OR SUPPORT 42 - CULVERT 43 - CURB 44 - DITCH 45 - EMBANKMENT 46 - FENCE 47 - MAILBOX 48 - TREE 49 - FIRE HYDRANT 50 - WORK ZONE MAINTENANCE EQUIPMENT 51 - WALL 52 - BUILDING 53 - TUNNEL 54 - OTHER FIXED OBJECT 99 - OTHER / UNKNOWN			
FIRST HARMFUL EVENT			FIRST HARMFUL EVENT			
1			1			
MOST HARMFUL EVENT			MOST HARMFUL EVENT			
1			1			

LOCAL REPORT NUMBER LP 190601002710	
DAMAGE	
DAMAGE SCALE	
3 1 - NONE 2 - MINOR DAMAGE 3 - FUNCTIONAL DAMAGE 4 - DISABLING DAMAGE 9 - UNKNOWN	
DAMAGED AREA(S) INDICATE ALL THAT APPLY	
<input type="checkbox"/> - NO DAMAGE [0] <input type="checkbox"/> - UNDERCARRIAGE [14] <input type="checkbox"/> - TOP [13] <input type="checkbox"/> - ALL AREAS [15] <input type="checkbox"/> - UNIT NOT AT SCENE [16]	
INITIAL POINT OF CONTACT	
0 - NO DAMAGE 1-12 - REFER TO UNIT DIAGRAM 13 - TOP 14 - UNDERCARRIAGE 15 - VEHICLE NOT AT SCENE 99 - UNKNOWN	
TRAFFIC	
TRAFFICWAY FLOW 2 1 - ONE-WAY 2 - TWO-WAY	TRAFFIC CONTROL 6 1 - ROUNDABOUT 2 - SIGNAL 3 - FLASHER 4 - STOP SIGN 5 - YIELD SIGN 6 - NO CONTROL
# OF THROUGH LANES ON ROAD 2	RAIL GRADE CROSSING 1 - NOT INVOLVED 2 - INVOLVED-ACTIVE CROSSING 3 - INVOLVED-PASSIVE CROSSING
UNIT / NON-MOTORIST DIRECTION	
FROM 1 TO 2 1 - NORTH 2 - SOUTH 3 - EAST 4 - WEST 5 - NORTHEAST 6 - NORTHWEST 7 - SOUTHEAST 8 - SOUTHWEST 9 - OTHER / UNKNOWN	
UNIT SPEED 0 1 0	DETECTED SPEED 1 1 - STATED / ESTIMATED SPEED 2 - CALCULATED / EDR 3 - UNDETERMINED
POSTED SPEED 5 0	



MOTORIST / NON-MOTORIST

LOCAL REPORT NUMBER
L P 1 9 0 6 0 1 0 0 2 7 1 0

UNIT # 0 1	NAME: LAST, FIRST, MIDDLE MCCUNE, KENNETH EDWARD				DATE OF BIRTH 0 6 / 2 8 / 1 9 7 7		AGE 4 1	GENDER M		
ADDRESS: STREET, CITY, STATE, ZIP 675 E ST RT 73					CONTACT PHONE - INCLUDE AREA CODE 9 3 7 4 2 2 0 0 2 7					
INJURIES TAKEN BY 5	EMS AGENCY (NAME)	INJURED TAKEN TO: MEDICAL FACILITY (NAME, CITY)		SAFETY EQUIPMENT USED 0 4	<input type="checkbox"/> DOT-COMPLIANT MC HELMET	SEATING POSITION 0 1	AIR BAG USAGE 1	EJECTION 1	TRAPPED 1	
OL STATE O H	OPERATOR LICENSE NUMBER RJ612965	OFFENSE CHARGED 4511.21	LOCAL CODE <input type="checkbox"/>	OFFENSE DESCRIPTION ACDA		CITATION NUMBER 017392				
OL CLASS 2	ENDORSEMENT SELECT UP TO 2	RESTRICTION SELECT UP TO 3	DRIVER DISTRACTED BY 1	ALCOHOL / DRUG SUSPECTED <input type="checkbox"/> ALCOHOL <input type="checkbox"/> MARIJUANA <input type="checkbox"/> OTHER DRUG		CONDITION 1	ALCOHOL TEST STATUS TYPE VALUE		DRUG TEST(S) STATUS TYPE RESULT SELECT UP TO 4	

UNIT # 0 2	NAME: LAST, FIRST, MIDDLE GARDNER, MARVIN P				DATE OF BIRTH 0 9 / 1 7 / 1 9 8 6		AGE 3 2	GENDER M		
ADDRESS: STREET, CITY, STATE, ZIP 9534 TAHOE DR, CENTERVILLE, OHIO, 45458					CONTACT PHONE - INCLUDE AREA CODE 9 3 7 4 3 0 7 4 7 6					
INJURIES TAKEN BY 5	EMS AGENCY (NAME)	INJURED TAKEN TO: MEDICAL FACILITY (NAME, CITY)		SAFETY EQUIPMENT USED 0 4	<input type="checkbox"/> DOT-COMPLIANT MC HELMET	SEATING POSITION 0 1	AIR BAG USAGE 1	EJECTION 1	TRAPPED 1	
OL STATE O H	OPERATOR LICENSE NUMBER SN280061	OFFENSE CHARGED	LOCAL CODE <input type="checkbox"/>	OFFENSE DESCRIPTION		CITATION NUMBER				
OL CLASS 4	ENDORSEMENT SELECT UP TO 2	RESTRICTION SELECT UP TO 3	DRIVER DISTRACTED BY 1	ALCOHOL / DRUG SUSPECTED <input type="checkbox"/> ALCOHOL <input type="checkbox"/> MARIJUANA <input type="checkbox"/> OTHER DRUG		CONDITION 1	ALCOHOL TEST STATUS TYPE VALUE		DRUG TEST(S) STATUS TYPE RESULT SELECT UP TO 4	

UNIT #	NAME: LAST, FIRST, MIDDLE				DATE OF BIRTH		AGE	GENDER		
ADDRESS: STREET, CITY, STATE, ZIP					CONTACT PHONE - INCLUDE AREA CODE					
INJURIES TAKEN BY	EMS AGENCY (NAME)	INJURED TAKEN TO: MEDICAL FACILITY (NAME, CITY)		SAFETY EQUIPMENT USED	<input type="checkbox"/> DOT-COMPLIANT MC HELMET	SEATING POSITION	AIR BAG USAGE	EJECTION	TRAPPED	
OL STATE	OPERATOR LICENSE NUMBER	OFFENSE CHARGED	LOCAL CODE	OFFENSE DESCRIPTION		CITATION NUMBER				
OL CLASS	ENDORSEMENT SELECT UP TO 2	RESTRICTION SELECT UP TO 3	DRIVER DISTRACTED BY	ALCOHOL / DRUG SUSPECTED <input type="checkbox"/> ALCOHOL <input type="checkbox"/> MARIJUANA <input type="checkbox"/> OTHER DRUG		CONDITION	ALCOHOL TEST STATUS TYPE VALUE		DRUG TEST(S) STATUS TYPE RESULT SELECT UP TO 4	

INJURIES	SEATING POSITION	AIR BAG	OL CLASS	OL RESTRICTION(S)	DRIVER DISTRACTION	TEST STATUS
1 - FATAL	1 - FRONT - LEFT SIDE (MOTORCYCLE DRIVER)	1 - NOT DEPLOYED	1 - CLASS A	1 - ALCOHOL INTERLOCK DEVICE	1 - NOT DISTRACTED	1 - NONE GIVEN
2 - SUSPECTED SERIOUS INJURY	2 - FRONT - MIDDLE	2 - DEPLOYED FRONT	2 - CLASS B	2 - CDL INTRASTATE ONLY	2 - MANUALLY OPERATING AN ELECTRONIC COMMUNICATION DEVICE (TEXTING, TYPING, DIALING)	2 - TEST REFUSED
3 - SUSPECTED MINOR INJURY	3 - FRONT - RIGHT SIDE	3 - DEPLOYED SIDE	3 - CLASS C	3 - CORRECTIVE LENSES	3 - TALKING ON HANDS-FREE COMMUNICATION DEVICE	3 - TEST GIVEN, CONTAMINATED SAMPLE / UNUSABLE
4 - POSSIBLE INJURY	4 - SECOND - LEFT SIDE (MOTORCYCLE PASSENGER)	4 - DEPLOYED BOTH FRONT / SIDE	4 - REGULAR CLASS (OHIO = D)	4 - FARM WAIVER	4 - TALKING ON HAND-HELD COMMUNICATION DEVICE	4 - TEST GIVEN, RESULTS KNOWN
5 - NO APPARENT INJURY	5 - SECOND - MIDDLE	5 - NOT APPLICABLE	5 - M/C MOPED ONLY	5 - EXCEPT CLASS A BUS	5 - OTHER ACTIVITY WITH AN ELECTRONIC DEVICE	5 - TEST GIVEN, RESULTS UNKNOWN
INJURED TAKEN BY	6 - SECOND - RIGHT SIDE	9 - DEPLOYMENT UNKNOWN	6 - NO VALID DL	6 - EXCEPT CLASS A & CLASS B BUS	6 - PASSENGER	ALCOHOL TEST TYPE
1 - NOT TRANSPORTED / TREATED AT SCENE	7 - THIRD - LEFT SIDE (MOTORCYCLE SIDE CAR)	EJECTION	OL ENDORSEMENT	7 - EXCEPT TRACTOR-TRAILER	7 - OTHER DISTRACTION INSIDE THE VEHICLE	1 - NONE
2 - EMS	8 - THIRD - MIDDLE	1 - NOT EJECTED	H - HAZMAT	8 - INTERMEDIATE LICENSE RESTRICTIONS	8 - OTHER DISTRACTION OUTSIDE THE VEHICLE	2 - BLOOD
3 - POLICE	9 - THIRD - RIGHT SIDE	2 - PARTIALLY EJECTED	M - MOTORCYCLE	9 - LEARNER'S PERMIT RESTRICTIONS	9 - OTHER / UNKNOWN	3 - URINE
9 - OTHER / UNKNOWN	10 - SLEEPER SECTION OF TRUCK CAB	3 - TOTALLY EJECTED	P - PASSENGER	10 - LIMITED TO DAYLIGHT ONLY	CONDITION	4 - BREATH
SAFETY EQUIPMENT	11 - PASSENGER IN OTHER ENCLOSED CARGO AREA (NON-TRAILING UNIT, BUS, PICK-UP WITH CAP)	4 - NOT APPLICABLE	N - TANKER	11 - LIMITED TO EMPLOYMENT	1 - APPARENTLY NORMAL	5 - OTHER
1 - NONE USED	12 - PASSENGER IN UNENCLOSED CARGO AREA	TRAPPED	Q - MOTOR SCOOTER	12 - LIMITED - OTHER	2 - PHYSICAL IMPAIRMENT	DRUG TEST TYPE
2 - SHOULDER BELT ONLY USED	13 - TRAILING UNIT	1 - NOT TRAPPED	R - THREE-WHEEL MOTORCYCLE	13 - MECHANICAL DEVICES (SPECIAL BRAKES, HAND CONTROLS, OR OTHER ADAPTIVE DEVICES)	3 - EMOTIONAL (E.G., DEPRESSED, ANGRY, DISTURBED)	1 - NONE
3 - LAP BELT ONLY USED	14 - RIDING ON VEHICLE EXTERIOR (NON-TRAILING UNIT)	2 - EXTRICATED BY MECHANICAL MEANS	S - SCHOOL BUS	14 - MILITARY VEHICLES ONLY	4 - ILLNESS	2 - BLOOD
4 - SHOULDER & LAP BELT USED	15 - NON-MOTORIST	3 - FREED BY NON-MECHANICAL MEANS	T - DOUBLE & TRIPLE TRAILERS	15 - MOTOR VEHICLES WITHOUT AIR BRAKES	5 - FELL ASLEEP, FAINTED, FATIGUED, ETC.	3 - URINE
5 - CHILD RESTRAINT SYSTEM - FORWARD FACING	99 - OTHER / UNKNOWN		X - TANKER / HAZMAT	16 - OUTSIDE MIRROR	6 - UNDER THE INFLUENCE OF MEDICATIONS / DRUGS / ALCOHOL	4 - OTHER
6 - CHILD RESTRAINT SYSTEM - REAR FACING				17 - PROSTHETIC AID	9 - OTHER / UNKNOWN	DRUG TEST RESULT(S)
7 - BOOSTER SEAT				18 - OTHER		1 - AMPHETAMINES
8 - HELMET USED						2 - BARBITURATES
9 - PROTECTIVE PADS USED (ELBOW, KNEES, ETC.)						3 - BENZODIAZEPINES
10 - REFLECTIVE CLOTHING						4 - CANNABINOIDS
11 - LIGHTING - PEDESTRIAN / BICYCLE ONLY						5 - COCAINE
99 - OTHER / UNKNOWN						6 - OPIATES / OPIOIDS
						7 - OTHER
						8 - NEGATIVE RESULTS

OCCUPANT / WITNESS ADDENDUM

LOCAL REPORT NUMBER
L P 1 9 0 6 0 1 0 0 2 7 1 0

OCCUPANT	UNIT # 1	NAME: LAST, FIRST, MIDDLE MCCUNE, MADILYN	DATE OF BIRTH 0 3 / 2 2 / 2 0 0 6		AGE 1 3	GENDER F
	ADDRESS: STREET, CITY, STATE, ZIP 2537 MARIGOLD DR, DAYTON, OHIO, 45449			CONTACT PHONE - INCLUDE AREA CODE 9 3 7 4 2 2 0 0 2 7		
	INJURIES 5	INJURED TAKEN BY	EMS AGENCY (NAME)	INJURED TAKEN TO: MEDICAL FACILITY (NAME, CITY)	SAFETY EQUIPMENT USED 0 4	<input type="checkbox"/> DOT-COMPLIANT MC HELMET

OCCUPANT	UNIT # 1	NAME: LAST, FIRST, MIDDLE MCCUNE, MAKENNA	DATE OF BIRTH 0 8 / 2 9 / 2 0 0 7		AGE 1 1	GENDER F
	ADDRESS: STREET, CITY, STATE, ZIP 2537 MARIGOLD DR, DAYTON, OHIO, 45449			CONTACT PHONE - INCLUDE AREA CODE 9 3 7 4 2 2 0 0 2 7		
	INJURIES 5	INJURED TAKEN BY	EMS AGENCY (NAME)	INJURED TAKEN TO: MEDICAL FACILITY (NAME, CITY)	SAFETY EQUIPMENT USED 0 4	<input type="checkbox"/> DOT-COMPLIANT MC HELMET

OCCUPANT	UNIT # 1	NAME: LAST, FIRST, MIDDLE MCCUNE, SAMMUEL	DATE OF BIRTH 0 2 / 1 2 / 2 0 1 2		AGE 0 7	GENDER M
	ADDRESS: STREET, CITY, STATE, ZIP 2537 MARIGOLD DR, DAYTON, OHIO, 45449			CONTACT PHONE - INCLUDE AREA CODE 9 3 7 4 2 2 0 0 2 7		
	INJURIES 5	INJURED TAKEN BY	EMS AGENCY (NAME)	INJURED TAKEN TO: MEDICAL FACILITY (NAME, CITY)	SAFETY EQUIPMENT USED 0 4	<input type="checkbox"/> DOT-COMPLIANT MC HELMET

OCCUPANT	UNIT #	NAME: LAST, FIRST, MIDDLE	DATE OF BIRTH		AGE	GENDER
	ADDRESS: STREET, CITY, STATE, ZIP			CONTACT PHONE - INCLUDE AREA CODE		
	INJURIES	INJURED TAKEN BY	EMS AGENCY (NAME)	INJURED TAKEN TO: MEDICAL FACILITY (NAME, CITY)	SAFETY EQUIPMENT USED	<input type="checkbox"/> DOT-COMPLIANT MC HELMET

INJURIES	SAFETY EQUIPMENT USED	SEATING POSITION	AIR BAG USAGE
1 - FATAL 2 - SUSPECTED SERIOUS INJURY 3 - SUSPECTED MINOR INJURY 4 - POSSIBLE INJURY 5 - NO APPARENT INJURY	1 - NONE USED - VEHICLE OCCUPANT 2 - SHOULDER BELT ONLY USED 3 - LAP BELT ONLY USED 4 - SHOULDER & LAP BELT USED 5 - CHILD RESTRAINT SYSTEM - FORWARD FACING 6 - CHILD RESTRAINT SYSTEM - REAR FACING 7 - BOOSTER SEAT 8 - HELMET USED 9 - PROTECTIVE PADS USED (ELBOW, KNEES, ETC.) 10 - REFLECTIVE CLOTHING 11 - LIGHTING - PEDESTRIAN / BICYCLE ONLY 99 - OTHER / UNKNOWN	1 - FRONT - LEFT SIDE (MOTORCYCLE DRIVER) 2 - FRONT - MIDDLE 3 - FRONT - RIGHT SIDE 4 - SECOND - LEFT SIDE (MOTORCYCLE PASSENGER) 5 - SECOND - MIDDLE 6 - SECOND - RIGHT SIDE 7 - THIRD - LEFT SIDE (MOTORCYCLE SIDE CAR) 8 - THIRD - MIDDLE 9 - THIRD - RIGHT SIDE 10 - SLEEPER SECTION OF TRUCK CAB 11 - PASSENGER IN OTHER ENCLOSED CARGO AREA (NON-TRAILING UNIT, BUS, PICK-UP WITH CAP) 12 - PASSENGER IN UNENCLOSED CARGO AREA 13 - TRAILING UNIT 14 - RIDING ON VEHICLE EXTERIOR (NON-TRAILING UNIT) 15 - NON-MOTORIST 99 - OTHER / UNKNOWN	1 - NOT DEPLOYED 2 - DEPLOYED FRONT 3 - DEPLOYED SIDE 4 - DEPLOYED BOTH FRONT/SIDE 5 - NOT APPLICABLE 9 - DEPLOYMENT UNKNOWN
INJURED TAKEN BY		EJECTION	
1 - NOT TRANSPORTED / TREATED AT SCENE 2 - EMS 3 - POLICE 9 - OTHER / UNKNOWN		1 - NOT EJECTED 2 - PARTIALLY EJECTED 3 - TOTALLY EJECTED 4 - NOT APPLICABLE	
		TRAPPED	
		1 - NOT TRAPPED 2 - EXTRICATED BY MECHANICAL MEANS 3 - FREED BY NON-MECHANICAL MEANS	

WITNESS	NAME: LAST, FIRST, MIDDLE	DATE OF BIRTH	AGE	GENDER
	ADDRESS: STREET, CITY, STATE, ZIP		CONTACT PHONE - INCLUDE AREA CODE	

WITNESS	NAME: LAST, FIRST, MIDDLE	DATE OF BIRTH	AGE	GENDER
	ADDRESS: STREET, CITY, STATE, ZIP		CONTACT PHONE - INCLUDE AREA CODE	

WITNESS	NAME: LAST, FIRST, MIDDLE	DATE OF BIRTH	AGE	GENDER
	ADDRESS: STREET, CITY, STATE, ZIP		CONTACT PHONE - INCLUDE AREA CODE	