

TRAFFIC CRASH REPORT

*DENOTES MANDATORY FIELD FOR SUPPLEMENT REPORT

LOCAL REPORT NUMBER*

<input checked="" type="checkbox"/> PHOTOS TAKEN <input type="checkbox"/> SECONDARY CRASH <input type="checkbox"/> PRIVATE PROPERTY		<input type="checkbox"/> OH-2 <input type="checkbox"/> OH-1P <input type="checkbox"/> OTHER		<input checked="" type="checkbox"/> OH-3		LOCAL INFORMATION REPORTING AGENCY NAME* CLEARCREEK TWP PD		NCIC* 0 8 3 1 6		L P 1 9 0 8 2 1 0 0 4 1 9 5			
COUNTY* 8 3		LOCALITY* 1 - CITY 2 - VILLAGE 3 - TOWNSHIP 3		LOCATION: CITY, VILLAGE, TOWNSHIP* CLEARCREEK		CRASH DATE / TIME* 0 8 2 1 2 0 1 9 2 0 1 1		CRASH SEVERITY 1 - FATAL 2 - SERIOUS INJURY SUSPECTED 3 - MINOR INJURY SUSPECTED 4 - INJURY POSSIBLE 5 - PROPERTY DAMAGE ONLY 5					
ROUTE TYPE <input type="checkbox"/> LOCATION		ROUTE NUMBER <input type="checkbox"/> LOCATION		PREFIX 1 - NORTH 2 - SOUTH 3 - EAST 4 - WEST <input type="checkbox"/> LOCATION		LOCATION ROAD NAME WEISENBERGER		ROAD TYPE R D		LATITUDE DECIMAL DEGREES 3 9 . 4 9 4 2 4 1			
ROUTE TYPE <input type="checkbox"/> REFERENCE		ROUTE NUMBER <input type="checkbox"/> REFERENCE		PREFIX 1 - NORTH 2 - SOUTH 3 - EAST 4 - WEST <input type="checkbox"/> REFERENCE		REFERENCE ROAD NAME (ROAD, MILEPOST, HOUSE #) 4151		ROAD TYPE <input type="checkbox"/> REFERENCE		LONGITUDE DECIMAL DEGREES - 8 4 . 1 8 6 8 5 7			

REFERENCE POINT 1 - INTERSECTION 2 - MILE POST 3 - HOUSE # 3		DIRECTION FROM REFERENCE 1 - NORTH 2 - SOUTH 3 - EAST 4 - WEST 2		ROUTE TYPE IR - INTERSTATE ROUTE(TP) US - FEDERAL US ROUTE SR - STATE ROUTE CR - NUMBERED COUNTY ROUTE TR - NUMBERED TOWNSHIP ROUTE		ROAD TYPE AL - ALLEY AV - AVENUE BL - BOULEVARD CR - CIRCLE CT - COURT DR - DRIVE HE - HEIGHTS HW - HIGHWAY LA - LANE MP - MILEPOST OV - OVAL PI - PIKE PL - PLACE RD - ROAD SQ - SQUARE ST - STREET TE - TERRACE TL - TRAIL WA - WAY		INTERSECTION RELATED <input type="checkbox"/> WITHIN INTERSECTION OR ON APPROACH <input type="checkbox"/> WITHIN INTERCHANGE AREA NUMBER OF APPROACHES 5			
DISTANCE FROM REFERENCE 0 5 0		DISTANCE UNIT OF MEASURE 1 - MILES 2 - FEET 3 - YARDS 2		ROADWAY <input type="checkbox"/> ROADWAY DIVIDED							

LOCATION OF FIRST HARMFUL EVENT 1 - ON ROADWAY 2 - ON SHOULDER 3 - IN MEDIAN 4 - ON ROADSIDE 5 - ON GORE 6 - OUTSIDE TRAFFIC WAY 7 - ON RAMP 8 - OFF RAMP 0 4				MANNER OF CRASH COLLISION/IMPACT 1 - NOT COLLISION BETWEEN TWO MOTOR VEHICLES IN TRANSPORT 2 - REAR-END 3 - HEAD-ON 4 - REAR-TO-REAR 5 - BACKING 6 - ANGLE 7 - SIDESWIPE, SAME DIRECTION 8 - SIDESWIPE, OPPOSITE DIRECTION 9 - OTHER / UNKNOWN 1				DIRECTION OF TRAVEL 1 - NORTH 2 - SOUTH 3 - EAST 4 - WEST <input type="checkbox"/>		MEDIAN TYPE 1 - DIVIDED FLUSH MEDIAN (<4 FEET) 2 - DIVIDED FLUSH MEDIAN (>4 FEET) 3 - DIVIDED, DEPRESSED MEDIAN (ANY TYPE) 4 - DIVIDED, RAISED MEDIAN (ANY TYPE) 9 - OTHER/UNKNOWN <input type="checkbox"/>	
---	--	--	--	---	--	--	--	---	--	---	--

<input type="checkbox"/> WORK ZONE RELATED <input type="checkbox"/> WORKERS PRESENT <input type="checkbox"/> LAW ENFORCEMENT PRESENT <input type="checkbox"/> ACTIVE SCHOOL ZONE		WORK ZONE TYPE 1 - LANE CLOSURE 2 - LANE SHIFT/CROSSOVER 3 - WORK ON SHOULDER OR MEDIAN 4 - INTERMITTENT OR MOVING WORK 5 - OTHER <input type="checkbox"/>		LOCATION OF CRASH IN WORK ZONE 1 - BEFORE THE 1ST WORK ZONE WARNING SIGN 2 - ADVANCE WARNING AREA 3 - TRANSITION AREA 4 - ACTIVITY AREA 5 - TERMINATION AREA <input type="checkbox"/>		CONTOUR 4 1 - STRAIGHT LEVEL 2 - STRAIGHT GRADE 3 - CURVE LEVEL 4 - CURVE GRADE 9 - OTHER/UNKNOWN		CONDITIONS 1 1 - DRY 2 - WET 3 - SNOW 4 - ICE 5 - SAND, MUD, DIRT, OIL, GRAVEL 6 - WATER (STANDING, MOVING) 7 - SLUSH 9 - OTHER/UNKNOWN		SURFACE 2 1 - CONCRETE 2 - BLACKTOP, BITUMINOUS, ASPHALT 3 - BRICK/BLOCK 4 - SLAG, GRAVEL, STONE 5 - DIRT 9 - OTHER/UNKNOWN	
LIGHT CONDITION 1 - DAYLIGHT 2 - DAWN/DUSK 3 - DARK - LIGHTED ROADWAY 4 - DARK - ROADWAY NOT LIGHTED 5 - DARK - UNKNOWN ROADWAY LIGHTING 9 - OTHER / UNKNOWN 2				WEATHER 1 - CLEAR 2 - CLOUDY 3 - FOG, SMOG, SMOKE 4 - RAIN 5 - SLEET, HAIL 6 - SNOW 7 - SEVERE CROSSWINDS 8 - BLOWING SAND, SOIL, DIRT, SNOW 9 - FREEZING RAIN OR FREEZING DRIZZLE 99 - OTHER / UNKNOWN 0 1							

NARRATIVE

UNIT #1 WAS TRAVELING SOUTH BOUND ON WEISENBERGER RD AND WENT OFF THE ROAD RIGHT WHILE NEGOTIATING A CURVE. UNIT #1 THEN STRUCK A NATURAL GAS MARKER AND A UTILITY POLE PRIOR TO COMING TO FINAL REST IN A DITCH.

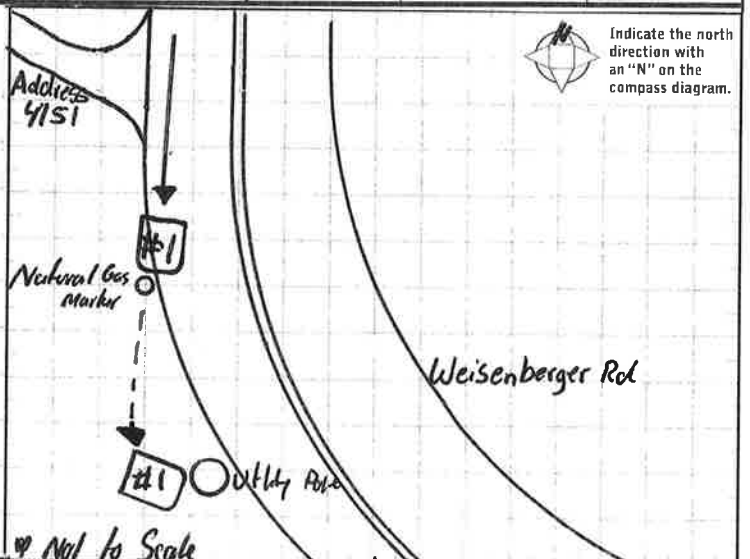

CRASH REPORTED DATE / TIME 0 8 2 1 2 0 1 9 2 0 1 1		DISPATCH DATE / TIME 0 8 2 1 2 0 1 9 2 0 1 1		ARRIVAL DATE / TIME 0 8 2 1 2 0 1 9 2 0 2 1		SCENE CLEARED DATE / TIME 0 8 2 1 2 0 1 9 2 1 2 2		REPORT TAKEN BY <input checked="" type="checkbox"/> POLICE AGENCY <input type="checkbox"/> MOTORIST <input type="checkbox"/> SUPPLEMENT (CORRECTION OR ADDITION TO AN EXISTING REPORT SENT TO DSPS)	
TOTAL TIME ROADWAY CLOSED 0 3 5		OTHER INVESTIGATION TIME 1 0 6		OFFICER'S NAME* DARON WILLIAMS		CHECKED BY OFFICER'S NAME* ERIC DNEY		OFFICER'S BADGE NUMBER* 1 L 3 6	
				CHECKED BY OFFICER'S BADGE NUMBER* 1 L 2 5					

OWNER	UNIT # <u>0 1</u>		OWNER NAME: LAST, FIRST, MIDDLE (☐ SAME AS DRIVER)		OWNER PHONE: INCLUDE AREA CODE (☐ SAME AS DRIVER)		
	OWNER ADDRESS: STREET, CITY, STATE, ZIP (☐ SAME AS DRIVER)						
	COMMERCIAL CARRIER: NAME, ADDRESS, CITY, STATE, ZIP			COMMERCIAL CARRIER PHONE: INCLUDE AREA CODE			
VEHICLE	LP STATE <u>O H</u>	LICENSE PLATE # <u>J609253</u>	VEHICLE IDENTIFICATION # <u>2G2WP552161259546</u>		VEHICLE YEAR <u>2006</u>	VEHICLE MAKE <u>PONT</u>	
	<input checked="" type="checkbox"/> INSURANCE VERIFIED	INSURANCE COMPANY <u>STATE FARM</u>	INSURANCE POLICY # <u>35-2981-517</u>		COLOR <u>RED</u>	VEHICLE MODEL <u>GRNDPRIX</u>	
	<input type="checkbox"/> COMMERCIAL	<input type="checkbox"/> GOVERNMENT	<input type="checkbox"/> IN EMERGENCY RESPONSE	US DOT # _____		TOWED BY: COMPANY NAME <u>SANDYS</u>	
	<input type="checkbox"/> INTERLOCK DEVICE EQUIPPED	<input type="checkbox"/> HIT/SKIP UNIT	#OCCUPANTS <u>0 1</u>	VEHICLE WEIGHT GVWR/GCWR 1 - ≤10K LBS. 2 - 10,001 - 26K LBS. 3 - >26K LBS.		HAZARDOUS MATERIAL <input type="checkbox"/> MATERIAL RELEASED CLASS # _____ <input type="checkbox"/> PLACARD PLACARD ID # _____	
	UNIT TYPE <u>0 1</u>		1 - PASSENGER CAR 7 - MOTORCYCLE 2-WHEELED 12 - GOLF CART 18 - LIMO (LIVERY VEHICLE) 23 - PEDESTRIAN / SKATER 2 - PASSENGER VAN (MINIVAN) 8 - MOTORCYCLE 3-WHEELED 13 - SNOWMOBILE 19 - BUS (16+ PASSENGERS) 24 - WHEELCHAIR (ANY TYPE) 3 - SPORT UTILITY VEHICLE 9 - AUTOCYCLE 14 - SINGLE UNIT TRUCK 20 - OTHER VEHICLE 25 - OTHER NON-MOTORIST 4 - PICK UP 10 - MOPED OR MOTORIZED BICYCLE 15 - SEMI-TRACTOR 21 - HEAVY EQUIPMENT 26 - BICYCLE 5 - CARGO VAN 11 - ALL TERRAIN VEHICLE (ATV / UTV) 16 - FARM EQUIPMENT 22 - ANIMAL WITH RIDER OR ANIMAL-DRAWN VEHICLE 27 - TRAIN 6 - VAN (9-15 SEATS) 17 - MOTORHOME 99 - UNKNOWN OR HIT/SKIP				
	# OF TRAILING UNITS _____		WAS VEHICLE OPERATING IN AUTONOMOUS MODE WHEN CRASH OCCURRED? 1 - YES 2 - NO 9 - OTHER / UNKNOWN AUTONOMOUS MODE LEVEL 0 - NO AUTOMATION 1 - DRIVER ASSISTANCE 2 - PARTIAL AUTOMATION 3 - CONDITIONAL AUTOMATION 4 - HIGH AUTOMATION 5 - FULL AUTOMATION 9 - UNKNOWN				
	SPECIAL FUNCTION <u>0 1</u>		1 - NONE 6 - BUS - CHARTER/TOUR 11 - FIRE 16 - FARM 21 - MAIL CARRIER 2 - TAXI 7 - BUS - INTERCITY 12 - MILITARY 17 - MOWING 99 - OTHER / UNKNOWN 3 - ELECTRONIC RIDE SHARING 8 - BUS - SHUTTLE 13 - POLICE 18 - SNOW REMOVAL 4 - SCHOOL TRANSPORT 9 - BUS - OTHER 14 - PUBLIC UTILITY 19 - TOWING 5 - BUS - TRANSIT/COMMUTER 10 - AMBULANCE 15 - CONSTRUCTION EQUIPMENT 20 - SAFETY SERVICE PATROL				
	CARGO BODY TYPE <u>0 1</u>		1 - NO CARGO BODY TYPE / NOT APPLICABLE 3 - VEHICLE TOWING ANOTHER MOTOR VEHICLE 5 - INTERMODAL CONTAINER CHASSIS 8 - POLE 12 - CONCRETE MIXER 2 - BUS 4 - LOGGING 6 - CARGO VAN/ENCLOSED BOX 9 - CARGO TANK 13 - AUTO TRANSPORTER 7 - GRAVITRIPS/GRAVEL 11 - DUMP 10 - FLAT BED 14 - GARBAGE/REFUSE 99 - OTHER / UNKNOWN				
	VEHICLE DEFECTS _____		1 - TURN SIGNALS 4 - BRAKES 7 - WORN OR SLICK TIRES 9 - MOTOR TROUBLE 99 - OTHER / UNKNOWN 2 - HEAD LAMPS 5 - STEERING 8 - TRAILER EQUIPMENT DEFECTIVE 10 - DISABLED FROM PRIOR ACCIDENT 3 - TAIL LAMPS 6 - TIRE BLOWOUT				
	NON-MOTORIST LOCATION AT IMPACT _____		1 - INTERSECTION - MARKED CROSSWALK 3 - INTERSECTION - OTHER 6 - BICYCLE LANE 9 - MEDIAN/CROSSING ISLAND 12 - FIRST RESPONDER AT INCIDENT SCENE 2 - INTERSECTION - UNMARKED CROSSWALK 4 - MIDBLOCK - MARKED CROSSWALK 7 - SHOULDER / ROADSIDE 10 - DRIVEWAY ACCESS 99 - OTHER / UNKNOWN 5 - TRAVEL LANE - OTHER LOCATION 8 - SIDEWALK 11 - SHARED USE PATHS OR TRAILS				
EVENT(S)	ACTION <u>3</u>		PRE-CRASH ACTIONS <u>1 3</u>		INITIAL POINT OF CONTACT <u>1 2</u>		
	1 - NON-CONTACT 2 - NON-COLLISION 3 - STRIKING 4 - STRUCK 5 - BOTH STRIKING & STRUCK 9 - OTHER / UNKNOWN 1 - STRAIGHT AHEAD 2 - BACKING 3 - CHANGING LANES 4 - OVERTAKING/PASSING 5 - MAKING RIGHT TURN 6 - MAKING LEFT TURN 12 - DRIVERLESS		7 - MAKING U-TURN 8 - ENTERING TRAFFIC LANE 9 - LEAVING TRAFFIC LANE 10 - PARKED 11 - SLOWING OR STOPPED IN TRAFFIC 12 - DRIVERLESS 13 - NEGOTIATING A CURVE 14 - ENTERING OR CROSSING SPECIFIED LOCATION 15 - WALKING, RUNNING, JOGGING, PLAYING 16 - WORKING 17 - PUSHING VEHICLE 99 - OTHER / UNKNOWN		0 - NO DAMAGE 14 - UNDERCARRIAGE 1-12 - REFER TO UNIT DIAGRAM 15 - VEHICLE NOT AT SCENE 99 - UNKNOWN 13 - TOP		
	CONTRIBUTING CIRCUMSTANCES <u>1 1</u>		SEQUENCE OF EVENTS <u>0 8</u>		TRAFFICWAY FLOW <u>2</u>		
	1 - NONE 2 - FAILURE TO YIELD 3 - RAN RED LIGHT 4 - RAN STOP SIGN 5 - UNSAFE SPEED 6 - IMPROPER TURN 7 - LEFT OF CENTER 8 - FOLLOWING TOO CLOSE / ACDA 9 - IMPROPER LANE CHANGE 10 - IMPROPER PASSING 11 - DROVE OFF ROAD 12 - IMPROPER BACKING 13 - IMPROPER START FROM A PARKED POSITION 14 - STOPPED OR PARKED ILLEGALLY 15 - SWERVING TO AVOID 16 - WRONG WAY 17 - VISION OBSTRUCTION 18 - OPERATING DEFECTIVE EQUIPMENT 19 - LOAD SHIFTING/FALLING/SPILLING 20 - IMPROPER CROSSING 21 - LYING IN ROADWAY 22 - NOT DISCERNIBLE 23 - OPENING DOOR INTO ROADWAY 99 - OTHER IMPROPER ACTION		1 - OVERTURN/ROLLOVER 2 - FIRE/EXPLOSION 3 - IMMERSION 4 - JACKKNIFE 5 - CARGO / EQUIPMENT LOSS OR SHIFT 6 - EQUIPMENT FAILURE 7 - SEPARATION OF UNITS 8 - RAN OFF ROAD RIGHT 9 - RAN OFF ROAD LEFT 10 - CROSS MEDIAN 11 - CROSS CENTERLINE - OPPOSITE DIRECTION OF TRAVEL 12 - DOWNHILL RUNAWAY 13 - OTHER NON-COLLISION 14 - PEDESTRIAN 15 - PEDALCYCLE 16 - RAILWAY VEHICLE 17 - ANIMAL - FARM 18 - ANIMAL - DEER 19 - ANIMAL - OTHER 20 - MOTOR VEHICLE IN TRANSPORT 21 - PARKED MOTOR VEHICLE 22 - WORK ZONE MAINTENANCE EQUIPMENT 23 - STRUCK BY FALLING, SHIFTING CARGO OR ANYTHING SET IN MOTION BY A MOTOR VEHICLE 24 - OTHER MOVABLE OBJECT		1 - ONE-WAY 2 - TWO-WAY # OF THROUGH LANES ON ROAD <u>2</u>		
FIRST HARMFUL EVENT <u>2</u>		MOST HARMFUL EVENT <u>3</u>		TRAFFIC CONTROL <u>6</u>			
25 - IMPACT ATTENUATOR / CRASH CUSHION 26 - BRIDGE OVERHEAD STRUCTURE 27 - BRIDGE PIER OR ABUTMENT 28 - BRIDGE PARAPET 29 - BRIDGE RAIL 30 - GUARDRAIL FACE 31 - GUARDRAIL END 32 - PORTABLE BARRIER 33 - MEDIAN CABLE BARRIER 34 - MEDIAN GUARDRAIL BARRIER 35 - MEDIAN CONCRETE BARRIER 36 - MEDIAN OTHER BARRIER 37 - TRAFFIC SIGN POST 38 - OVERHEAD SIGN POST 39 - LIGHT / LUMINARIES SUPPORT 40 - UTILITY POLE 41 - OTHER POST, POLE OR SUPPORT 42 - CULVERT 43 - CURB 44 - DITCH 45 - EMBANKMENT 46 - FENCE 47 - MAILBOX 48 - TREE 49 - FIRE HYDRANT 50 - WORK ZONE MAINTENANCE EQUIPMENT 51 - WALL 52 - BUILDING 53 - TUNNEL 54 - OTHER FIXED OBJECT 99 - OTHER / UNKNOWN		1 - NOT INVOLVED 2 - INVOLVED-ACTIVE CROSSING 3 - INVOLVED-PASSIVE CROSSING UNIT / NON-MOTORIST DIRECTION FROM <u>1</u> TO <u>2</u> 1 - NORTH 5 - NORTHEAST 2 - SOUTH 6 - NORTHWEST 3 - EAST 7 - SOUTHEAST 4 - WEST 8 - SOUTHWEST 9 - OTHER / UNKNOWN		UNIT SPEED <u>0 2 5</u> POSTED SPEED <u>5 5</u> DETECTED SPEED <u>1</u> 1 - STATED / ESTIMATED SPEED 2 - CALCULATED / EDR 3 - UNDETERMINED			

DAMAGE

DAMAGE SCALE

3 1 - NONE 3 - FUNCTIONAL DAMAGE
 2 - MINOR DAMAGE 4 - DISABLING DAMAGE
 9 - UNKNOWN

DAMAGED AREA(S)
 INDICATE ALL THAT APPLY

NO DAMAGE (0) UNDERCARRIAGE (14)
 TOP (13) ALL AREAS (15)
 UNIT NOT AT SCENE (16)

TRAFFIC

TRAFFICWAY FLOW 2

TRAFFIC CONTROL 6

OF THROUGH LANES ON ROAD 2

RAIL GRADE CROSSING

UNIT / NON-MOTORIST DIRECTION
 FROM 1 TO 2

UNIT SPEED 0 2 5

POSTED SPEED 5 5

DETECTED SPEED 1



MOTORIST / Non-MOTORIST

LOCAL REPORT NUMBER

L P 1 9 0 8 2 1 0 0 4 1 9 5

UNIT # 0 1	NAME: LAST, FIRST, MIDDLE JONES, JAIDE KEASIA		DATE OF BIRTH 0 1 / 1 8 / 2 0 0 1		AGE 1 8	GENDER F				
ADDRESS: STREET, CITY, STATE, ZIP 306 PATRIOT CT, LEBANON, OHIO 45036				CONTACT PHONE - INCLUDE AREA CODE 5 1 3 4 9 6 9 7 7 9						
INJURIES 5	INJURED TAKEN BY	EMS AGENCY (NAME)	INJURED TAKEN TO: MEDICAL FACILITY (NAME, CITY)	SAFETY EQUIPMENT USED 0 4	<input type="checkbox"/> DOT-COMPLIANT MC HELMET	SEATING POSITION 0 1	AIR BAG USAGE 1	EJECTION 1	TRAPPED 1	
OL STATE O H	OPERATOR LICENSE NUMBER UP887913		OFFENSE CHARGED 4511.202	LOCAL CODE <input type="checkbox"/>	OFFENSE DESCRIPTION OPERATING W/O CONTROL		CITATION NUMBER 17863			
OL CLASS 4	ENDORSEMENT SELECT UP TO 2	RESTRICTION SELECT UP TO 3	DRIVER DISTRACTED BY 7	ALCOHOL / DRUG SUSPECTED <input type="checkbox"/> ALCOHOL <input type="checkbox"/> MARIJUANA <input type="checkbox"/> OTHER DRUG		CONDITION 1	ALCOHOL TEST STATUS TYPE VALUE		DRUG TEST(S) STATUS TYPE RESULT SELECT UP TO 4	

UNIT #	NAME: LAST, FIRST, MIDDLE		DATE OF BIRTH		AGE	GENDER				
ADDRESS: STREET, CITY, STATE, ZIP				CONTACT PHONE - INCLUDE AREA CODE						
INJURIES	INJURED TAKEN BY	EMS AGENCY (NAME)	INJURED TAKEN TO: MEDICAL FACILITY (NAME, CITY)	SAFETY EQUIPMENT USED	<input type="checkbox"/> DOT-COMPLIANT MC HELMET	SEATING POSITION	AIR BAG USAGE	EJECTION	TRAPPED	
OL STATE	OPERATOR LICENSE NUMBER		OFFENSE CHARGED	LOCAL CODE <input type="checkbox"/>	OFFENSE DESCRIPTION		CITATION NUMBER			
OL CLASS	ENDORSEMENT SELECT UP TO 2	RESTRICTION SELECT UP TO 3	DRIVER DISTRACTED BY	ALCOHOL / DRUG SUSPECTED <input type="checkbox"/> ALCOHOL <input type="checkbox"/> MARIJUANA <input type="checkbox"/> OTHER DRUG		CONDITION	ALCOHOL TEST STATUS TYPE VALUE		DRUG TEST(S) STATUS TYPE RESULT SELECT UP TO 4	

UNIT #	NAME: LAST, FIRST, MIDDLE		DATE OF BIRTH		AGE	GENDER				
ADDRESS: STREET, CITY, STATE, ZIP				CONTACT PHONE - INCLUDE AREA CODE						
INJURIES	INJURED TAKEN BY	EMS AGENCY (NAME)	INJURED TAKEN TO: MEDICAL FACILITY (NAME, CITY)	SAFETY EQUIPMENT USED	<input type="checkbox"/> DOT-COMPLIANT MC HELMET	SEATING POSITION	AIR BAG USAGE	EJECTION	TRAPPED	
OL STATE	OPERATOR LICENSE NUMBER		OFFENSE CHARGED	LOCAL CODE <input type="checkbox"/>	OFFENSE DESCRIPTION		CITATION NUMBER			
OL CLASS	ENDORSEMENT SELECT UP TO 2	RESTRICTION SELECT UP TO 3	DRIVER DISTRACTED BY	ALCOHOL / DRUG SUSPECTED <input type="checkbox"/> ALCOHOL <input type="checkbox"/> MARIJUANA <input type="checkbox"/> OTHER DRUG		CONDITION	ALCOHOL TEST STATUS TYPE VALUE		DRUG TEST(S) STATUS TYPE RESULT SELECT UP TO 4	

INJURIES	SEATING POSITION	AIR BAG	OL CLASS	OL RESTRICTION(S)	DRIVER DISTRACTION	TEST STATUS	
1-FATAL 2-SUSPECTED SERIOUS INJURY 3-SUSPECTED MINOR INJURY 4-POSSIBLE INJURY 5-NO APPARENT INJURY	1-FRONT - LEFT SIDE (MOTORCYCLE DRIVER) 2-FRONT - MIDDLE 3-FRONT - RIGHT SIDE 4-SECOND - LEFT SIDE (MOTORCYCLE PASSENGER) 5-SECOND - MIDDLE 6-SECOND - RIGHT SIDE 7-THIRD - LEFT SIDE (MOTORCYCLE SIDE CAR) 8-THIRD - MIDDLE 9-THIRD - RIGHT SIDE 10-SLEEPER SECTION OF TRUCK CAB 11-PASSENGER IN OTHER ENCLOSED CARGO AREA (NON-TRAILING UNIT, BUS, PICK-UP WITH CAP) 12-PASSENGER IN UNENCLOSED CARGO AREA 13-TRAILING UNIT 14-RIDING ON VEHICLE EXTERIOR (NON-TRAILING UNIT) 15-NON-MOTORIST 99-OTHER / UNKNOWN	1-NOT DEPLOYED 2-DEPLOYED FRONT 3-DEPLOYED SIDE 4-DEPLOYED BOTH FRONT / SIDE 5-NOT APPLICABLE 9-DEPLOYMENT UNKNOWN	1-CLASS A 2-CLASS B 3-CLASS C 4-REGULAR CLASS (OHTO = D) 5-M/C MOPED ONLY 6-NO VALID OL	1-ALCOHOL INTERLOCK DEVICE 2-CDL INTRASTATE ONLY 3-CORRECTIVE LENSES 4-FARM WAIVER 5-EXCEPT CLASS A BUS & CLASS B BUS 6-EXCEPT CLASS A & CLASS B BUS 7-EXCEPT TRACTOR-TRAILER 8-INTERMEDIATE LICENSE RESTRICTIONS 9-LEARNER'S PERMIT RESTRICTIONS 10-LIMITED TO DAYLIGHT ONLY 11-LIMITED TO EMPLOYMENT 12-LIMITED - OTHER 13-MECHANICAL DEVICES (SPECIAL BRAKES, HAND CONTROLS, OR OTHER ADAPTIVE DEVICES) 14-MILITARY VEHICLES ONLY 15-MOTOR VEHICLES WITHOUT AIR BRAKES 16-OUTSIDE MIRROR 17-PROSTHETIC AID 18-OTHER	1-NOT DISTRACTED 2-MANUALLY OPERATING AN ELECTRONIC COMMUNICATION DEVICE (TEXTING, TYPING, DIALING) 3-TALKING ON HANDS-FREE COMMUNICATION DEVICE 4-TALKING ON HAND-HELD COMMUNICATION DEVICE 5-OTHER ACTIVITY WITH AN ELECTRONIC DEVICE 6-PASSENGER 7-OTHER DISTRACTION INSIDE THE VEHICLE 8-OTHER DISTRACTION OUTSIDE THE VEHICLE 9-OTHER / UNKNOWN	1-NONE GIVEN 2-TEST REFUSED 3-TEST GIVEN, CONTAMINATED SAMPLE / UNUSABLE 4-TEST GIVEN, RESULTS KNOWN 5-TEST GIVEN, RESULTS UNKNOWN	
INJURED TAKEN BY	1-NOT TRANSPORTED / TREATED AT SCENE 2-EMS 3-POLICE 9-OTHER / UNKNOWN	EJECTION	1-NOT EJECTED 2-PARTIALLY EJECTED 3-TOTALLY EJECTED 4-NOT APPLICABLE	OL ENDORSEMENT	H - HAZMAT M - MOTORCYCLE P - PASSENGER N - TANKER Q - MOTOR SCOOTER R - THREE-WHEEL MOTORCYCLE S - SCHOOL BUS T - DOUBLE & TRIPLE TRAILERS X - TANKER / HAZMAT	ALCOHOL TEST TYPE	1-NONE 2-BLOOD 3-URINE 4-BREATH 5-OTHER
SAFETY EQUIPMENT	1-NONE USED 2-SHOULDER BELT ONLY USED 3-LAP BELT ONLY USED 4-SHOULDER & LAP BELT USED 5-CHILD RESTRAINT SYSTEM - FORWARD FACING 6-CHILD RESTRAINT SYSTEM - REAR FACING 7-BOOSTER SEAT 8-HELMET USED 9-PROTECTIVE PADS USED (ELBOW, KNEES, ETC.) 10-REFLECTIVE CLOTHING 11-LIGHTING - PEDESTRIAN / BICYCLE ONLY 99-OTHER / UNKNOWN	TRAPPED	1-NOT TRAPPED 2-EXTRICATED BY MECHANICAL MEANS 3-FREED BY NON-MECHANICAL MEANS	CONDITION	1-APPARENTLY NORMAL 2-PHYSICAL IMPAIRMENT 3-EMOTIONAL (E.G., DEPRESSED, ANGRY, DISTURBED) 4-ILLNESS 5-FELL ASLEEP, FAINTED, FATIGUED, ETC. 6-UNDER THE INFLUENCE OF MEDICATIONS / DRUGS / ALCOHOL 9-OTHER / UNKNOWN	DRUG TEST TYPE	1-NONE 2-BLOOD 3-URINE 4-OTHER
						DRUG TEST RESULT(S)	1-AMPHETAMINES 2-BARBITURATES 3-BENZODIAZEPINES 4-CANNABINOIDS 5-COCAINE 6-OPIATES / OPIOIDS 7-OTHER 8-NEGATIVE RESULTS