



TRAFFIC CRASH REPORT

LOCAL REPORT NUMBER *	CRASH SEVERITY	HIT/SKIP
L P 1 7 0 9 0 9 0 0 4 2 4 4	2 1 - FATAL 2 - INJURY 3 - PDO	<input type="checkbox"/> 1 - SOLVED <input type="checkbox"/> 2 - UNSOLVED

PHOTOS TAKEN <input checked="" type="checkbox"/> OH-2 <input type="checkbox"/> OH-1P <input checked="" type="checkbox"/> OH-3 <input type="checkbox"/> OTHER	PDO UNDER STATE REPORTABLE DOLLAR AMOUNT	PRIVATE PROPERTY	REPORTING AGENCY NCIG * 0 8 3 1 6	REPORTING AGENCY NAME * Clearcreek Twp. Police Department	NUMBER OF UNITS 0 2	UNIT IN ERROR 0 1 98 - ANIMAL 99 - UNKNOWN
--	--	------------------	--------------------------------------	--	------------------------	---

COUNTY * 8 3	CITY * <input type="checkbox"/> VILLAGE * <input checked="" type="checkbox"/> TOWNSHIP * Clearcreek	CITY, VILLAGE, TOWNSHIP *	CRASH DATE * 0 9 0 9 2 0 1 7	TIME OF CRASH 1 4 5 1	DAY OF WEEK S A T
-----------------	--	---------------------------	---------------------------------	--------------------------	----------------------

DEGREES / MINUTES / SECONDS LATITUDE 0 / 0 //	LONGITUDE 0 / 0 //	OR	DECIMAL DEGREES LATITUDE 3 9 . 2 2 2 4 9 4	LONGITUDE - 8 4 . 0 9 9 2 1 7
---	-----------------------	----	--	----------------------------------

ROADWAY DIVISION <input type="checkbox"/> DIVIDED <input checked="" type="checkbox"/> UNDIVIDED	DIVIDED LANE DIRECTION OF TRAVEL <input type="checkbox"/> N - NORTHBOUND <input type="checkbox"/> S - SOUTHBOUND <input type="checkbox"/> E - EASTBOUND <input type="checkbox"/> W - WESTBOUND	NUMBER OF THRU LANES 0 2	ROAD TYPES OR MILEPOST * AL - ALLEY CR - CIRCLE HE - HEIGHTS MP - MILEPOST PL - PLACE ST - STREET VA - WAY AV - AVENUE CT - COURT HW - HIGHWAY PK - PARKWAY RD - ROAD TE - TERRACE BL - BOULEVARD DR - DRIVE LA - LANE P1 - PIKE SQ - SQUARE TL - TRAIL
---	--	-----------------------------	--

LOCATION ROUTE TYPE 1 SR 4 8	LOG PREFIX <input type="checkbox"/> N, S <input type="checkbox"/> E, W	LOCATION ROAD NAME	LOCATION ROAD TYPE 2	ROUTE TYPES 1 IR - INTERSTATE ROUTE (INC. TURNPIKE) US - US ROUTE SR - STATE ROUTE	CR - NUMBERED COUNTY ROUTE TR - NUMBERED TOWNSHIP ROUTE
---------------------------------	--	--------------------	----------------------	---	--

DISTANCE FROM REFERENCE <input type="checkbox"/> MILES <input type="checkbox"/> FEET <input type="checkbox"/> YARDS	DIR FROM REF <input type="checkbox"/> N, S <input type="checkbox"/> E, W	REFERENCE ROUTE TYPE 1	REFERENCE ROUTE NUMBER	REF PREFIX <input type="checkbox"/> N, S <input type="checkbox"/> E, W	REFERENCE NAME (ROAD, MILEPOST, HOUSE #) 8051	REFERENCE ROAD TYPE 2
--	--	------------------------	------------------------	--	--	-----------------------

REFERENCE POINT USED 3 1 - INTERSECTION 2 - MILE POST 3 - HOUSE NUMBER	CRASH LOCATION 0 1 01 - NOT AN INTERSECTION 02 - FOUR-WAY INTERSECTION 03 - T-INTERSECTION 04 - Y-INTERSECTION 05 - TRAFFIC CIRCLE/ROUNDBOUT	06 - FIVE-POINT, OR MORE 07 - ON RAMP 08 - OFF RAMP 09 - CROSSOVER 10 - DRIVEWAY/ALLEY ACCESS	11 - RAILWAY GRADE CROSSING 12 - SHARED USE PATHS OR TRAILS 99 - UNKNOWN	<input type="checkbox"/> INTERSECTION RELATED	LOCATION OF FIRST HARMFUL EVENT 1 - ON ROADWAY 2 - ON SHOULDER 3 - IN MEDIAN 4 - ON ROADSIDE 5 - ON GORE 6 - OUTSIDE TRAFFICWAY 9 - UNKNOWN
--	--	---	--	---	--

ROAD CONTOUR 1 - STRAIGHT LEVEL 2 - STRAIGHT GRADE 3 - CURVE LEVEL 4 - CURVE GRADE 9 - UNKNOWN	ROAD CONDITIONS PRIMARY 0 1 SECONDARY	01 - DRY 02 - WET 03 - SNOW 04 - ICE 05 - SAND, MUD, DIRT, OIL, GRAVEL 06 - WATER (STANDING, MOVING) 07 - SLUSH 08 - DEBRIS* 09 - RUT, HOLES, BUMPS, UNEVEN PAVEMENT* 10 - OTHER 99 - UNKNOWN	* SECONDARY CONDITION ONLY
---	---	---	----------------------------

MANNER OF CRASH COLLISION/IMPACT 2 1 - NOT COLLISION BETWEEN TWO MOTOR VEHICLES IN TRANSPORT 2 - REAR-END 3 - HEAD-ON 4 - REAR-TO-REAR 5 - BACKING 6 - ANGLE 7 - SIDESWIPE, SAME DIRECTION 8 - SIDESWIPE, OPPOSITE DIRECTION 9 - UNKNOWN	WEATHER 1 1 - CLEAR 2 - CLOUDY 3 - FOG, SMOG, SMOKE 4 - RAIN 5 - SLEET, HAIL 6 - SNOW 7 - SEVERE CROSSWINDS 8 - BLOWING SAND, SOIL, DIRT, SNOW 9 - OTHER/UNKNOWN
--	--

ROAD SURFACE 2 1 - CONCRETE 2 - BLACKTOP, BITUMINOUS, ASPHALT 3 - BRICK/BLOCK 4 - SLAG, GRAVEL, STONE 5 - DIRT 6 - OTHER	LIGHT CONDITIONS 1 PRIMARY SECONDARY 1 - DAYLIGHT 2 - DAWN 3 - DUSK 4 - DARK - LIGHTED ROADWAY 5 - DARK - ROADWAY NOT LIGHTED 6 - DARK - UNKNOWN ROADWAY LIGHTING 7 - GLARE* 8 - OTHER 9 - UNKNOWN	<input type="checkbox"/> SCHOOL ZONE RELATED <input type="checkbox"/> YES, SCHOOL BUS DIRECTLY INVOLVED <input type="checkbox"/> YES, SCHOOL BUS INDIRECTLY INVOLVED
---	--	--

<input type="checkbox"/> WORK ZONE RELATED <input type="checkbox"/> WORKERS PRESENT <input type="checkbox"/> LAW ENFORCEMENT PRESENT (OFFICER/VEHICLE) <input type="checkbox"/> LAW ENFORCEMENT PRESENT (VEHICLE ONLY)	TYPE OF WORK ZONE <input type="checkbox"/> 1 - LANE CLOSURE 2 - LANE SHIFT/CROSSOVER 3 - WORK ON SHOULDER OR MEDIAN 4 - INTERMITTENT OR MOVING WORK 5 - OTHER	LOCATION OF CRASH IN WORK ZONE <input type="checkbox"/> 1 - BEFORE THE FIRST WORK ZONE WARNING SIGN 2 - ADVANCE WARNING AREA 3 - TRANSITION AREA 4 - ACTIVITY AREA 5 - TERMINATION AREA
---	---	---

NARRATIVE:
 Traffic Unit # 1 and Traffic Unit # 2 were traveling South on N SR 48.
 Traffic Unit # 2 slowed and stopped for traffic near 8051 N SR 48.
 Traffic Unit # 1 failed to stop within assured clear distance ahead and struck traffic Unit # 2.

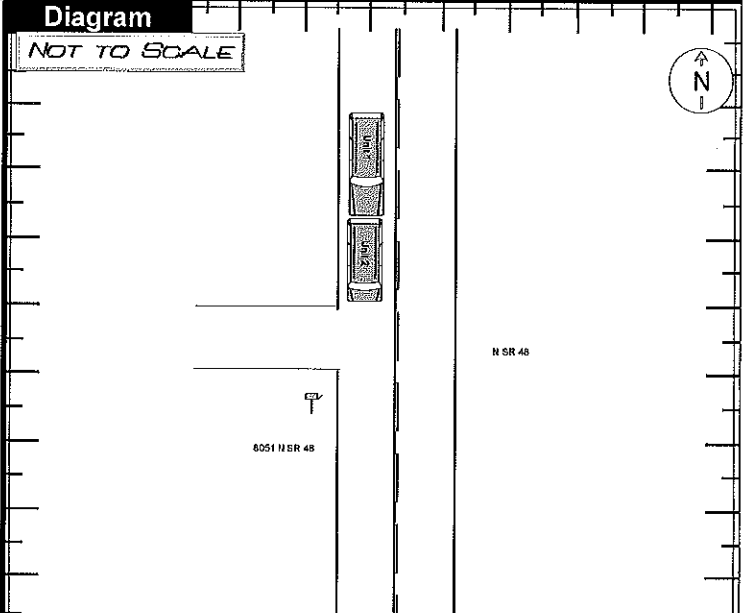

REPORT TAKEN BY <input checked="" type="checkbox"/> POLICE AGENCY <input type="checkbox"/> MOTORIST	<input type="checkbox"/> SUPPLEMENT (CORRECTION OR ADDITION TO AN EXISTING REPORT SENT TO COPS)	DATE CRASH REPORTED 0 9 0 9 2 0 1 7	TIME CRASH REPORTED 1 4 5 1	DISPATCH TIME 1 4 5 4	ARRIVAL TIME 1 5 0 1	TIME CLEARED 1 5 4 3	OTHER INVESTIGATION TIME 3 0	TOTAL MINUTES 0 0 7 2
---	---	--	--------------------------------	--------------------------	-------------------------	-------------------------	---------------------------------	--------------------------

OFFICER'S NAME * Sweet, Charles - LP	OFFICER'S BADGE NUMBER 1 L 3 0	CHECKED BY COH530	Page 1 of 6
---	-----------------------------------	----------------------	-------------



UNIT

LOCAL REPORT NUMBER LP170909004244

UNIT NUMBER 01, OWNER NAME: LAST, FIRST, MIDDLE (X) SAME AS DRIVER Mundluru, Heera, OWNER PHONE NUMBER - INC. AREA CODE (X) SAME AS DRIVER (937)206-4661, DAMAGE SCALE 2, DAMAGED AREA FRONT

OWNER ADDRESS: CITY, STATE, ZIP (X) SAME AS DRIVER 300 W Pier DR, Unit 369D, Sault Sainte Marie, Michigan 49783

LP STATE MI, LICENSE PLATE NUMBER DQD5266, VEHICLE IDENTIFICATION NUMBER 1C4PJMCS2HW582420, # OCCUPANTS 04

VEHICLE YEAR 2017, VEHICLE MAKE JEEP, VEHICLE MODEL Grand Cherokee, VEHICLE COLOR BLK

PROOF OF INSURANCE SHOWN (X), INSURANCE COMPANY Geico, POLICY NUMBER 4475231405, TOWED BY

CARRIER NAME, ADDRESS, CITY, STATE, ZIP, CARRIER PHONE - INCLUDE AREA CODE

US DOT, VEHICLE WEIGHT, CARGO BODY TYPE, TRAFFICWAY DESCRIPTION, HM PLACARD ID No., HM CLASS NUMBER, HAZARDOUS MATERIAL RELEASED

NON-MOTORIST LOCATION PRIOR TO IMPACT, TYPE OF USE, UNIT TYPE, PASSENGER VEHICLES, MED/HEAVY TRUCKS OR COMBO UNITS, BUS/VAN/IMO, ACTION

SPECIAL FUNCTION, MOST DAMAGED AREA, IMPACT AREA, ACTION

PRE-CRASH ACTIONS, MOTORIST, NON-MOTORIST, 99 - UNKNOWN

CONTRIBUTING CIRCUMSTANCES, PRIMARY, SECONDARY, 99 - UNKNOWN, VEHICLE DEFECTS

SEQUENCE OF EVENTS, NON-COLLISION EVENTS, COLLISION WITH PERSON, VEHICLE OR OBJECT NOT FIXED, COLLISION WITH FIXED OBJECT

UNIT SPEED, POSTED SPEED, TRAFFIC CONTROL, UNIT DIRECTION



UNIT

LOCAL REPORT NUMBER

LP170909004244

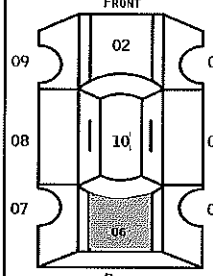
UNIT NUMBER 02	OWNER NAME: LAST, FIRST, MIDDLE (<input checked="" type="checkbox"/> SAME AS DRIVER) Snyder, Lewis W, JR	OWNER PHONE NUMBER - INC. AREA CODE (<input checked="" type="checkbox"/> SAME AS DRIVER) (513)223-5604	DAMAGE SCALE 2	DAMAGED AREA FRONT  REAR
OWNER ADDRESS: CITY, STATE, ZIP (<input checked="" type="checkbox"/> SAME AS DRIVER) 954 E Ridge DR, Unit APT A, Lebanon, Ohio 45036				
LP STATE OH	LICENSE PLATE NUMBER GIG6234	VEHICLE IDENTIFICATION NUMBER 2HKRL1869YH594650	# OCCUPANTS 04	
VEHICLE YEAR 2000	VEHICLE MAKE HOND	VEHICLE MODEL Odyssey	VEHICLE COLOR SIL	
<input checked="" type="checkbox"/> PROOF OF INSURANCE SHOWN	INSURANCE COMPANY State Farm	POLICY NUMBER 1671705D2335M	TOWED BY	
CARRIER NAME, ADDRESS, CITY, STATE, ZIP				CARRIER PHONE- INCLUDE AREA CODE

US DOT	VEHICLE WEIGHT GVWR/GCWR 1 - LESS THAN OR EQUAL TO 10K LBS. 2 - 10,001 TO 20,000 LBS. 3 - MORE THAN 20,000 LBS.	CARGO BODY TYPE 01 - NO CARGO BODY TYPE/NOT APPLICABLE 02 - BUS/VAN (9-15 SEATS, INC DRIVER) 03 - BUS (16+ SEATS, INC DRIVER) 04 - VEHICLE TOWING ANOTHER VEHICLE 05 - LOGGING 06 - INTERMODAL CONTAINER CHASSIS 07 - CARGO VAN/ENCLOSED BOX 08 - GRAIN, CHIPS, GRAVEL	09 - POLE 10 - CARGO TANK 11 - FLAT BED 12 - DUMP 13 - CONCRETE MIXER 14 - AUTO TRANSPORTER 15 - GARBAGE/REFUSE 09 - OTHER/UNKNOWN	TRAFFICWAY DESCRIPTION 1 1 - TWO-WAY, NOT DIVIDED 2 - TWO-WAY, NOT DIVIDED, CONTINUOUS LEFT TURN LANE 3 - TWO-WAY, DIVIDED, UNPROTECTED (PAINTED OR GRASS > 4 FT) MEDIAN 4 - TWO-WAY, DIVIDED, POSITIVE MEDIAN BARRIER 5 - ONE-WAY TRAFFICWAY <input type="checkbox"/> HIT/SKIP UNIT
HM PLACARD ID No.	<input type="checkbox"/> HAZARDOUS MATERIAL RELEASED			
HM CLASS NUMBER				

NON-MOTORIST LOCATION PRIOR TO IMPACT <input type="checkbox"/>	TYPE OF USE 1 1 - PERSONAL 2 - COMMERCIAL 3 - GOVERNMENT <input type="checkbox"/> IN EMERGENCY RESPONSE	UNIT TYPE 05 99 - UNKNOWN or HIT / SKIP	PASSENGER VEHICLES (LESS THAN 9 PASSENGERS) 01 - SUB-COMPACT 02 - COMPACT 03 - MID SIZE 04 - FULL SIZE 05 - MINIVAN 06 - SPORT UTILITY VEHICLE 07 - PICKUP 08 - VAN 09 - MOTORCYCLE 10 - MOTORIZED BICYCLE 11 - SNOWMOBILE/ATV 12 - OTHER PASSENGER VEHICLE	MEDIA HEAVY TRUCKS OR COMBO UNITS > 10K LBS 13 - SINGLE UNIT TRUCK OR VAN 2 AXLE, 6 TIRES 14 - SINGLE UNIT TRUCK; 3+ AXLES 15 - SINGLE UNIT TRUCK/ TRAILER 16 - TRUCK/TRACTOR (BOBTAIL) 17 - TRACTOR/SEMI-TRAILER 18 - TRACTOR/DOUBLE 19 - TRACTOR/TRIPLES 20 - OTHER MEDIA HEAVY VEHICLE	BUS/VAN/LIMO (9 OR MORE INCLUDING DRIVER) 21 - BUS/VAN (9-15 SEATS, INC DRIVER) 22 - BUS (16+ SEATS, INC DRIVER) NON-MOTORIST 23 - ANIMAL WITH RIDER 24 - ANIMAL WITH BUGGY, WAGON, SURREY 25 - BICYCLE/PEDALCYCLIST 26 - PEDESTRIAN/SKATER 27 - OTHER NON-MOTORIST
<input type="checkbox"/> HAS HM PLACARD					

SPECIAL FUNCTION 01	01 - NONE 02 - TAXI 03 - RENTAL TRUCK (OVER 10K LBS) 04 - BUS - SCHOOL (PUBLIC OR PRIVATE) 05 - BUS - TRANSIT 06 - BUS - CHARTER 07 - BUS - SHUTTLE 08 - BUS - OTHER	09 - AMBULANCE 10 - FIRE 11 - HIGHWAY MAINTENANCE 12 - MILITARY 13 - POLICE 14 - PUBLIC UTILITY 15 - OTHER GOVERNMENT 16 - CONSTRUCTION EQUIP	17 - FARM VEHICLE 18 - FARM EQUIPMENT 19 - MOTORHOME 20 - GOLF CART 21 - TRAIN 22 - OTHER (EXPLAIN IN NARRATIVE)	MOST DAMAGED AREA 06	01 - NONE 02 - CENTER FRONT 03 - RIGHT FRONT 04 - RIGHT SIDE 05 - RIGHT REAR 06 - REAR CENTER 07 - LEFT REAR	08 - LEFT SIDE 09 - LEFT FRONT 10 - TOP AND WINDOWS 11 - UNDERCARRIAGE 12 - LOAD/TRAILER 13 - TOTAL (ALL AREAS) 14 - OTHER	ACTION 4 1 - NON-CONTACT 2 - NON-COLLISION 3 - STRIKING 4 - STRUCK 5 - STRIKING/STUCK 9 - UNKNOWN
IMPACT AREA 06							

PRE-CRASH ACTIONS 11	MOTORIST 01 - STRAIGHT AHEAD 02 - BACKING 03 - CHANGING LANES 04 - OVERTAKING/PASSING 05 - MAKING RIGHT TURN 06 - MAKING LEFT TURN 99 - UNKNOWN	07 - MAKING U-TURN 08 - ENTERING TRAFFIC LANE 09 - LEAVING TRAFFIC LANE 10 - PARKED 11 - SLOWING OR STOPPED IN TRAFFIC 12 - DRIVERLESS	13 - NEGOTIATING A CURVE 14 - OTHER MOTORIST ACTION	NON-MOTORIST 15 - ENTERING OR CROSSING SPECIFIED LOCATION 16 - WALKING, RUNNING, JOGGING, PLAYING, CYCLING 17 - WORKING 18 - PUSHING VEHICLE 19 - APPROACHING OR LEAVING VEHICLE 20 - STANDING	21 - OTHER NON-MOTORIST ACTION
--------------------------------	--	---	--	--	--------------------------------

CONTRIBUTING CIRCUMSTANCES	PRIMARY 01	MOTORIST 01 - NONE 02 - FAILURE TO YIELD 03 - RAN RED LIGHT 04 - RAN STOP SIGN 05 - EXCEEDED SPEED LIMIT 06 - UNSAFE SPEED 07 - IMPROPER TURN 08 - LEFT OF CENTER 09 - FOLLOWED TOO CLOSELY/ACDA 10 - IMPROPER LANE CHANGE /PASSING/OFF ROAD	11 - IMPROPER BACKING 12 - IMPROPER START FROM PARKED POSITION 13 - STOPPED OR PARKED ILLEGALLY 14 - OPERATING VEHICLE IN NEGLIGENT MANNER 15 - SWERVING TO AVOID (DUE TO EXTERNAL CONDITIONS) 16 - WRONG SIDE/WRONG WAY 17 - FAILURE TO CONTROL 18 - VISION OBSTRUCTION 19 - OPERATING DEFECTIVE EQUIPMENT 20 - LOAD SHIFTING/FALLING/SPILLING 21 - OTHER IMPROPER ACTION	NON-MOTORIST 22 - NONE 23 - IMPROPER CROSSING 24 - DARTING 25 - LYING AND/OR ILLEGALLY IN ROADWAY 26 - FAILURE TO YIELD RIGHT OF WAY 27 - NOT VISIBLE (DARK CLOTHING) 28 - INATTENTIVE 29 - FAILURE TO OBEY TRAFFIC SIGNS /SIGNALS/OFFICER 30 - WRONG SIDE OF THE ROAD 31 - OTHER NON-MOTORIST ACTION	VEHICLE DEFECTS <input type="checkbox"/>	01 - TURN SIGNALS 02 - HEAD LAMPS 03 - TAIL LAMPS 04 - BRAKES 05 - STEERING 06 - TIRE BLOWOUT 07 - WORN OR SLICK TIRES 08 - TRAILER EQUIPMENT DEFECTIVE 09 - MOTOR TROUBLE 10 - DISABLED FROM PRIOR ACCIDENT 11 - OTHER DEFECTS
----------------------------	----------------------	--	--	---	---	---

SEQUENCE OF EVENTS	1 20	2 <input type="checkbox"/>	3 <input type="checkbox"/>	4 <input type="checkbox"/>	5 <input type="checkbox"/>	6 <input type="checkbox"/>	NON-COLLISION EVENTS 01 - OVERTURN/ROLLOVER 02 - FIRE/EXPLOSION 03 - IMMERSION 04 - JACKKNIFE 05 - CARGO/EQUIPMENT LOSS OR SHIFT	06 - EQUIPMENT FAILURE (BLOWN TIRE, BRAKE FAILURE, ETC) 07 - SEPARATION OF UNITS 08 - RAN OFF ROAD RIGHT 09 - RAN OFF ROAD LEFT	10 - CROSS MEDIAN 11 - CROSS CENTER LINE OPPOSITE DIRECTION OF TRAVEL 12 - DOWNHILL RUNAWAY 13 - OTHER NON-COLLISION	
FIRST HARMFUL EVENT	1	MOST HARMFUL EVENT	1	99 - UNKNOWN						
COLLISION WITH PERSON, VEHICLE OR OBJECT NOT LISTED							COLLISION WITH FIXED OBJECT			
14 - PEDESTRIAN 15 - PEDALCYCLE 16 - RAILWAY VEHICLE (TRAIN, ENGINE) 17 - ANIMAL - FARM 18 - ANIMAL - DEER 19 - ANIMAL - OTHER 20 - MOTOR VEHICLE IN TRANSPORT	21 - PARKED MOTOR VEHICLE 22 - WORK ZONE MAINTENANCE EQUIPMENT 23 - STRUCK BY FALLING, SHIFTING CARGO OR ANYTHING SET IN MOTION BY A MOTOR VEHICLE 24 - OTHER MOVABLE OBJECT	25 - IMPACT ATTENUATOR/CRASH CUSHION 26 - BRIDGE OVERHEAD STRUCTURE 27 - BRIDGE PIER OR ABUTMENT 28 - BRIDGE PARAPET 29 - BRIDGE RAIL 30 - GUARDRAIL FACE 31 - GUARDRAIL END 32 - PORTABLE BARRIER	33 - MEDIAN CABLE BARRIER 34 - MEDIAN GUARDRAIL BARRIER 35 - MEDIAN CONCRETE BARRIER 36 - MEDIAN OTHER BARRIER 37 - TRAFFIC SIGN POST 38 - OVERHEAD SIGN POST 39 - LIGHT/LUMINARIES SUPPORT 40 - UTILITY POLE	41 - OTHER POST, POLE OR SUPPORT 42 - CULVERT 43 - CURB 44 - DITCH 45 - EMBANKMENT 46 - FENCE 47 - MAILBOX	48 - TREE 49 - FIRE HYDRANT 50 - WORK ZONE MAINTENANCE EQUIPMENT 51 - WALL, BUILDING, TUNNEL 52 - OTHER FIXED OBJECT					

UNIT SPEED 0	POSTED SPEED 55	TRAFFIC CONTROL 12 01 - NO CONTROLS 02 - STOP SIGN 03 - YIELD SIGN 04 - TRAFFIC SIGNAL 05 - TRAFFIC FLASHERS 06 - SCHOOL ZONE	07 - RAILROAD CROSSBUCKS 08 - RAILROAD FLASHERS 09 - RAILROAD GATES 10 - CONSTRUCTION BARRICADE 11 - PERSON (FLAGGER, OFFICER) 12 - PAVEMENT MARKINGS	13 - CROSSWALK LINES 14 - WALK/DON'T WALK 15 - OTHER 16 - NOT REPORTED	UNIT DIRECTION FROM 1 TO 2 1 - NORTH 2 - SOUTH 3 - EAST 4 - WEST	5 - NORTHEAST 6 - NORTHWEST 7 - SOUTHEAST 8 - SOUTHWEST	9 - UNKNOWN
<input checked="" type="checkbox"/> STATED <input type="checkbox"/> ESTIMATED							



MOTORIST / NON-MOTORIST / OCCUPANT

LOCAL REPORT NUMBER
L P 1 7 0 9 0 9 0 0 4 2 4 4

UNIT NUMBER 01	NAME: LAST, FIRST, MIDDLE Mundluru, Heera	DATE OF BIRTH 11241991	AGE 25	GENDER F F - FEMALE M - MALE
--------------------------	---	----------------------------------	------------------	---

ADDRESS, CITY, STATE, ZIP 300 W Pier DR, Unit 369D, Sault Sainte Marie, Michigan 49783	CONTACT PHONE - INCLUDE AREA CODE (937)206-4661
--	---

INJURIES 1	INJURED TAKEN BY	EMS AGENCY	MEDICAL FACILITY INJURED TAKEN TO	SAFETY EQUIPMENT USED 04	<input type="checkbox"/> DOT COMPLIANT MOTORCYCLE HELMET	SEATING POSITION 01	AIR BAG USAGE 1	EJECTION 1	TRAPPED 1		
OL STATE M I	OPERATOR LICENSE NUMBER M534302005898	OL CLASS 4	<input type="checkbox"/> NO VALID OL	<input type="checkbox"/> M/C END.	CONDITION 1	ALCOHOL/DRUG SUSPECTED 1	ALCOHOL TEST STATUS 1	ALCOHOL TEST TYPE 1	ALCOHOL TEST VALUE -	DRUG TEST STATUS 1	DRUG TEST TYPE 1

OFFENSE CHARGED (<input type="checkbox"/> LOCAL CODE) 4511.21A	OFFENSE DESCRIPTION Assured Clear Distance	CITATION NUMBER 016687	<input type="checkbox"/> HANDS-FREE DEVICE USED	DRIVER DISTRACTED BY 1
--	--	----------------------------------	---	----------------------------------

UNIT NUMBER 02	NAME: LAST, FIRST, MIDDLE Snyder, Lewis W	DATE OF BIRTH 12131960	AGE 56	GENDER M F - FEMALE M - MALE
--------------------------	---	----------------------------------	------------------	---

ADDRESS, CITY, STATE, ZIP 954 E Ridge DR, Unit APT A, Lebanon, Ohio 45036	CONTACT PHONE - INCLUDE AREA CODE (513)223-5604
---	---

INJURIES 2	INJURED TAKEN BY 1	EMS AGENCY	MEDICAL FACILITY INJURED TAKEN TO	SAFETY EQUIPMENT USED 04	<input type="checkbox"/> DOT COMPLIANT MOTORCYCLE HELMET	SEATING POSITION 01	AIR BAG USAGE 1	EJECTION 1	TRAPPED 1		
OL STATE O H	OPERATOR LICENSE NUMBER SY240445	OL CLASS 4	<input type="checkbox"/> NO VALID OL	<input type="checkbox"/> M/C END.	CONDITION 1	ALCOHOL/DRUG SUSPECTED 1	ALCOHOL TEST STATUS 1	ALCOHOL TEST TYPE 1	ALCOHOL TEST VALUE -	DRUG TEST STATUS 1	DRUG TEST TYPE 1

OFFENSE CHARGED (<input type="checkbox"/> LOCAL CODE)	OFFENSE DESCRIPTION	CITATION NUMBER	<input type="checkbox"/> HANDS-FREE DEVICE USED	DRIVER DISTRACTED BY 1
---	---------------------	-----------------	---	----------------------------------

INJURIES 1 - NO INJURY / NONE REPORTED 2 - POSSIBLE 3 - NON-INCAPACITATING 4 - INCAPACITATING 5 - FATAL	INJURED TAKEN BY 1 - NOT TRANSPORTED / TREATED AT SCENE 2 - EMS 3 - POLICE 4 - OTHER 9 - UNKNOWN	SAFETY EQUIPMENT USED MOTORIST 01 - NONE USED - VEHICLE OCCUPANT 02 - SHOULDER BELT ONLY USED 03 - LAP BELT ONLY USED 04 - SHOULDER AND LAP BELT USED	99 - UNKNOWN SAFETY EQUIPMENT 05 - CHILD RESTRAINT SYSTEM - FORWARD FACING 06 - CHILD RESTRAINT SYSTEM - REAR FACING 07 - BOOSTER SEAT 08 - HELMET USED	NON-MOTORIST 09 - NONE USED 10 - HELMET USED 11 - PROTECTIVE PADS USED (ELBOWS, KNEES, ETC)	12 - REFLECTIVE CLOTHING 13 - LIGHTING 14 - OTHER
--	---	--	---	--	---

SEATING POSITION 01 - FRONT - LEFT SIDE (MOTORCYCLE DRIVER) 02 - FRONT - MIDDLE 03 - FRONT - RIGHT SIDE 04 - SECOND - LEFT SIDE (MOTORCYCLE PASSENGER) 05 - SECOND - MIDDLE 06 - SECOND - RIGHT SIDE	07 - THIRD - LEFT SIDE (MOTORCYCLE SIDE CAR) 08 - THIRD MIDDLE 09 - THIRD - RIGHT SIDE 10 - SLEEPER SECTION OF CAB (TRUCK) 11 - PASSENGER IN OTHER ENCLOSED CARGO AREA (NON-TRAILING UNIT SUCH AS A BUS, PICK-UP WITH CAP)	12 - PASSENGER IN UNENCLOSED CARGO AREA 13 - TRAILING UNIT 14 - RIDING ON VEHICLE EXTERIOR (NON-TRAILING UNIT) 15 - NON-MOTORIST 16 - OTHER 99 - UNKNOWN	AIR BAG USAGE 1 - NOT DEPLOYED 2 - DEPLOYED FRONT 3 - DEPLOYED SIDE 4 - DEPLOYED BOTH FRONT/SIDE 5 - NOT APPLICABLE 9 - DEPLOYMENT UNKNOWN
--	--	---	--

EJECTION 1 - NOT EJECTED 2 - TOTALLY EJECTED 3 - PARTIALLY EJECTED 4 - NOT APPLICABLE	TRAPPED 1 - NOT TRAPPED 2 - EXTRICATED BY MECHANICAL MEANS 3 - EXTRICATED BY NON-MECHANICAL MEANS	OPERATOR LICENSE CLASS 1 - CLASS A 2 - CLASS B 3 - CLASS C 4 - REGULAR CLASS (OHIO IS 'D') 5 - MCMOPED ONLY	CONDITION 1 - APPARENTLY NORMAL 2 - PHYSICAL IMPAIRMENT 3 - EMOTIONAL (DEPRESSED, ANGRY, DISTURBED) 4 - ILLNESS 5 - FELL ASLEEP, FAINTED, FATIGUED 6 - UNDER THE INFLUENCE OF MEDICATIONS, DRUGS, ALCOHOL 7 - OTHER	ALCOHOL/DRUG SUSPECTED 1 - NONE 2 - YES - ALCOHOL SUSPECTED 3 - YES - HBD NOT IMPAIRED 4 - YES - DRUGS SUSPECTED 5 - YES - ALCOHOL AND DRUGS SUSPECTED
---	--	--	--	---

ALCOHOL TEST STATUS 1 - NONE GIVEN 2 - TEST REFUSED 3 - TEST GIVEN, CONTAMINATED SAMPLE/UNUSABLE 4 - TEST GIVEN, RESULTS KNOWN 5 - TEST GIVEN, RESULTS UNKNOWN	ALCOHOL TEST TYPE 1 - NONE 2 - BLOOD 3 - URINE 4 - BREATH 5 - OTHER	DRUG TEST STATUS 1 - NONE GIVEN 2 - TEST REFUSED 3 - TEST GIVEN, CONTAMINATED SAMPLE/UNUSABLE 4 - TEST GIVEN, RESULTS KNOWN 5 - TEST GIVEN, RESULTS UNKNOWN	DRUG TEST TYPE 1 - NONE 2 - BLOOD 3 - URINE 4 - OTHER	DRIVER DISTRACTED BY 1 - NO DISTRACTION REPORTED 2 - PHONE 3 - TEXTING/ E-MAILING 4 - ELECTRONIC COMMUNICATION DEVICE 5 - OTHER ELECTRONIC DEVICE (NAVIGATION DEVICE, RADIO, DVD) 6 - OTHER INSIDE THE VEHICLE 7 - EXTERNAL DISTRACTION
---	--	--	---	--

UNIT NUMBER 01	NAME: LAST, FIRST, MIDDLE Rao, Isha	DATE OF BIRTH 02242004	AGE 13	GENDER F F - FEMALE M - MALE
--------------------------	---	----------------------------------	------------------	---

ADDRESS, CITY, STATE, ZIP 890 Southwick CIR, Dayton, Ohio 45459	CONTACT PHONE - INCLUDE AREA CODE (203)627-5234
---	---

INJURIES 1	INJURED TAKEN BY	EMS AGENCY	MEDICAL FACILITY INJURED TAKEN TO	SAFETY EQUIPMENT USED 04	<input type="checkbox"/> DOT COMPLIANT MOTORCYCLE HELMET	SEATING POSITION 03	AIR BAG USAGE 1	EJECTION 1	TRAPPED 1
----------------------	------------------	------------	-----------------------------------	------------------------------------	--	-------------------------------	---------------------------	----------------------	---------------------

UNIT NUMBER 01	NAME: LAST, FIRST, MIDDLE Rao, Arnab	DATE OF BIRTH 04072011	AGE 6	GENDER M F - FEMALE M - MALE
--------------------------	--	----------------------------------	-----------------	---

ADDRESS, CITY, STATE, ZIP 890 Southwick CIR, Dayton, Ohio 45459	CONTACT PHONE - INCLUDE AREA CODE (203)627-5234
---	---

INJURIES 1	INJURED TAKEN BY	EMS AGENCY	MEDICAL FACILITY INJURED TAKEN TO	SAFETY EQUIPMENT USED 04	<input type="checkbox"/> DOT COMPLIANT MOTORCYCLE HELMET	SEATING POSITION 04	AIR BAG USAGE 1	EJECTION 1	TRAPPED 1
----------------------	------------------	------------	-----------------------------------	------------------------------------	--	-------------------------------	---------------------------	----------------------	---------------------



OCCUPANT / WITNESS ADDENDUM

LOCAL REPORT NUMBER

LP170909004244

OCCUPANT

UNIT NUMBER 01	NAME: LAST, FIRST, MIDDLE Umarani, Thummali	DATE OF BIRTH 01211951	AGE 66	GENDER F F - FEMALE M - MALE
--------------------------	---	----------------------------------	------------------	---

ADDRESS, CITY, STATE, ZIP 890 Southwick CIR, Dayton, Ohio 45459	CONTACT PHONE - INCLUDE AREA CODE (203)627-5234
---	---

INJURIES 1	INJURED TAKEN BY <input type="checkbox"/>	EMS AGENCY	MEDICAL FACILITY INJURED TAKEN TO	SAFETY EQUIPMENT USED 04	<input type="checkbox"/> DOT COMPLIANT MOTORCYCLE HELMET	SEATING POSITION 06	AIR BAG USAGE 1	EJECTION 1	TRAPPED 1
----------------------	--	------------	-----------------------------------	------------------------------------	--	-------------------------------	---------------------------	----------------------	---------------------

OCCUPANT

UNIT NUMBER 02	NAME: LAST, FIRST, MIDDLE Snyder, Tessa Rose	DATE OF BIRTH 09061994	AGE 23	GENDER F F - FEMALE M - MALE
--------------------------	--	----------------------------------	------------------	---

ADDRESS, CITY, STATE, ZIP 954 E Ridge DR, Unit APT A, Lebanon, Ohio 45036	CONTACT PHONE - INCLUDE AREA CODE (513)223-5604
---	---

INJURIES 2	INJURED TAKEN BY 1	EMS AGENCY	MEDICAL FACILITY INJURED TAKEN TO	SAFETY EQUIPMENT USED 04	<input type="checkbox"/> DOT COMPLIANT MOTORCYCLE HELMET	SEATING POSITION 03	AIR BAG USAGE 1	EJECTION 1	TRAPPED 1
----------------------	------------------------------	------------	-----------------------------------	------------------------------------	--	-------------------------------	---------------------------	----------------------	---------------------

OCCUPANT

UNIT NUMBER 02	NAME: LAST, FIRST, MIDDLE Snyder, Hannah Joy	DATE OF BIRTH 08041993	AGE 24	GENDER F F - FEMALE M - MALE
--------------------------	--	----------------------------------	------------------	---

ADDRESS, CITY, STATE, ZIP 954 E Ridge DR, Unit APT A, Lebanon, Ohio 45036	CONTACT PHONE - INCLUDE AREA CODE (513)223-5604
---	---

INJURIES 2	INJURED TAKEN BY 1	EMS AGENCY	MEDICAL FACILITY INJURED TAKEN TO	SAFETY EQUIPMENT USED 04	<input type="checkbox"/> DOT COMPLIANT MOTORCYCLE HELMET	SEATING POSITION 04	AIR BAG USAGE 1	EJECTION 1	TRAPPED 1
----------------------	------------------------------	------------	-----------------------------------	------------------------------------	--	-------------------------------	---------------------------	----------------------	---------------------

OCCUPANT

UNIT NUMBER 02	NAME: LAST, FIRST, MIDDLE Snyder, Lillian	DATE OF BIRTH 08242017	AGE 0	GENDER F F - FEMALE M - MALE
--------------------------	---	----------------------------------	-----------------	---

ADDRESS, CITY, STATE, ZIP 954 E Ridge DR, Unit A, Lebanon, Ohio 45036	CONTACT PHONE - INCLUDE AREA CODE (513)223-5604
---	---

INJURIES 1	INJURED TAKEN BY <input type="checkbox"/>	EMS AGENCY	MEDICAL FACILITY INJURED TAKEN TO	SAFETY EQUIPMENT USED 05	<input type="checkbox"/> DOT COMPLIANT MOTORCYCLE HELMET	SEATING POSITION 06	AIR BAG USAGE 1	EJECTION 1	TRAPPED 1
----------------------	--	------------	-----------------------------------	------------------------------------	--	-------------------------------	---------------------------	----------------------	---------------------

OCCUPANT

UNIT NUMBER <input type="checkbox"/>	NAME: LAST, FIRST, MIDDLE	DATE OF BIRTH	AGE	GENDER <input type="checkbox"/> F - FEMALE M - MALE
---	---------------------------	---------------	-----	---

ADDRESS, CITY, STATE, ZIP	CONTACT PHONE - INCLUDE AREA CODE
---------------------------	-----------------------------------

INJURIES <input type="checkbox"/>	INJURED TAKEN BY <input type="checkbox"/>	EMS AGENCY	MEDICAL FACILITY INJURED TAKEN TO	SAFETY EQUIPMENT USED <input type="checkbox"/>	<input type="checkbox"/> DOT COMPLIANT MOTORCYCLE HELMET	SEATING POSITION <input type="checkbox"/>	AIR BAG USAGE <input type="checkbox"/>	EJECTION <input type="checkbox"/>	TRAPPED <input type="checkbox"/>
--------------------------------------	--	------------	-----------------------------------	---	--	--	---	--------------------------------------	-------------------------------------

OCCUPANT

UNIT NUMBER <input type="checkbox"/>	NAME: LAST, FIRST, MIDDLE	DATE OF BIRTH	AGE	GENDER <input type="checkbox"/> F - FEMALE M - MALE
---	---------------------------	---------------	-----	---

ADDRESS, CITY, STATE, ZIP	CONTACT PHONE - INCLUDE AREA CODE
---------------------------	-----------------------------------

INJURIES <input type="checkbox"/>	INJURED TAKEN BY <input type="checkbox"/>	EMS AGENCY	MEDICAL FACILITY INJURED TAKEN TO	SAFETY EQUIPMENT USED <input type="checkbox"/>	<input type="checkbox"/> DOT COMPLIANT MOTORCYCLE HELMET	SEATING POSITION <input type="checkbox"/>	AIR BAG USAGE <input type="checkbox"/>	EJECTION <input type="checkbox"/>	TRAPPED <input type="checkbox"/>
--------------------------------------	--	------------	-----------------------------------	---	--	--	---	--------------------------------------	-------------------------------------

INJURIES 1 - NO INJURY / NONE REPORTED 2 - POSSIBLE 3 - NON-INCAPACITATING 4 - INCAPACITATING 5 - FATAL	INJURED TAKEN BY 1 - NOT TRANSPORTED / TREATED AT SCENE 2 - EMS 3 - POLICE 4 - OTHER 9 - UNKNOWN	SAFETY EQUIPMENT USED MOTORIST 01 - NONE USED - VEHICLE OCCUPANT 02 - SHOULDER BELT ONLY USED 03 - LAP BELT ONLY USED 04 - SHOULDER AND LAP BELT USED 99 - UNKNOWN SAFETY EQUIPMENT	NON-MOTORIST 05 - CHILD RESTRAINT SYSTEM - FORWARD FACING 06 - CHILD RESTRAINT SYSTEM - REAR FACING 07 - BOOSTER SEAT 08 - HELMET USED	NON-MOTORIST 09 - NONE USED 10 - HELMET USED 11 - PROTECTIVE PADS USED (ELBOWS, KNEES, ETC)	12 - REFLECTIVE CLOTHING 13 - LIGHTING 14 - OTHER
---	--	--	---	---	---

SEATING POSITION 01 - FRONT - LEFT SIDE (MOTORCYCLE DRIVER) 02 - FRONT - MIDDLE 03 - FRONT - RIGHT SIDE 04 - SECOND - LEFT SIDE (MOTORCYCLE PASSENGER) 05 - SECOND - MIDDLE 06 - SECOND - RIGHT SIDE 07 - THIRD - LEFT SIDE (MOTORCYCLE SIDE CAR) 08 - THIRD MIDDLE 09 - THIRD - RIGHT SIDE 10 - SLEEPER SECTION OF CAB (TRUCK)	11 - PASSENGER IN OTHER ENCLOSED CARGO AREA (NON-TRAILING UNIT SUCH AS A BUS, PICKUP WITH CAP) 12 - PASSENGER IN UNENCLOSED CARGO AREA 13 - TRAILING UNIT 14 - RIDING ON VEHICLE EXTERIOR (NON-TRAILING UNIT) 15 - NON-MOTORIST 16 - OTHER 99 - UNKNOWN	AIR BAG USAGE 1 - NOT DEPLOYED 2 - DEPLOYED FRONT 3 - DEPLOYED SIDE 4 - DEPLOYED BOTH FRONT/SIDE 5 - NOT APPLICABLE 9 - DEPLOYMENT UNKNOWN	EJECTION 1 - NOT EJECTED 2 - TOTALLY EJECTED 3 - PARTIALLY EJECTED 4 - NOT APPLICABLE	TRAPPED 1 - NOT TRAPPED 2 - EXTRICATED BY MECHANICAL MEANS 3 - EXTRICATED BY NON-MECHANICAL MEANS
--	---	---	--	---

